



Overcliff Road, SE13

£1,200,000

Dexters



Overcliff Road, SE13

A delightful Edwardian family home measuring in excess of 1,899 sq ft favourably positioned moments from Hilly Fields park. There are five bedrooms, three bathrooms and a generous through lounge leading to low maintenance rear garden.

The front door leads into an entrance hall with high ceilings and a spacious reception room to the left which leads to the dining room where you have access to the rear garden. To the back of the property is a utility room, separate welcoming kitchen and downstairs bathroom, a handy cellar completes the ground floor.

The first floor has three double bedrooms, one with a dressing room that can be used as an office and these are served by a family bathroom.

The loft has been converted to create a further two bedrooms and shower room with plenty of eaves space.

Overcliff Road is a lovely residential road located just around the corner from Hilly Fields and between St. John's, Lewisham and Ladywell train stations giving excellent transport links into London and the City.

Features

- Edwardian Terrace House
- Five Bedrooms
- Loft Conversion
- Private Rear Garden
- Original Features
- Excellent Transport Links







Overcliff Road, London, SE13

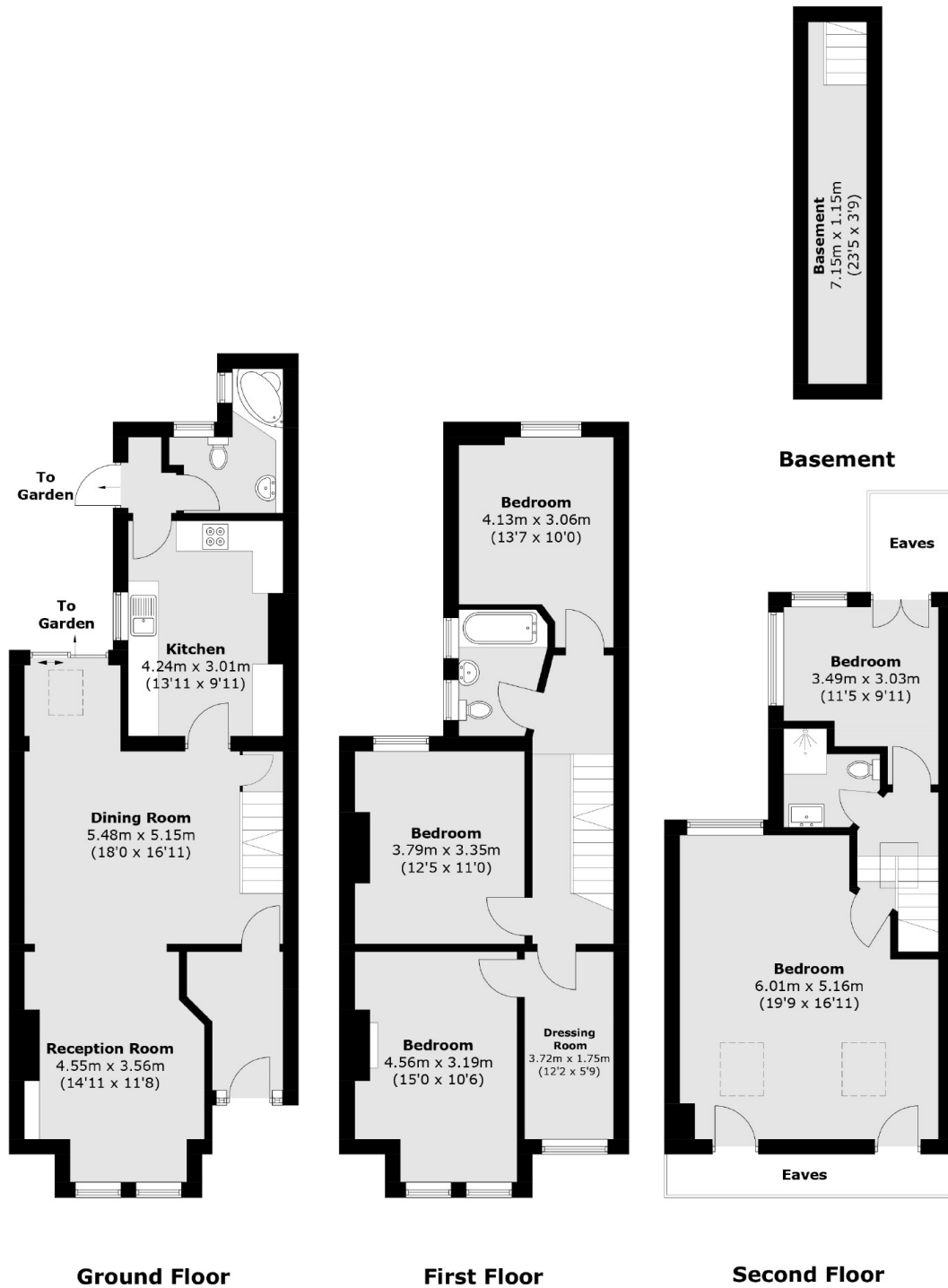

Total area (approx.): 176.5 sq. m (1,899.9 sq. ft)
(Excluding Eaves / Including Basement)