



## Davenport Road, SE6

£425,000

A renovated ground floor period conversion moments from Mountsfield Park. There are two double bedrooms, a substantial private garden, separate kitchen and offered with a freehold share and no onward chain.

Davenport Road is a quiet residential road equidistant from Hither Green, Ladywell and Catford stations with frequent services into London and the City.

### Features

- Two Bedrooms
- Recently Renovated
- Large Garden
- Share Of Freehold
- Off Street Parking
- Chain Free

# Davenport Road, London, SE6

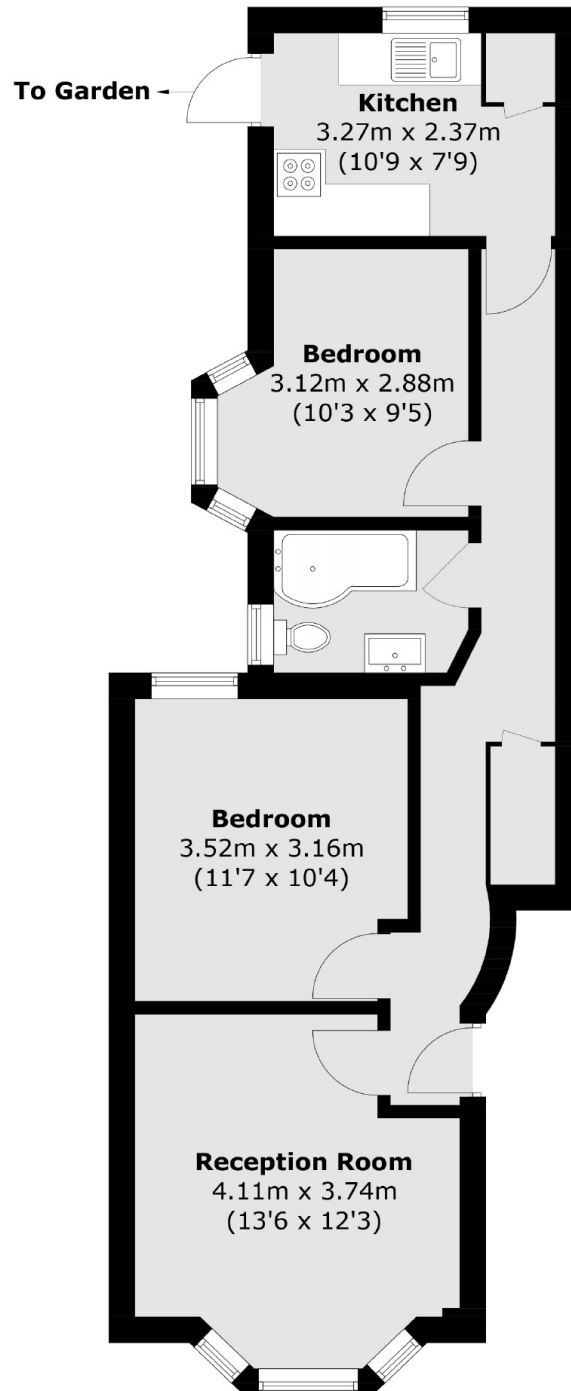

Total area (approx.): 56.9 sq. m (612.4 sq. ft)