



## Avon Road, SE4 £700,000

A well presented two double bedroom, split level period conversion flat with private garden measuring 1076 Sq Ft, located in the popular Brockley Conservation area.

Avon Road is a highly sought after road in the Brockley Conservation area with excellent transport links from Brockley, St. John's and Ladywell train stations.

### Features

Two Double Bedrooms  
Brockley Conservation  
Split Level Flat  
Private Garden  
Well Presented  
1076 Sq Ft

# Avon Road, London, SE4

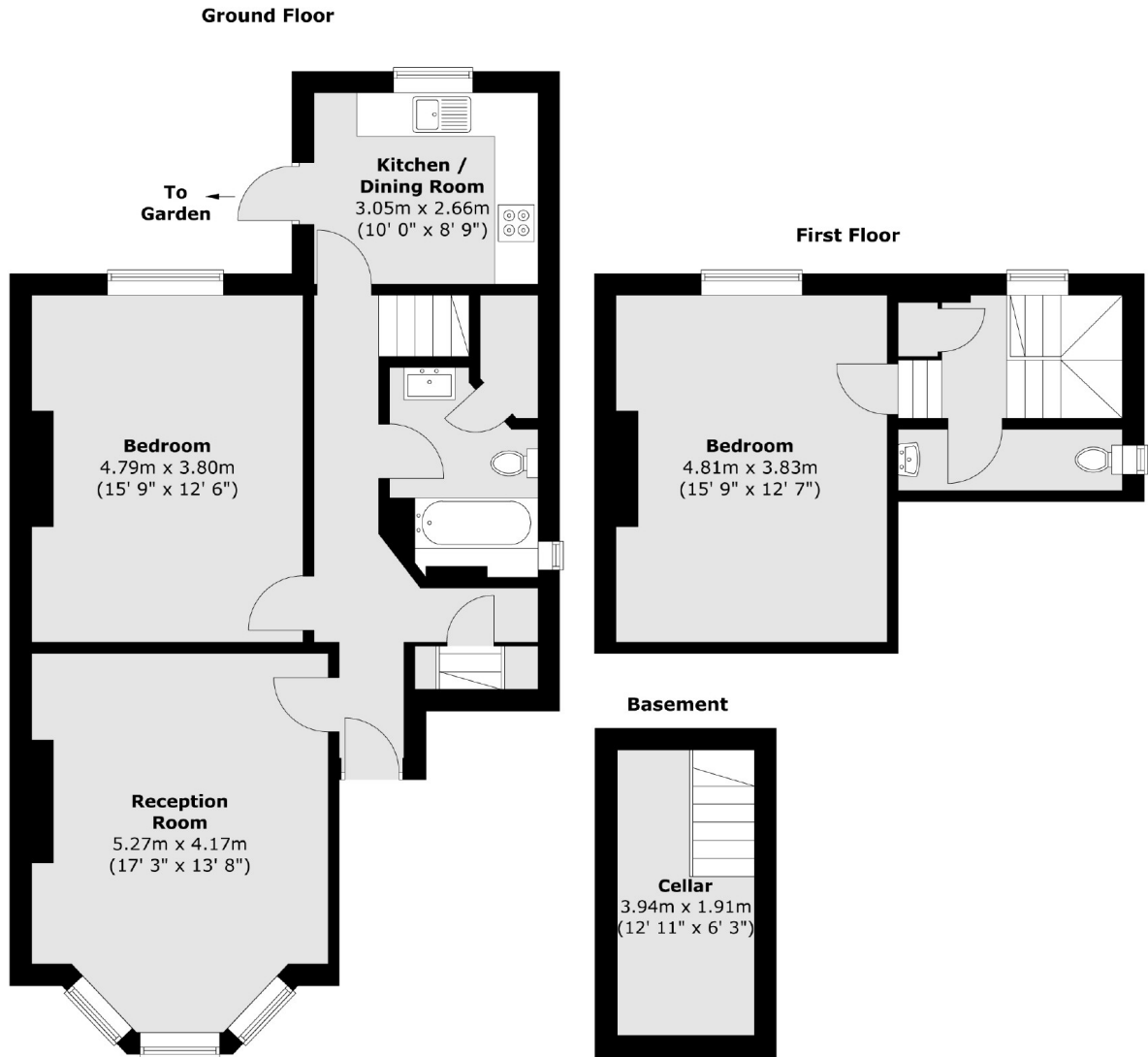

Total area (approx.) : 100 sq. m (1076 sq. ft)