



Lee High Road, SE13

£240,000

A bright and spacious, modern one bedroom purpose built apartment with private balcony. It has an open plan reception/kitchen, large double bedroom and well maintained communal garden.

The Riva Building is well positioned for Lewisham High Street and Blackheath Village. Nearby stations offer superb transport links into the City, Canary Wharf and London Bridge.

Features

- Double Bedroom
- Open Plan Living
- Private Balcony
- Modern Kitchen
- Close To Stations
- Chain Free

Lee High Road, London, SE13

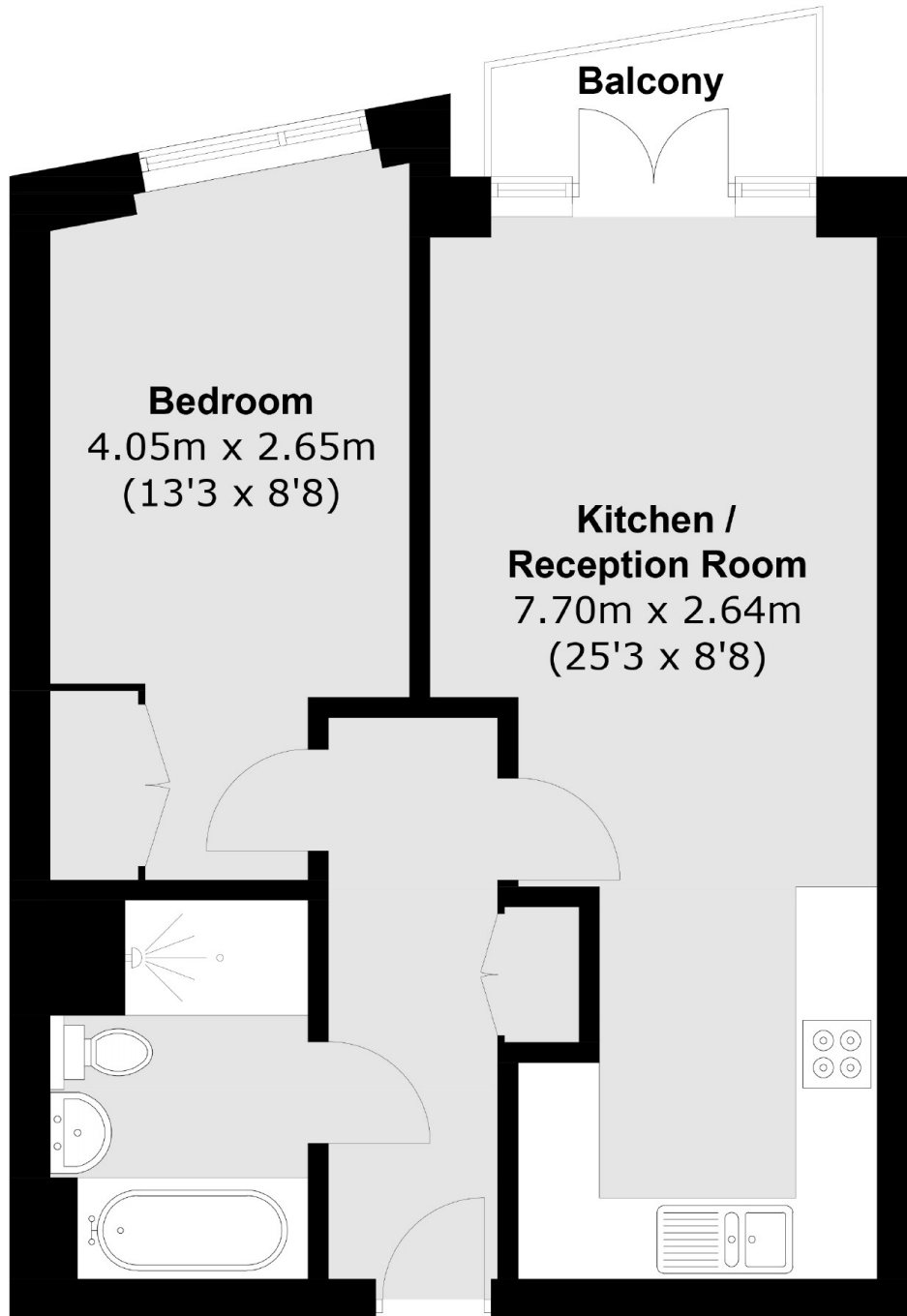

Total area (approx.): 48.5 sq. m (522.0 sq. ft)
Balcony area (approx.): 2.4 sq. m (25.8 sq. ft)

Dexters

Brockley
369 Brockley Road
London
SE4 2AG
Sales
020 8815 2220

Energy Rating: B. We aim to make our particulars both accurate and reliable. However they are not guaranteed; nor do they form part of an offer or contract. If you require clarification on any points then please contact us, especially if you're traveling some distance to view. Please note that appliances and heating systems have not been tested and therefore no warranties can be given as to their good working order.

 **RICS** | Regulated
Estate Agent
and Letting Agent

[dexters.co.uk](https://www.dexters.co.uk)