



Lee High Road, SE13

£275,000

A bright and spacious, modern one bedroom purpose built apartment with private balcony. It has an open plan reception/kitchen, large double bedroom and well maintained communal garden.

The Riva Building is well positioned for Lewisham High Street and Blackheath Village. Nearby stations offer superb transport links into the City, Canary Wharf and London Bridge.

Features

- Double Bedroom
- Open Plan Living
- Private Balcony
- Modern Kitchen
- Close To Stations
- Chain Free

Lee High Road, London, SE13

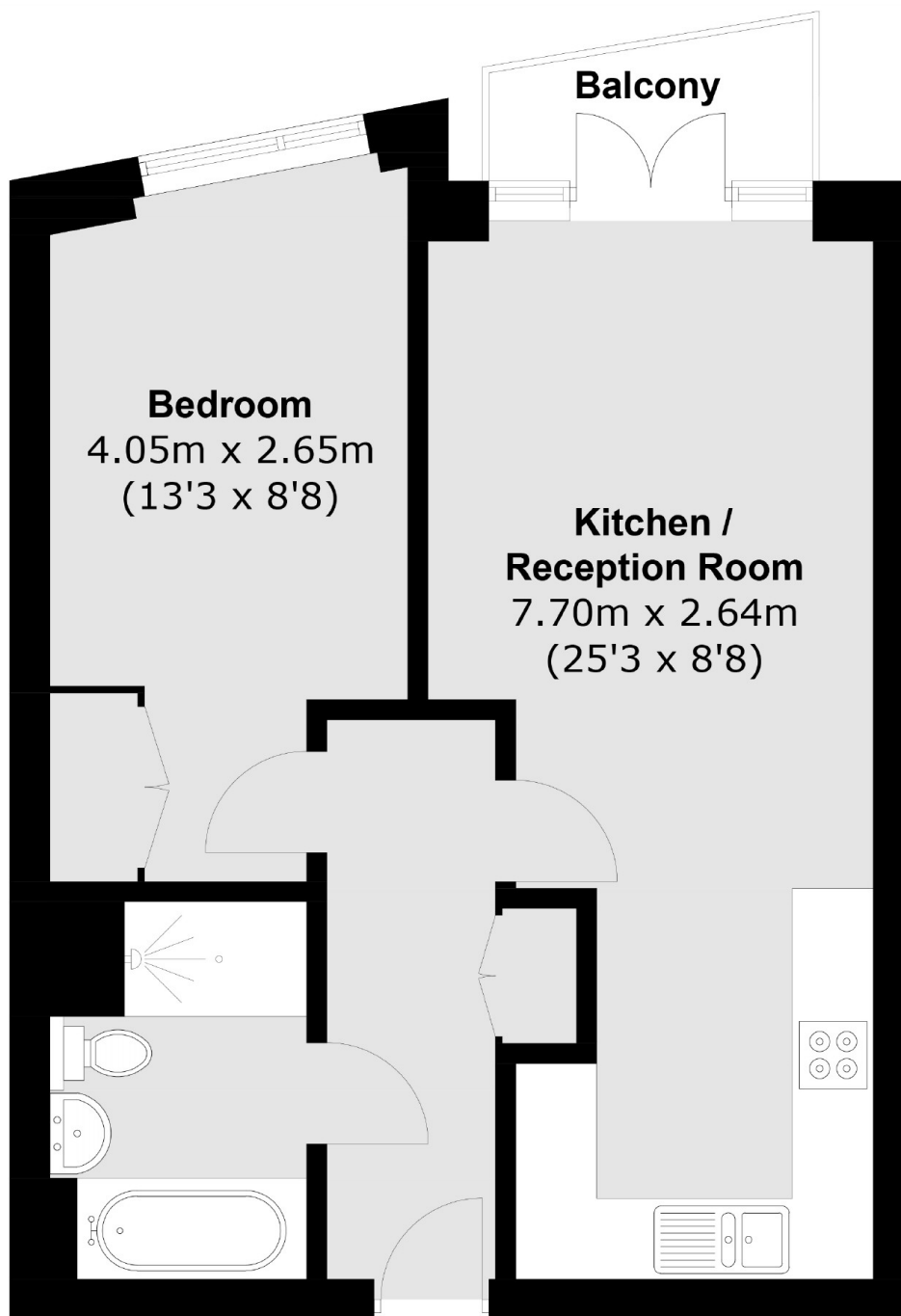

Total area (approx.): 48.5 sq. m (522.0 sq. ft)
Balcony area (approx.): 2.4 sq. m (25.8 sq. ft)