



£180,000

🔑 TENURE: Freehold

📊 EPC RATING: D

💰 COUNCIL TAX BAND: C

Holmcroft Stafford

Holmcroft Road Holmcroft
Stafford Staffordshire



Calling all first-time buyers and investors! An incredible opportunity awaits you with this charming two-bedroom semi-detached home located in the popular area of Holmcroft.

Ideally situated close to local shops, pubs, and amenities, this property is just a short drive to Stafford's town centre, the mainline train station, and offers easy access to the M6—making it perfect for commuters and those seeking convenience. Step inside to discover a welcoming entrance hall leading to a spacious living/dining room, a well-proportioned kitchen, and a utility room providing added functionality. Upstairs, you'll find two generous double bedrooms and a family bathroom. Outside, the property boasts a front garden and a private, enclosed rear garden—perfect for relaxing or entertaining. With no onward chain, this home is ready for its new owners to add their personal touch and make it their own. Don't miss out on this fantastic opportunity—call us today to arrange your viewing!

- Two Bedroom Semi Detached Family Home
- Large Living/Dining Room, Kitchen & Utility
- Two Bedroom & Bathroom
- Front Garden & Enclosed Private Rear Garden
- Fantastic Commuter Links Close To The M6

You can reach us **9am to 9pm**, 7 days a week

14 Salter Street, Stafford, Staffordshire, ST16 2JU

01785 223344

hello@dourishandday.co.uk



Entrance Hall

Accessed through a double glazed entrance door with stairs to first floor landing, under stairs storage cupboard, wood effect laminate flooring, radiator and double glazed window to the side elevation.

Living/Dining Room 19' 5" x 11' 8" (5.91m x 3.56m)

A large living/dining room having an electric fire set into a brick surround with granite hearth, a radiator, double glazed windows to the front and rear elevations and double glazed door to the rear elevation.

Kitchen 10' 8" x 8' 0" (3.26m x 2.45m)

Fitted with a matching range of base and eye level units incorporating fitted work surfaces and an inset stainless steel single bowl sink unit with chrome mixer tap, cooker with cooker hood over and further appliances, Tiled splash backs, wood effect laminate flooring, pantry and double glazed window to the rear elevation.



You can reach us **9am to 9pm**, 7 days a week

14 Salter Street, Stafford, Staffordshire, ST16 2JU

01785 223344

hello@dourishandday.co.uk

Utility 7' 5" x 7' 4" (2.25m x 2.24m)

A useful utility room with wood effect vinyl flooring, double glazed windows to the front and rear elevations and two doors to the front and rear elevations.

First Floor Landing

Having loft access and a double glazed window to the side elevation.

Bedroom One 9' 0" x 16' 8" (2.75m x 5.08m)

A large double bedroom having a wall mounted electric heater, over stairs storage cupboard and double glazed window to the front elevation.

Bedroom Two 10' 0" x 11' 5" (3.06m x 3.48m)

A second double bedroom having fitted double wardrobes, a wall mounted electric heater and double glazed window to the rear elevation.

Bathroom 5' 7" x 8' 1" (1.69m x 2.47m)

Having a white suite comprising of a panelled bath and electric shower over glazed screen with chrome mixer tap, half pedestal wash basin with chrome taps, close coupled WC, tiled walls, chrome towel radiator and double glazed window to the rear elevation.

Outside - Front

Having a small bricked wall with metal gate which leads to the front garden and paved steps leading to the entrance hall. The front garden has two lawned patches with an array of matured shrubs and a UPVC door giving access to the rear elevation.

Outside - Rear

Having a concrete seating area leading onto a large lawned garden and rear paved seating area. The garden is enclosed by wooden fence panelling.



GROUND FLOOR

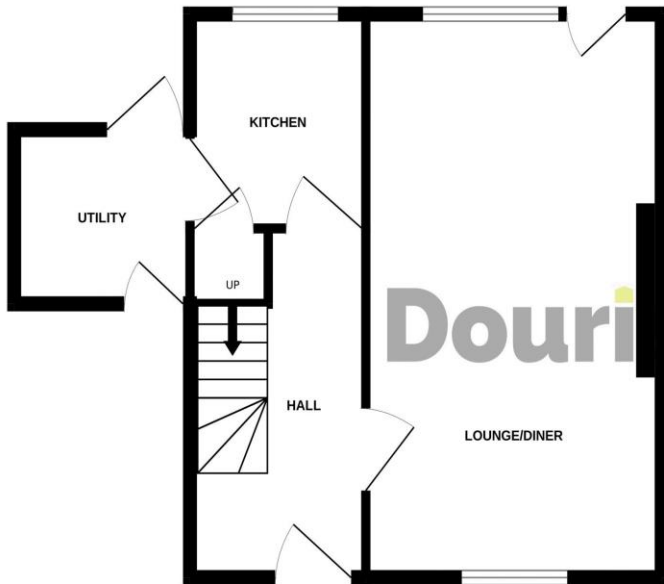

1ST FLOOR

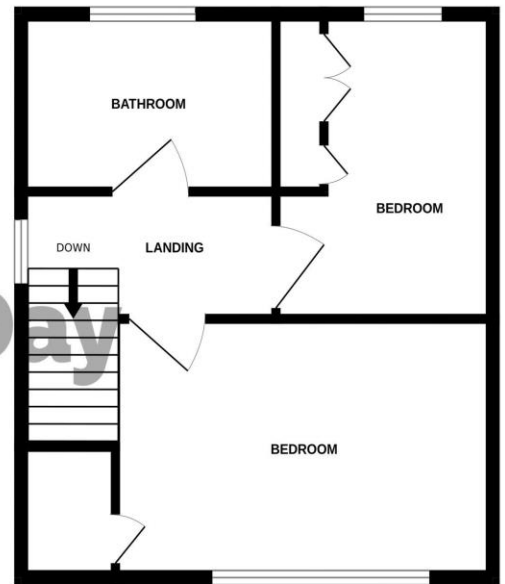

Whilst every attempt has been made to ensure the accuracy of the floorplan contained here, measurements of doors, windows, rooms and any other items are approximate and no responsibility is taken for any error, omission or mis-statement. This plan is for illustrative purposes only and should be used as such by any prospective purchaser. The services, systems and appliances shown have not been tested and no guarantee as to their operability or efficiency can be given.

Made with Metropix ©2024

Energy Efficiency Rating		Current	Potential
Energy efficient - lower running costs	(92+)		
A	(81-91)		
B	(69-80)		
C	(55-68)		
D	(39-54)		
E	(21-38)		
F	(11-20)		
G	(1-10)		
Low energy efficient - higher running costs			
		67	82

England & Wales EU Directive 2002/91/EC
www.epcrea.com



IMPORTANT NOTICE Dourish & Day for themselves and for the vendor or lessors of this property whose agents they are given notice that: (i) the particulars are set out as a general outline only for the guidance of intending purchasers or lessees, and do not constitute, nor constitute part of, an offer of contract, (ii) all descriptions, dimensions, references to condition and necessary permissions for use and occupation, and other details are given in good faith and are believed to be correct but any intending purchasers or tenants should not rely on them as statement or representation of fact but must satisfy themselves by inspection or otherwise as to the correctness of each of them, (iii) no person in the employment of Dourish & Day has any authority to make or give any representation or warranty whatever in relation to this property.

You can reach us **9am to 9pm**, 7 days a week

14 Salter Street, Stafford, Staffordshire, ST16 2JU

01785 223344

hello@dourishandday.co.uk