



£875,000

🔑 TENURE: Freehold

📊 EPC RATING: E

💷 COUNCIL TAX BAND: F

Haughton Stafford

Long Compton Haughton
Stafford Staffordshire



Discover the perfect blend of rural charm and luxury living with this exceptional equestrian property. Set on approximately 4 acres of picturesque land, this beautifully presented four-bedroom detached home offers a lifestyle of comfort, convenience, and possibilities for a granny/teenage annex.

For equestrian enthusiasts, the property boasts two superb stable blocks with room for up to five horses, complete with a tack room, ensuring your equine companions are well-cared for. The stunning formal garden, expansive vegetable garden, and various inviting seating areas create a serene oasis for relaxation and entertainment. You'll also find a unique enclosed duck run and a detached double garage for added convenience. Internally there are three reception rooms, dining kitchen, guest WC, guest shower room and a large utility room as well as four bedrooms, en-suite to bedroom one and a spacious family bathroom. Situated in desirable rural location, this property truly offers the best of both worlds – a tranquil rural setting with excellent equestrian facilities, all within easy reach of Stafford Town Centre.

- 4 Bed Detached Property On Approximately 4 Acre Plot
- Two Stable Blocks With Tack Room
- Beautiful Gardens, Duck Pond, Duck Run & Vegetable Garden
- Detached Double Garage & Ample Off Road Parking
- Three Reception Rooms & Potential Granny Annex
- Rural Location, Yet Convenient For Stafford Town Centre

You can reach us **9am to 9pm**, 7 days a week

14 Salter Street, Stafford, Staffordshire, ST16 2JU

01785 223344

hello@dourishandday.co.uk



Entrance Porch

Being accessed through double glazed double doors and having flagstone flooring and a double glazed door leading to:

Entrance Hall

A spacious 'L' shaped entrance hall having a contemporary style oak and glazed staircase leading to the first floor landing, radiator and double glazed windows to the front and side elevation

Guest WC

Having a suite comprising of a wash hand basin with chrome mixer tap and vanity unit beneath and low level WC. Built-in storage cupboard, radiator and double glazed window to the rear elevation.

Sitting Room 12' 0" x 10' 1" (3.67m x 3.08m)

Having a radiator and double glazed window to the front elevation.



You can reach us **9am to 9pm**, 7 days a week

14 Salter Street, Stafford, Staffordshire, ST16 2JU

01785 223344

hello@dourishandday.co.uk

Living Room 18' 3" x 11' 4" (5.56m x 3.46m)

Having a stone fire surround with matching inset and hearth and housing a cast iron multi fuel burner, coving, radiator, double glazed window with built-in blinds to the front elevation, two double glazed windows to the side elevation and an aluminium double glazed bi-folding door with built-in blind leading to the private seating area.

Dining Kitchen 20' 1" x 14' 2" (6.12m x 4.31m) - all max measurements

A spacious, open plan, beautifully presented dining kitchen which is in two sections and having a range of matching units extending to base and eye level and fitted work surfaces with an inset one and three quarter bowl sink unit with brushed stainless steel contemporary mixer tap. Matching dresser with glazed cabinets and a range of integrated appliances including an eye level double oven/grill, four ring halogen hob with cooker hood over hood, fridge, freezer and concealed inset central heating boiler. Tiled floor, splashback tiling, radiator, three double glazed windows to the side elevation, double glazed door and windows to the opposite elevation, one of which has a folding plantation shutters and a double glazed door leads to the side porch.

Side Porch

Having double glazed windows and double glazed door giving views and access to the paved seating area and garden beyond.

Utility 14' 1" x 11' 7" max (4.30m x 3.54m max)

A substantial utility room which includes a separate wall mounted Worcester central heating boiler. Fitted work surfaces with a composite sink drainer and mixer tap. Range of contemporary style base units with space and plumbing for appliances. Tiled floor, splashback tiling, radiator, double glazed windows with plantation shutters to the side and rear elevations and double glazed composite door.

First Floor Landing

Having access to loft space, radiator, double glazed window to the front elevation enjoying rural views and further double glazed window to the side elevation.





Bedroom Two 12' 0" x 10' 1" (3.65m x 3.08m)
Having a radiator and double glazed window to the front elevation.

Bedroom Three 10' 10" x 8' 0" (3.29m x 2.43m)
Having a radiator, double glazed window to the front elevation and double glazed double doors with Juliet balcony to the rear elevation overlooking the private rear garden and paddock.

Bedroom Four 8' 11" x 11' 3" (2.72m x 3.44m)
Having a radiator and double glazed window to the side elevation.

Family Bathroom 10' 11" max x 7' 8" (3.33m max x 2.33m)
A spacious and luxurious family bathroom having a panelled bath with mixer tap and pull-out shower head, wash hand basin set into a top with a mixer tap and a vanity unit beneath, bidet and a low level WC. Spotlighting,



You can reach us **9am to 9pm**, 7 days a week

14 Salter Street, Stafford, Staffordshire, ST16 2JU

01785 223344

hello@dourishandday.co.uk

two chrome towel radiators, splashback tiling and a double glazed window to the side elevation.

From the Utility Room, glazed folding door leads to:

Shower Room 5' 5" x 7' 8" (1.66m x 2.33m)

Having a suite which includes a corner shower cubicle with a mains shower, wash hand basin with a vanity unit beneath, bidet and low level WC. There are storage cabinets, towel radiator, tiled floor, shaver point and double glazed window to the rear elevation.

Third Reception Room / Potential Annexe 13' 5" x 8' 11" (4.09m x 2.72m)

Offering flexible usage with a radiator, double glazed windows to the front and rear elevation. A cast iron, spiral staircase leads to:

Bedroom One 14' 1" x 24' 11" (4.30m x 7.60m) - all max measurements

A substantial double bedroom having fitted double wardrobes and further open wardrobes with built-in shelving and hanging rails. Numerous downlights, two radiators, double glazed window to the side elevation and double glazed double doors with Juliet balcony to the rear elevation which overlooks the rear garden and paddock beyond. The measurements include the dressing area and the bedroom leads to:

Ensuite Shower Room 6' 1" x 7' 9" (1.85m x 2.36m)

Having a suite including a corner shower cubicle with an electric shower, contemporary style oval wash hand basin set onto a top with shelving beneath and chrome mixer tap, bidet and low level WC. Chrome towel radiator, shaver point and two double glazed windows to the side elevation.

Outside

The property is approached through two, five bar gates with a tarmac driveway which leads to a substantial detached brick built double garage. The property sits on approximately four acres and this includes formal gardens which extend to approximately half an acre with well stocked, block edge borders having a variety of shrubs and trees and the remainder of the garden is mainly laid to lawn. There are a variety of stunning borders and flower beds and a large gravelled area with a five





bar gate leads to the front elevation. There is a further paved seating area, substantial vegetable garden with raised beds. In addition, there is a potting shed and a further substantial work shed with work bench. There is duck pond with an enclosed duck run.

Double Stable Block / Tack Room

Having power and lighting.

From the driveway, a further five bar gate leads to a further paddock area and further five bar gate leads to an additional paddock which measures approximately 3.00 to 3.50 acres.

Four Bay Stable Block

Having power and lighting.



You can reach us **9am to 9pm**, 7 days a week

14 Salter Street, Stafford, Staffordshire, ST16 2JU

01785 223344

hello@dourishandday.co.uk

Brick Built Double Garage 18' 9" x 19' 4" (5.72m x 5.89m)

Having power, lighting, two electronic up and over doors to the front elevation and double glazed window to the side elevation. In addition, attached to the external wall of the garage is an extremely useful log store.

Agents Note-Services

Private drainage (septic Tank). Lpg Heating.

ID Checks

Once an offer is accepted on a property marketed by Dourish & Day estate agents we are required to complete ID verification checks on all buyers and to apply ongoing monitoring until the transaction ends. Whilst this is the responsibility of Dourish & Day we may use the services of MoveButler, to verify Clients' identity. This is not a credit check and therefore will have no effect on your credit history. You agree for us to complete these checks, and the cost of these checks is £30.00 inc. VAT per buyer. This is paid in advance, when an offer is agreed and prior to a sales memorandum being issued. This charge is non-refundable.



You can reach us **9am to 9pm**, 7 days a week

14 Salter Street, Stafford, Staffordshire, ST16 2JU

01785 223344

hello@dourishandday.co.uk

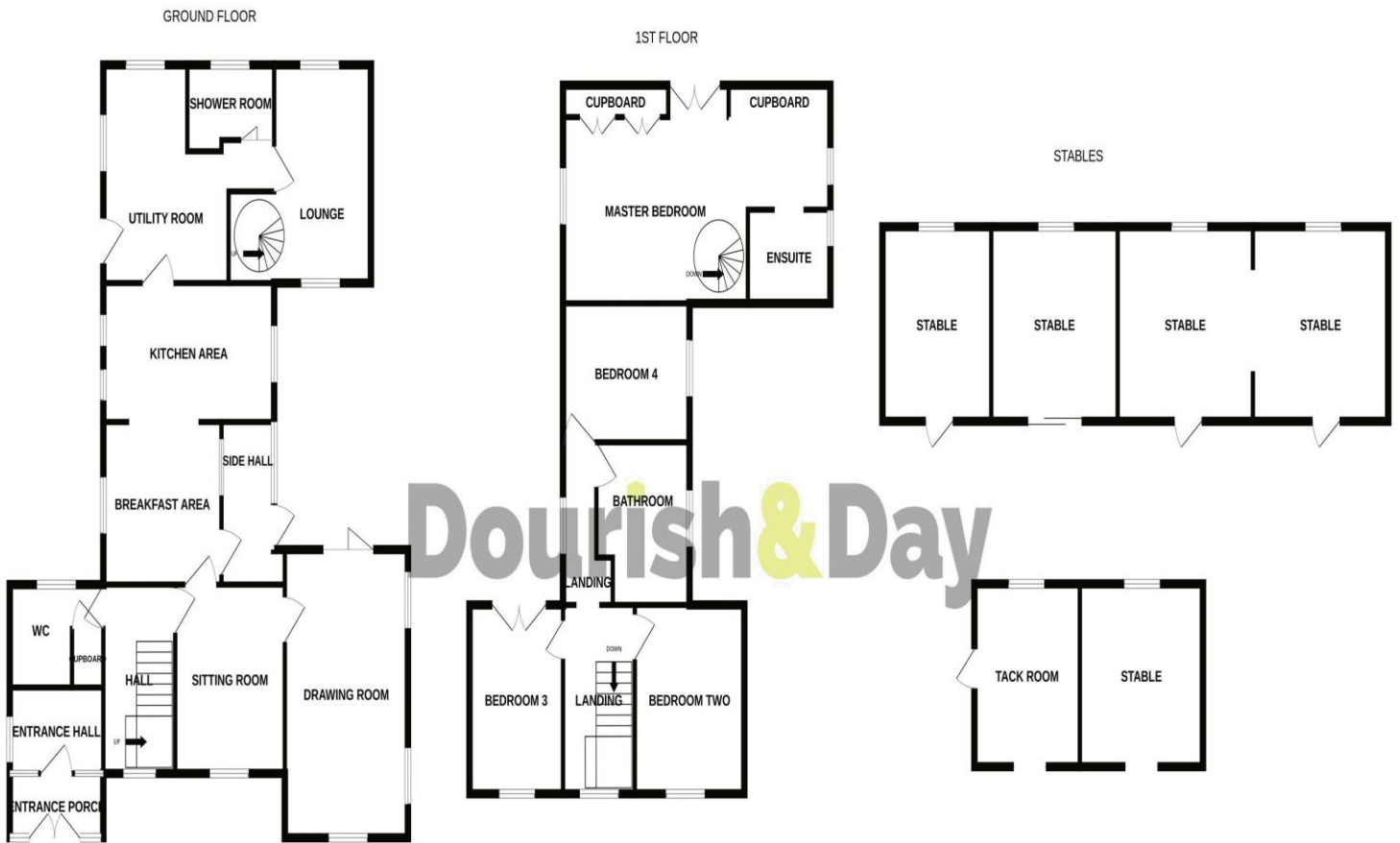

Whilst every attempt has been made to ensure the accuracy of the floorplan contained here, measurements of doors, windows, rooms and any other items are approximate and no responsibility is taken for any error, omission or mis-statement. This plan is for illustrative purposes only and should be used as such by any prospective purchaser. The services, systems and appliances shown have not been tested and no guarantee as to their operability or efficiency can be given.
Made with Metropix ©2024

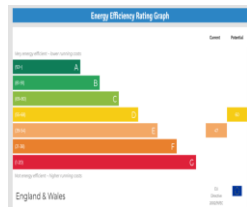

IMPORTANT NOTICE Dourish & Day for themselves and for the vendor or lessors of this property whose agents they are given notice that: (i) the particulars are set out as a general outline only for the guidance of intending purchasers or lessees, and do not constitute, nor constitute part of, an offer of contract, (ii) all descriptions, dimensions, references to condition and necessary permissions for use and occupation, and other details are given in good faith and are believed to be correct but any intending purchasers or tenants should not rely on them as statement or representation of fact but must satisfy themselves by inspection or otherwise as to the correctness of each of them, (iii) no person in the employment of Dourish & Day has any authority to make or give any representation or warranty whatever in relation to this property.

You can reach us **9am to 9pm**, 7 days a week

14 Salter Street, Stafford, Staffordshire, ST16 2JU

01785 223344

hello@dourishandday.co.uk