



Offers Over £850,000

🔑 TENURE: Freehold

📊 EPC RATING: D

£ COUNCIL TAX BAND: F

Coppenhall Stafford

Beech Lane Coppenhall
Stafford Staffordshire



Nestled in the sought-after village of Coppenhall, this fully modernised four-bedroom detached residence offers stunning, far reaching panoramic rural views yet enjoys convenient access to M6 Junction 13 for the daily commuter.

The property features a large private garden on three sides, a five-car garage with workshop area, and an open-plan family dining kitchen with bifold doors. Inside, the spacious living room provides a cosy retreat with Bi folding doors showcasing the captivating scenery. The home office, fitted with bespoke oak units and desks, is perfect for remote work. Two of the generously sized bedrooms boast en-suite bathrooms, while the additional family bathroom caters to the household's needs. With its elegant design, luxurious finishes, and a truly exceptional location, this home combines contemporary comfort with rural tranquillity, making it an ideal sanctuary for families seeking convenience and serenity.

- Stunning Fully Modernised 4 Bed Det House
- Far Reaching Panoramic Rural Views
- Five Car Garage/Workshop & Ample Parking
- Substantial Private Gardens & Terrace
- Highly Desirable Village Location
- Excellent Nearby Commuter Links

You can reach us **9am to 9pm**, 7 days a week

14 Salter Street, Stafford, Staffordshire, ST16 2JU

01785 223344

hello@dourishandday.co.uk



Entrance Hall

Being accessed through a double glazed composite entrance door, the spacious entrance hallway includes Karndean wood effect flooring, understairs storage cupboard, recessed downlights, two modern radiators, staircase off to the first floor landing with further understairs storage cupboard and double glazed window to the side elevation.

Guest WC 5' 5" x 6' 3" (1.64m x 1.91m)

A modern refitted contemporary style suite which includes a rectangular wash and base set onto a marble effect top with freestanding contemporary style chrome mixer tap and contemporary style storage drawers and low level WC. Radiator, tile effect flooring, recessed downlights and double glazed window to the front elevation.

Lounge 13' 9" x 23' 4" (4.20m x 7.10m)

A truly stunning and substantial lounge with aluminium bi-folding doors which enjoy super, elevated and panoramic far rural views and give access to the porcelain tiled patio area. Entertainment wall with built-in shelving and LED lighting, and two traditional style radiators.



You can reach us **9am to 9pm**, 7 days a week

14 Salter Street, Stafford, Staffordshire, ST16 2JU

01785 223344

hello@dourishandday.co.uk

Family Dining Kitchen 25' 9" x 23' 0" (7.85m x 7.02m) - all max measurements

A substantial, open plan family dining kitchen with family area, dining area and a breakfast kitchen area. The kitchen includes Shaker style units extending to base and eye level and fitted work surfaces with a range of integrated appliances including two ovens/grills, induction hob with a contemporary style cooker over with glass splashback, integrated full size fridge, full size freezer wine cooler and dishwasher. Bevelled edge splashback tiling, breakfast island with an inset one and a half bowl sink unit with mixer tap, wood effect Amtico flooring, matching Shaker style built-in larder unit, numerous downlights, two traditional style radiators, double glazed roof lantern with built-in blind, double glazed window to the side elevation and double glazed aluminium bi-folding doors which again enjoy the stunning far reaching views and lead out to the composite decked seating area and rear garden.

Rear Hall / Storage Room

Having a range of Shaker style base units with fitted wood effect work surfaces, wood effect Amtico style flooring, radiator, double glazed window and door to the side elevation.

Walk-In Store Room / Airing Cupboard

Housing the wall mounted gas central heating boiler and wood effect flooring.

Utility Room

 7' 10" x 5' 10" (2.38m x 1.79m)

Having space and plumbing for appliances, elevated shower tray / dog wash station with storage beneath. Fitted work surfaces with a composite sink drainer with mixer tap, wood effect flooring, radiator and double glazed window to the rear elevation.

Study

 19' 7" x 9' 9" (5.98m x 2.98m)

A purpose hand built study with handmade with three oak desk areas, tall display cabinets to one wall and further handmade oak vase units and drawers and further matching storage unit with fitted shelving, Numerous downlights, access to loft space, wood effect Karndean flooring, radiator, double glazed bay window to the front elevation with built-in blinds and double glazed window to the rear elevation.

First Floor Landing

Having under eaves storage, spacious walk-in storage cupboard with shelving, two radiators and double glazed window to the front elevation.





Bedroom One 14' 2" x 16' 10" (4.33m x 5.12m)

A substantial main bedroom having a radiator and double glazed window to the rear elevation enjoying stunning views.

Walk-in Wardrobe 7' 6" x 9' 9" (2.28m x 2.98m)

A large, walk-in wardrobe having purpose made fitted shelving and hanging rails, radiator and double glazed window to the side elevation.

Luxurious Ensuite 6' 3" x 9' 8" (1.91m x 2.94m)

Being fitted in a modern and contemporary style, the refitted suite includes a double walk-in shower cubicle housing a mains shower, half pedestal wash basin with chrome mixer tap and low level WC. Tiled walls, Karndean wood effect flooring, downlights, chrome towel radiator and two double glazed windows to the side and rear elevations again with built-in blinds and enjoying the elevated panoramic views.



You can reach us **9am to 9pm**, 7 days a week

14 Salter Street, Stafford, Staffordshire, ST16 2JU

01785 223344

hello@dourishandday.co.uk

Bedroom Two 10' 7" x 12' 0" (3.23m x 3.65m)

A second double bedroom having a spacious built-in wardrobe with shelving and hanging rail, radiator and double glazed window to the rear elevation with stunning, far reaching views..



Ensuite Shower Room 6' 11" x 6' 9" (2.12m x 2.07m)

Having a tiled shower cubicle with a mains shower fitted, oval; wash hand basin set onto a top with chrome mixer tap and vanity unit beneath and low level WC. Tiled walls, Kardean wood effect flooring, downlights, chrome towel radiator and double glazed window to the rear elevation.

Bedroom Three 10' 6" x 12' 11" (3.19m x 3.93m)

A third double bedroom having a radiator and double glazed window to the rear elevation enjoying the views.



Bedroom Four 13' 7" x 13' 6" (4.14m x 4.11m) - all max measurements

A 'T' shaped bedroom having two spacious built-in storage cupboards, downlights, radiator and double glazed windows to both the side and rear elevations.

Family Bathroom 9' 0" x 9' 10" (2.74m x 3.00m)

Having a suite comprising of a panelled bath with a central chrome mixer tap, tiled shower cubicle with a multi-jet 'Aqualisa' shower, oval jacuzzi wash basin with chrome mixer tap set into a top with a vanity unit beneath and low level WC. Tiled walls, downlights, access to loft space, chrome towel radiator and double glazed window to the rear elevation.



Outside

The property sits on a substantial end plot and is approached over a block edge tarmac 'in and out' driveway which also provides parking for numerous vehicles and access is available either side of the property to the rear garden. A five-bar gate leads to an additional side lawned garden and there is a large hardstanding / paved area which would be ideal for a motorhome, caravan or boat. A gate leads to the large, beautifully maintained rear garden which is private and enjoys far reaching panoramic views. The garden is mainly laid to lawn with mature trees and there is a substantial porcelain terrace area, a composite decked seating area with LED lighting and a further paved seating area.

Triple Width Tandem Garage 35' 5" x 33' 5" (10.79m x 10.19m) - all max measurements

The triple width, tandem length garage which also incorporates a workshop area with three electronic roller doors to the front and the substantial workshop area has two radiators, power, lighting, access to loft space, two double glazed to the rear elevation and double glazed window and double glazed door to the front elevation.



You can reach us **9am to 9pm, 7 days a week**

14 Salter Street, Stafford, Staffordshire, ST16 2JU

01785 223344

hello@dourishandday.co.uk

GROUND FLOOR

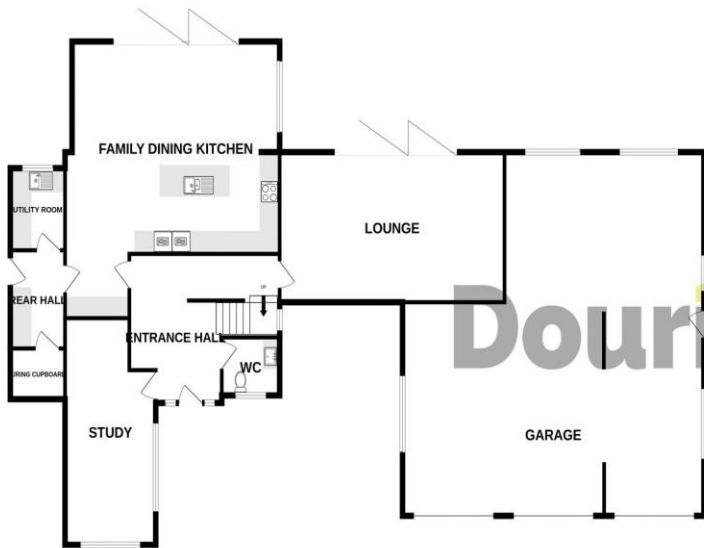

1ST FLOOR

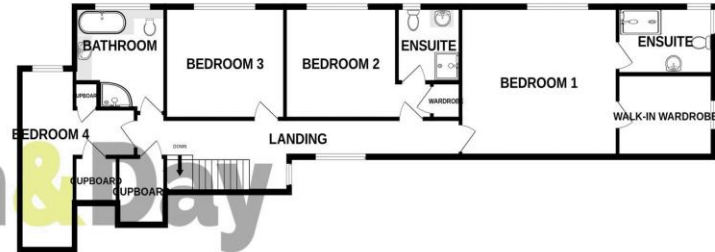

Whilst every attempt has been made to ensure the accuracy of the floorplan contained here, measurements of doors, windows, rooms and any other items are approximate and no responsibility is taken for any error, omission or mis-statement. This plan is for illustrative purposes only and should be used as such by any prospective purchaser. The services, systems and appliances shown have not been tested and no guarantee as to their operability or efficiency can be given.
Made with Metropix ©2024



IMPORTANT NOTICE Dourish & Day for themselves and for the vendor or lessors of this property whose agents they are given notice that: (i) the particulars are set out as a general outline only for the guidance of intending purchasers or lessees, and do not constitute, nor constitute part of, an offer of contract, (ii) all descriptions, dimensions, references to condition and necessary permissions for use and occupation, and other details are given in good faith and are believed to be correct but any intending purchasers or tenants should not rely on them as statement or representation of fact but must satisfy themselves by inspection or otherwise as to the correctness of each of them, (iii) no person in the employment of Dourish & Day has any authority to make or give any representation or warranty whatever in relation to this property.

You can reach us **9am to 9pm**, 7 days a week

14 Salter Street, Stafford, Staffordshire, ST16 2JU

01785 223344

hello@dourishandday.co.uk