



Offers Over £270,000

🔑 TENURE: Freehold

📊 EPC RATING: E

🏠 COUNCIL TAX BAND: C

Stafford

Newport Road
Stafford Staffordshire



READY TO MAKE YOUR OWN! If your **WISH LIST** has the following: spacious rooms, three bedrooms, private rear garden, walking distance to Stafford's mainline railway station, near the Town Centre and with the opportunity to add your own flare then we think we may have found the property for you!

This home beautifully positioned and internally comprises of an entrance hall, guest WC, living room, dining room, conservatory, kitchen, breakfast room, utility, and veranda all on the ground floor. Upstairs is where you will find the three bedrooms and shower room. Outside is that well established plot which offers both front and rear gardens and a two garages and a carport which are located to the rear of the house.

- Traditional Semi-Detached Family Home
- Requires Modernisation Throughout
- Living Room, Dining Room & Conservatory
- Kitchen, Breakfast Room & Utility
- Three Bedrooms & Shower Room
- Well Established Garden Plot with Two Garages & Carport

You can reach us **9am to 9pm**, 7 days a week

14 Salter Street, Stafford, Staffordshire, ST16 2JU

01785 223344

hello@dourishandday.co.uk



Entrance Hallway

Accessed through a double glazed entrance door, and featuring Parquet style wood flooring, a useful storage cupboard, stairs off, rising to the First Floor Landing & accommodation, a radiator, a double glazed window to the side elevation, and internal door(s) off, providing access to;

Guest WC 4' 6" x 2' 7" (1.37m x 0.79m)

Fitted with a suite comprising of a low-level WC, and a wash hand basin with mixer taps. There is also, ceramic tiled flooring, and a double glazed window to the side elevation.

Living Room 14' 10" x 11' 10" (4.51m x 3.60m) (measured INTO bay window recess)

A good sized reception room, featuring a double glazed bay window to the front elevation, and having a radiator.

Dining Room 11' 5" x 10' 10" (3.48m x 3.29m)

A second reception room having double doors leading through into the Conservatory, and a radiator.

Conservatory 10' 2" x 7' 2" (3.10m x 2.19m)

Having tiled effect flooring, two double glazed windows, and a double glazed door leading out into the garden.



You can reach us **9am to 9pm**, 7 days a week

14 Salter Street, Stafford, Staffordshire, ST16 2JU

01785 223344

hello@dourishandday.co.uk

Breakfast Room 6' 9" x 11' 2" (2.06m x 3.40m)

Having a door leading out into the Veranda, a radiator, and two windows.

Kitchen 9' 0" x 7' 10" (2.74m x 2.39m)

Fitted with wall, base & drawer units, and a work surface incorporating an inset sink with drainer & mixer tap, and appliances which include an integrated oven & hob with space for a dishwasher. The room also has ceramic tiled flooring, and a double glazed window to the side elevation.

Utility Room 5' 4" x 7' 3" (1.63m x 2.21m)

Fitted with base units with a work surface over incorporating an inset sink with drainer & mixer tap, and space to accommodate a washing machine. The room also has ceramic tiled flooring, and a double glazed window to the rear elevation.

Véranda 8' 8" x 8' 4" (2.64m x 2.55m)

Fitted with wall-to-wall windows and having front & rear facing doors.

First Floor Landing

Having a double glazed window to the side elevation, an access point to the loft space, and internal door(s) off, providing access to;

Bedroom One 13' 5" x 10' 0" (4.08m x 3.05m)

A double bedroom with wall-to-wall built-in wardrobes, a double glazed window to the front elevation, and a radiator.

Bedroom Two 11' 5" x 10' 9" (3.47m x 3.27m)

A second double bedroom fitted with a vanity wash hand basin, and having a double glazed window to the rear elevation, and radiator.

Bedroom Three 7' 1" x 6' 10" (2.16m x 2.08m)

Having wood effect flooring, a storage cupboard, radiator, and a double glazed window to the side elevation.

Shower Room 8' 6" x 7' 11" (2.58m x 2.42m) (maximum measurements)

Fitted with a suite comprising of a low-level WC, a pedestal wash hand basin, and a shower cubicle housing an electric shower. There is also tiled effect flooring, a chrome towel radiator, and two double glazed windows.

Outside Front

The property is approached over a driveway which provides off-street parking, and sits behind a long lawned front garden with a pathway leading up to the front entrance door.

Outside Rear

A well-established rear garden that features a gravelled garden area, a further small lawned garden area, and large well stocked planting beds. There is also a gated rear access leading out to the Garages & Carport.

Garages & Carport

Both garages have up and over access doors to the front elevation, one of which benefits from having both power & lighting installed. The garages are accessed via a rear service road which we understand has right of way.



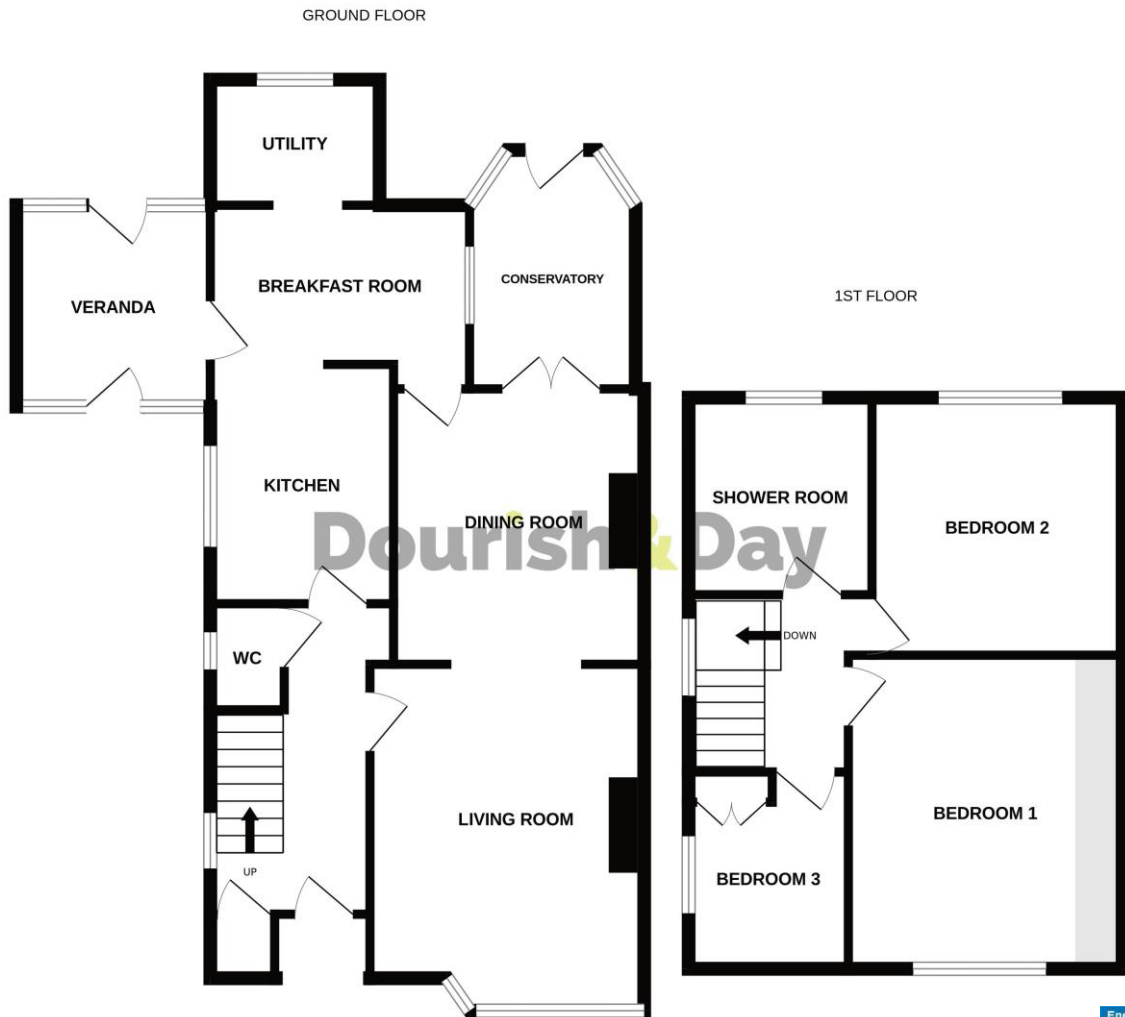

Whilst every attempt has been made to ensure the accuracy of the floorplan contained here, measurements of doors, windows, rooms and any other items are approximate and no responsibility is taken for any error, omission or mis-statement. This plan is for illustrative purposes only and should be used as such by any prospective purchaser. The services, systems and appliances shown have not been tested and no guarantee as to their operability or efficiency can be given.
Made with Metropix ©2023

Energy Efficiency Rating		Current	Potential
Energy efficient - lower running costs	(92+)		
A	(81-91)		
B	(69-80)		
C	(55-68)		
D	(39-54)		
E	(21-38)		
F	(13-20)		
G	(1-12)		
Not energy efficient - higher running costs			
England & Wales			EU Directive 2002/91/EC
			www.ec.europa.eu



IMPORTANT NOTICE Dourish & Day for themselves and for the vendor or lessors of this property whose agents they are given notice that: (i) the particulars are set out as a general outline only for the guidance of intending purchasers or lessees, and do not constitute, nor constitute part of, an offer of contract, (ii) all descriptions, dimensions, references to condition and necessary permissions for use and occupation, and other details are given in good faith and are believed to be correct but any intending purchasers or tenants should not rely on them as statement or representation of fact but must satisfy themselves by inspection or otherwise as to the correctness of each of them, (iii) no person in the employment of Dourish & Day has any authority to make or give any representation or warranty whatever in relation to this property.

You can reach us **9am to 9pm**, 7 days a week

14 Salter Street, Stafford, Staffordshire, ST16 2JU

01785 223344

hello@dourishandday.co.uk