



£220,000

🔑 TENURE: Leasehold

📊 EPC RATING: B

💷 COUNCIL TAX BAND: D

## Stafford

Brooklands House Eccleshall Road  
Stafford Staffordshire



*Are you looking for a spacious and secure retirement apartment? Then this truly stunning and substantial two-bedroom first floor apartment will be perfect for you. Located within the highly desirable Brooklands House development, all residents have access to the beautifully landscaped and maintained gardens as well as a resident's lounge, restaurant, activity room, Spa and Therapy Suite, Hairdressing Salon, mobility scooter/cycle store and a guest suite for visitors.*

This particular apartment comprises a spacious entrance hallway with a utility cupboard off with space for a washer and dryer, large living/dining room with French doors onto the balcony, fitted and fully integrated kitchen, two double bedrooms with the largest having an En-suite shower room and a luxury bathroom.

- Superb Over 65's First Floor Retirement Apartment
- Luxury First Floor Apartment
- Two Large Double Bedrooms
- Lounge Diner With French Doors To Decked Seating Area
- En-Suite Shower Room, Bathroom & Utility
- Beautiful, Well Stocked Communal Gardens With Seating Areas

You can reach us **9am to 9pm**, 7 days a week

14 Salter Street, Stafford, Staffordshire, ST16 2JU

**01785 223344**

hello@dourishandday.co.uk





## The Apartments

\* Beautifully appointed kitchens with fully-integrated appliances including oven, ceramic hob, extractor, fridge/freezer, microwave and dishwasher \* Balcony or patio to most apartments \* Fully-tiled and level-access shower rooms with slip resistant floors \* Luxurious tiled bathrooms to select apartments \* Quality fitted carpets throughout \* Fitted wardrobe to master bedroom \* Utility cupboards with space for a washer/dryer and, in most cases, separate storage rooms \* 24-hour emergency call system linked directly to the dedicated MHA on site care team \* Audio and video entry system to main entrance controlled from your apartment \* Fire and smoke detectors to all apartments \* Wider doorways and spacious rooms for ease of wheelchair access \* Ample easy to reach sockets, light switches and telephone points \* Electric throughout with energy-efficient hot water and heating system

## Shared Areas

-- Elegant table service restaurant -- Stylishly appointed lounge -- Activities and crafts room -- Spa suite -- Hairdressing salon -- Internal mobility scooter store with electric charging facilities -- Family guest suite with En-suite shower room, television and tea/coffee making facilities -- Two lifts to all floors -- Private residents' parking -- Fully landscaped gardens



You can reach us **9am to 9pm**, 7 days a week

14 Salter Street, Stafford, Staffordshire, ST16 2JU

**01785 223344**

[hello@dourishandday.co.uk](mailto:hello@dourishandday.co.uk)

## Entrance Hallway

A door opens from the communal hallway to a spacious entrance hall with an abundance of storage, including a large walk-in cupboard housing the pressurised water system and a separate cupboard housing space for both a washing machine and tumble dryer with shelving above. The entrance hall is fitted with recessed ceiling spotlights and also has the video intercom system.

## Lounge/Diner 22' 9" x 11' 2" (6.93m x 3.40m)

This large open plan space has ample room for both a sitting room suite and separate dining table and chairs, whilst a contemporary electric fire provides a focal point to the room. There are TV and telephone points, a wall mounted electric heater and UPVC double glazed double doors opening out to a balcony, with glass balustrades.

## Kitchen 10' 4" x 7' 11" (3.16m x 2.41m)

The beautifully appointed kitchen is fitted with a range of matching base cabinets and wall units, whilst a one and a half bowl stainless steel sink is set into a wood effect work surface with matching splash back and has a chrome mixer tap. The kitchen benefits from having under cabinet lighting and a range of integrated appliances including a fridge/freezer, oven and eye level microwave Combi oven. There is also a four ring electric hob set into the work surface, with stainless steel splash back and extractor hood above. The kitchen is fitted with a vinyl tile effect flooring, recessed ceiling spotlights and a UPVC double glazed window.

## Bedroom One 19' 4" x 17' 6" (5.90m x 5.33m)

The property benefits from having two large double bedrooms, the biggest of which being the master, which benefits from having a large built-in walk-in wardrobe, whilst there is a wall mounted electric heater and TV point. A door opens to the en-suite.

## En-Suite (Bedroom One) 5' 6" x 8' 2" (1.67m x 2.50m)

The master bedroom benefits from having its own en-suite/wet room, which is fitted with a contemporary white suite, including an integrated low level flush WC, pedestal wash hand basin and wet room area with chrome mixer tap. A chrome heated towel rail sits upon the fully tiled walls, whilst there are recessed ceiling spotlights and extractor fan.

## Bedroom Two 13' 8" x 12' 6" (4.17m x 3.82m)

A second large double bedroom is fitted with a wall mounted electric heater and a UPVC double glazed window.

## Bathroom 8' 3" x 5' 7" (2.51m x 1.71m)

The stunning family bathroom is fitted with a contemporary white suite, which includes an integrated low level flush WC, pedestal wash hand basin with chrome mixer tap and a panelled bath with chrome mixer tap and shower head attachment. A chrome heated towel rail sits on the fully tiled walls, whilst there is a vinyl wood effect flooring, recessed ceiling spotlights and an extractor fan.





## FIRST FLOOR

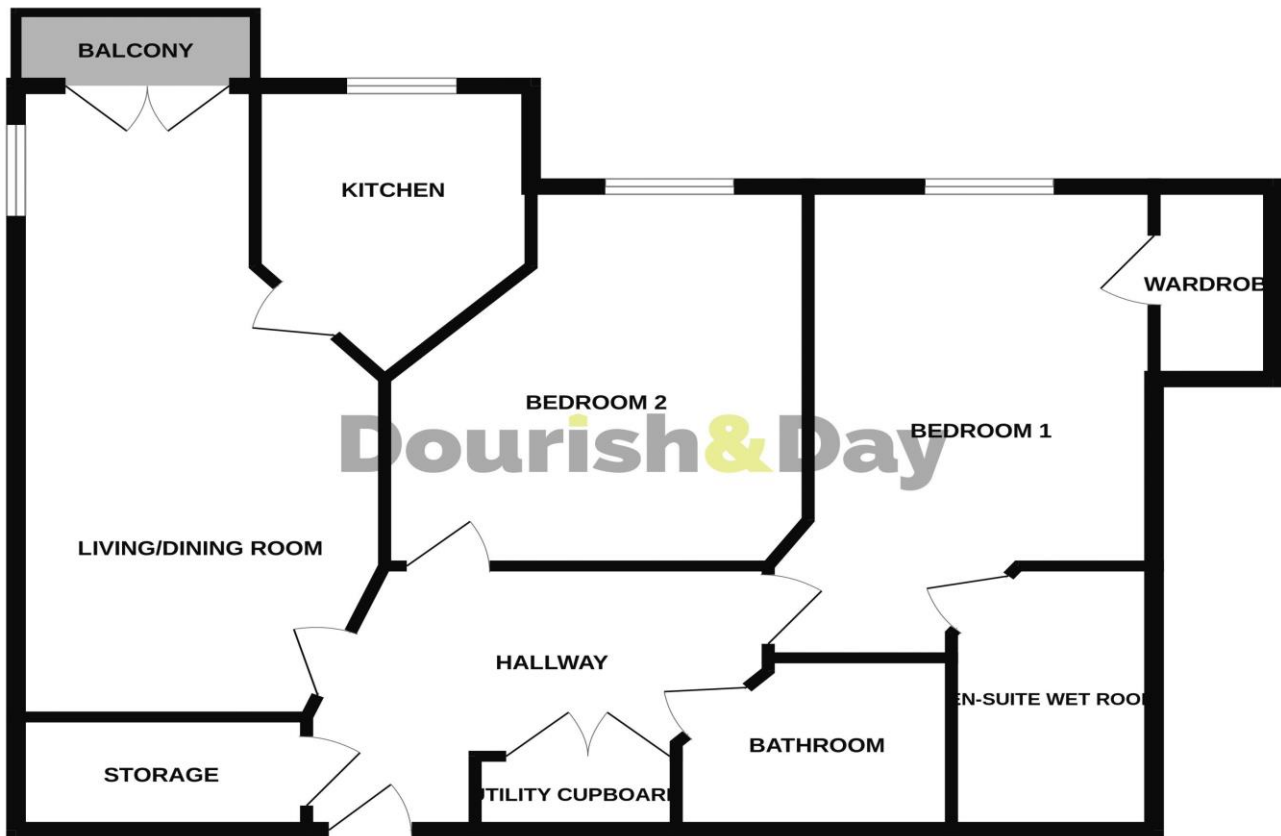

Energy Efficiency Rating		Current	Potential
Very energy efficient - lowest running costs	(92+)		
A	(81-91)		
B	(69-80)		
C	(55-68)		
D	(39-54)		
E	(21-38)		
F	(13-20)		
G	(1-12)		
Very energy efficient - lowest running costs	(92+)		
A	(81-91)		
B	(69-80)		
C	(55-68)		
D	(39-54)		
E	(21-38)		
F	(13-20)		
G	(1-12)		
England & Wales		88	88
EU Directive 2002/91/EC			
www.epcrea.com			

Whilst every attempt has been made to ensure the accuracy of the floorplan contained here, measurements of doors, windows, rooms and any other items are approximate and no responsibility is taken for any error, omission or mis-statement. This plan is for illustrative purposes only and should be used as such by any prospective purchaser. The services, systems and appliances shown have not been tested and no guarantee as to their operability or efficiency can be given.  
Made with Metropix ©2023



**IMPORTANT NOTICE** Dourish & Day for themselves and for the vendor or lessors of this property whose agents they are given notice that: (i) the particulars are set out as a general outline only for the guidance of intending purchasers or lessees, and do not constitute, nor constitute part of, an offer of contract, (ii) all descriptions, dimensions, references to condition and necessary permissions for use and occupation, and other details are given in good faith and are believed to be correct but any intending purchasers or tenants should not rely on them as statement or representation of fact but must satisfy themselves by inspection or otherwise as to the correctness of each of them, (iii) no person in the employment of Dourish & Day has any authority to make or give any representation or warranty whatever in relation to this property.

You can reach us **9am to 9pm, 7 days a week**

14 Salter Street, Stafford, Staffordshire, ST16 2JU

**01785 223344**

hello@dourishandday.co.uk