

Hyman
Estate & Letting



Hill
Agent



114 Church Green, Shoreham-by-Sea, West Sussex, BN43 6JU

114 Church Green, Shoreham by-Sea, West Sussex, BN43 6JU

£250,000 - Freehold



A very well presented ONE BEDROOM house, located in a highly popular location



Hyman Hill is delighted to offer for sale this very well presented ONE BEDROOM HOUSE located in a highly popular location in Shoreham.

The property benefits from a good-sized lounge opening onto a very well-presented kitchen having a double-glazed door to garden, one double bedroom and a bathroom.

This property is an ideal buy for a first time or an investment buyer and viewings are highly recommended.

Viewing is a must, and the property is being sold with no chain. Shoreham-by-Sea is a charming, historic town, 7 miles west of Brighton and 6 miles east of Worthing. The town centre is vibrant offering lots of independent and corporate shops, cafes, pubs and restaurants. The Holmbush Shopping Centre can be found close

by providing a large M&S, Next and Tesco.

There is excellent access to the east/west A27 & M23 and public transport services including Shoreham-by-Sea mainline railway station is only a short walk away offering direct trains to Brighton, London and to the west.

The property is in catchment of Primary & Secondary schools, including popular Shoreham Academy with its 'Outstanding' Ofsted rating.

Shoreham by Sea also benefits from a highly popular Beach, South Downs National Park and River Adur affording fantastic water sports and walking opportunities

-
- One bedroom house
 - Good sized lounge
 - Well presented kitchen
 - Well presented bathroom
 - Access to garden
 - Allocated parking space
 - Highly popular location
 - No chain



Ground Floor

Approx. 247.9 sq. feet

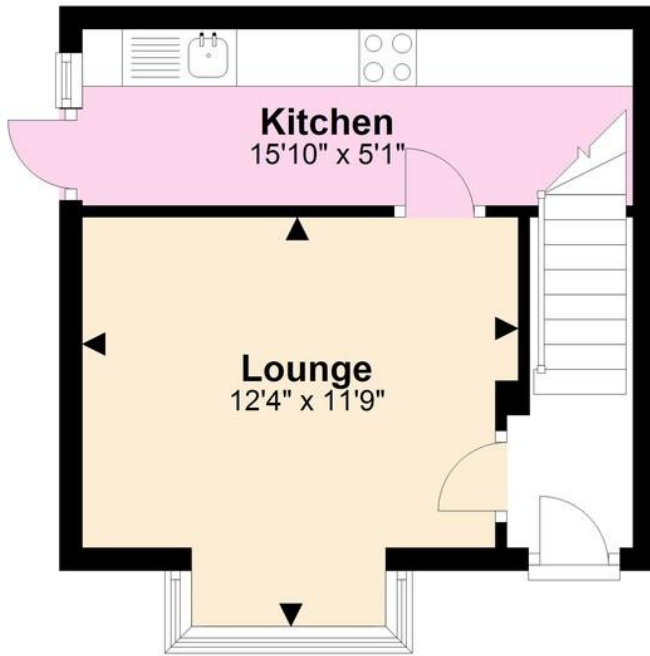

First Floor

Approx. 246.8 sq. feet



Total area: approx. 494.7 sq. feet

For illustrative purposes only. Not to scale.
Plan produced using PlanUp.

Score	Energy rating	Current	Potential
92+	A		
81-91	B		91 B
69-80	C	71 C	
55-68	D		
39-54	E		
21-38	F		
1-20	G		

Useful Information

Council Tax: B - £1,796.98
per annum (2024/2025)

Tenure: Freehold

Local Authority: Adur District
Council



To book a viewing, or a valuation of your own property, get in touch with one of our experts.

Southwick – 01273 597730
info@hymanhill.co.uk

Shoreham – 01273 454511
shoreham@hymanhill.co.uk

Lettings – 01273 597730
lettings@hymanhill.co.uk

www.hymanhill.co.uk