





Kitchen / Dining
15528'2"m x 10488'10"m

Lounge
16407'5"m x 12234'3"m

WC
5121'4"m x 3458'0"m

FAMILY BATHROOM
8195'6"m x 6512'5"m

SECOND BEDROOM
13503'11"m x 8723'9"m

THIRD BEDROOM
12001'3"m x 8723'9"m

MASTER BEDROOM
21919'3"m x 15528'2"m

Ensuite
3900'11"m x 8192'3"m







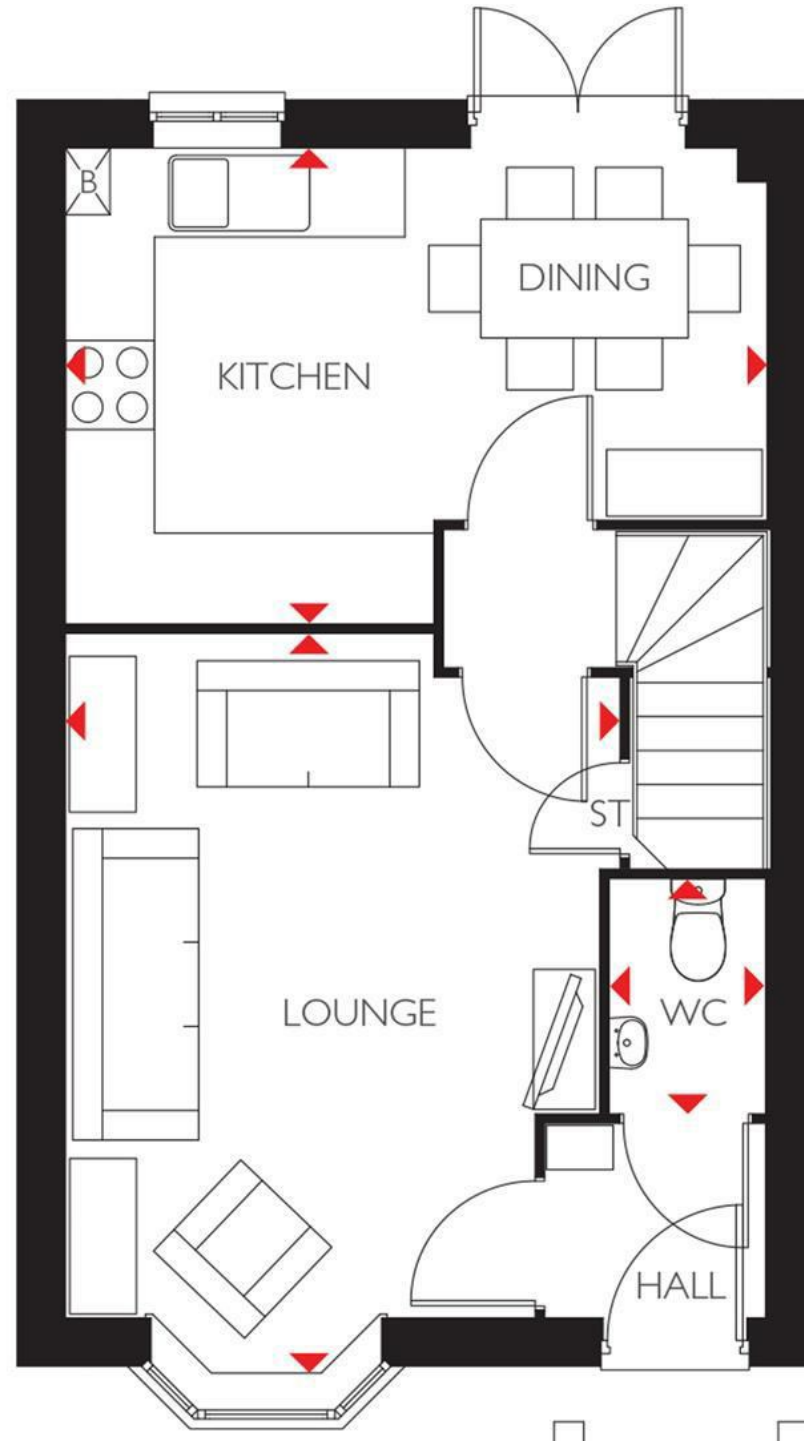

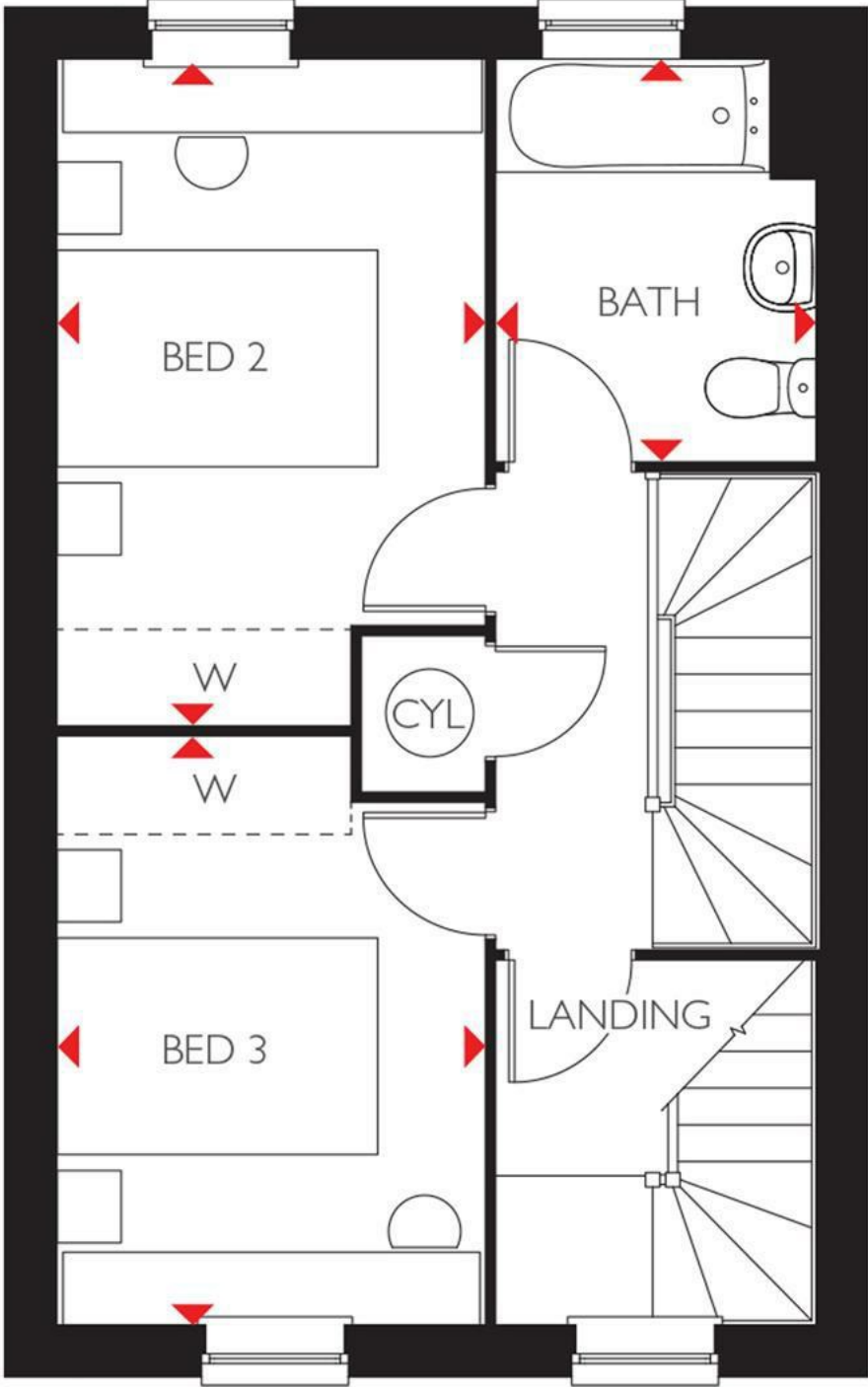

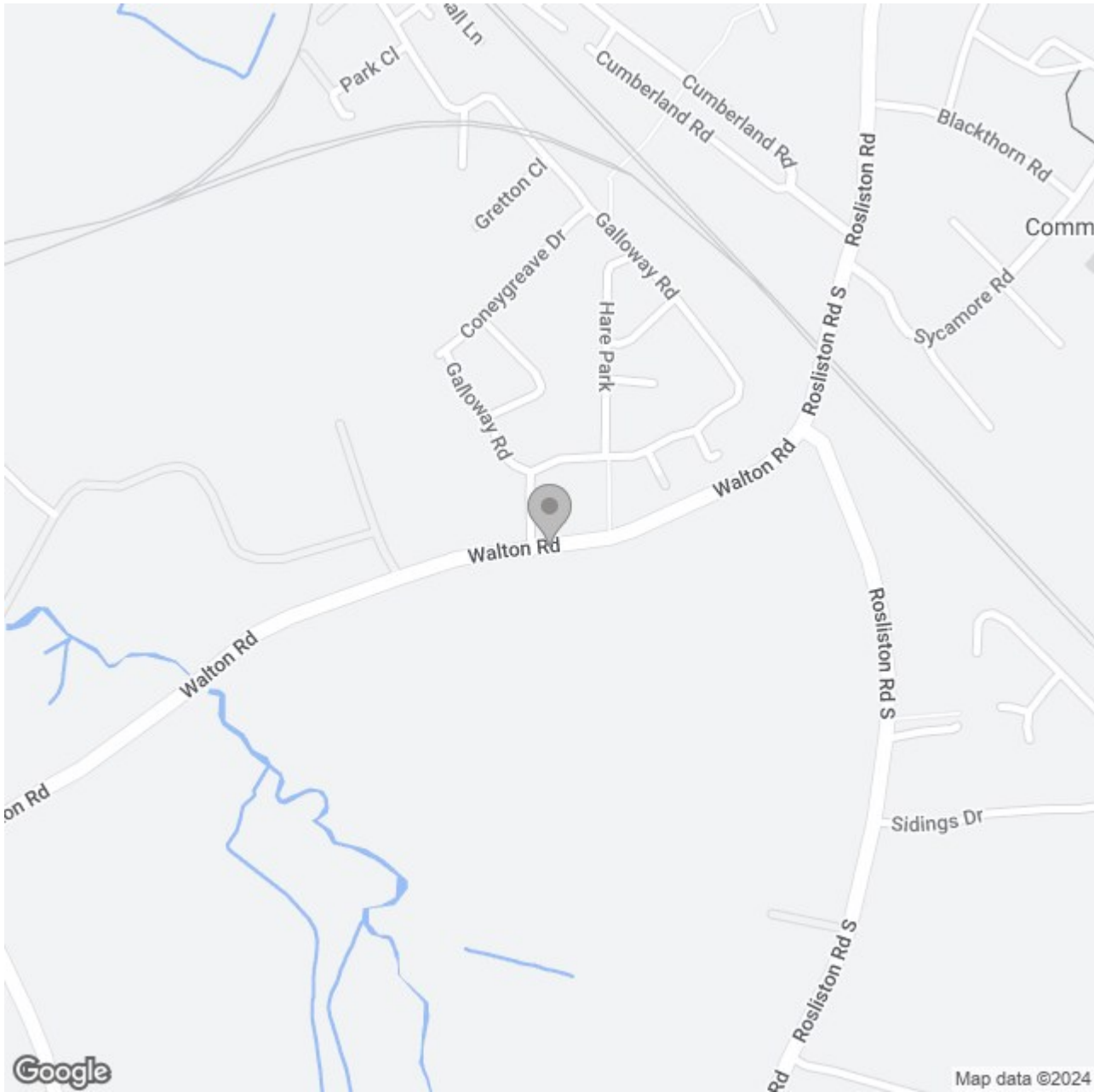

Energy Efficiency Rating

	Current	Potential
<i>Very energy efficient - lower running costs</i>		
(92 plus) A		
(81-91) B		
(69-80) C		
(55-68) D		
(39-54) E		
(21-38) F		
(1-20) G		
<i>Not energy efficient - higher running costs</i>		
England & Wales	EU Directive 2002/91/EC	