



55 Glastonbury Road
Corby, NN18 0DD



Simpson West

Simpson West are delighted to offer to the market for sale this well presented and extended three bedroom residence that is located within the ever popular Beanfield area. The property itself occupies a pleasant position and is within walking distance to the local schools, shops and other amenities. Features include a large porch/entrance hall, fitted kitchen breakfast room, a living room and the extended dining/family room. To the first floor there are two double bedrooms, a good single bedroom and the main family bathroom. Outside there is a low maintenance garden boasting a brand new patio area, this is fully enclosed with a door leading to the single garage. To the front there is an established garden that is enclosed via a low level brick wall. Early viewings are a must! Energy rating D. Council Tax Band A.



£214,950

 3  1  2



Ground Floor



First Floor

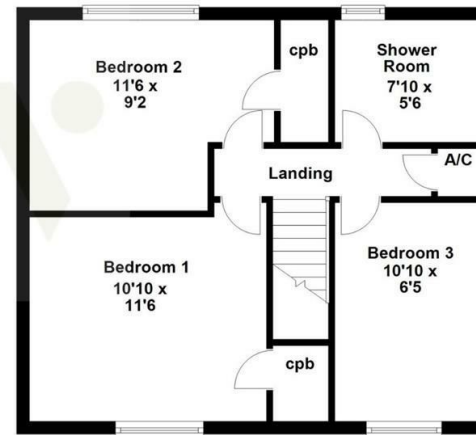

Floor plan not to scale - for guidance purposes only.
Floor plan created by Simpson West for their use.
Plan produced using PlanUp.

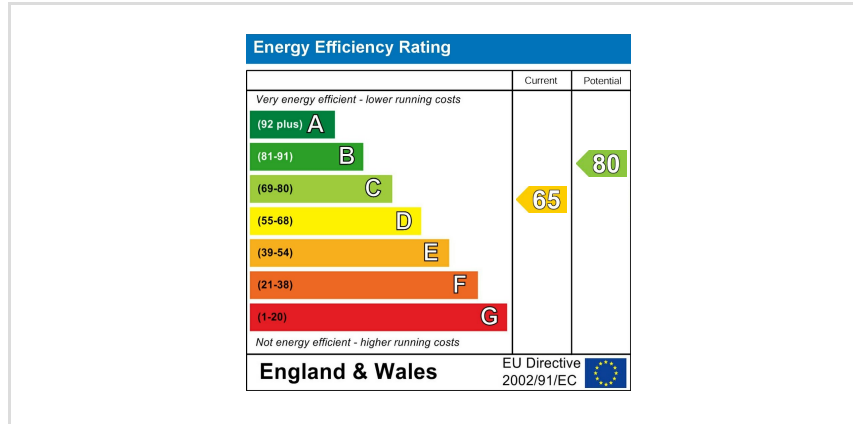

When you buy with Simpson West, you know **you'll be in safe hands**. From the moment you walk through our doors, we'll make you **feel truly welcome**. Our sales consultants and financial advisors will take you through **every step of the process**, offering **free expert advice** along the way, from help choosing the right mortgage and insurance through to finding your conveyancer. And if you need help selling your home too, **with over 20 years of local experience, you can trust us to get you moving**.



**Simpson
West**

Making Every
Journey Personal



01536 202007

info@simpsonwest.co.uk

<https://www.simpsonwest.co.uk/>

64 Corporation Street, Corby, Northants, NN17 1NH