



Courteenhall Drive  
Corby, Northamptonshire

**Simpson  
West**





Simpson West are delighted to bring to the market this imposing semi detached family home which is nestled in this quiet cul de sac on the exclusive Priors Hall Park development. The property benefits from a large kitchen/dining room, master bedroom with dressing area and ensuite, landscaped rear garden, garage and off road parking. Viewings are highly recommended. Energy Rating B.

🛏 4    🚿 2    🚗 2

: £249,950





The spacious accommodation comprises of a superb fitted kitchen/ dining room, lounge, ground floor cloakroom, four double bedrooms with dressing room and ensuite to the master bedroom. Further benefits include sash style double glazing, gas radiator central heating, enclosed garden and a driveway leading to a single garage.



Offices at:

Corby  
01536 722355

Kettering  
01536 518200

Thrapston  
01832 731222

Burton Latimer  
01536 722355

Rushden  
01933 418917

Wellingborough  
01933 224953

Northampton  
01604 590888



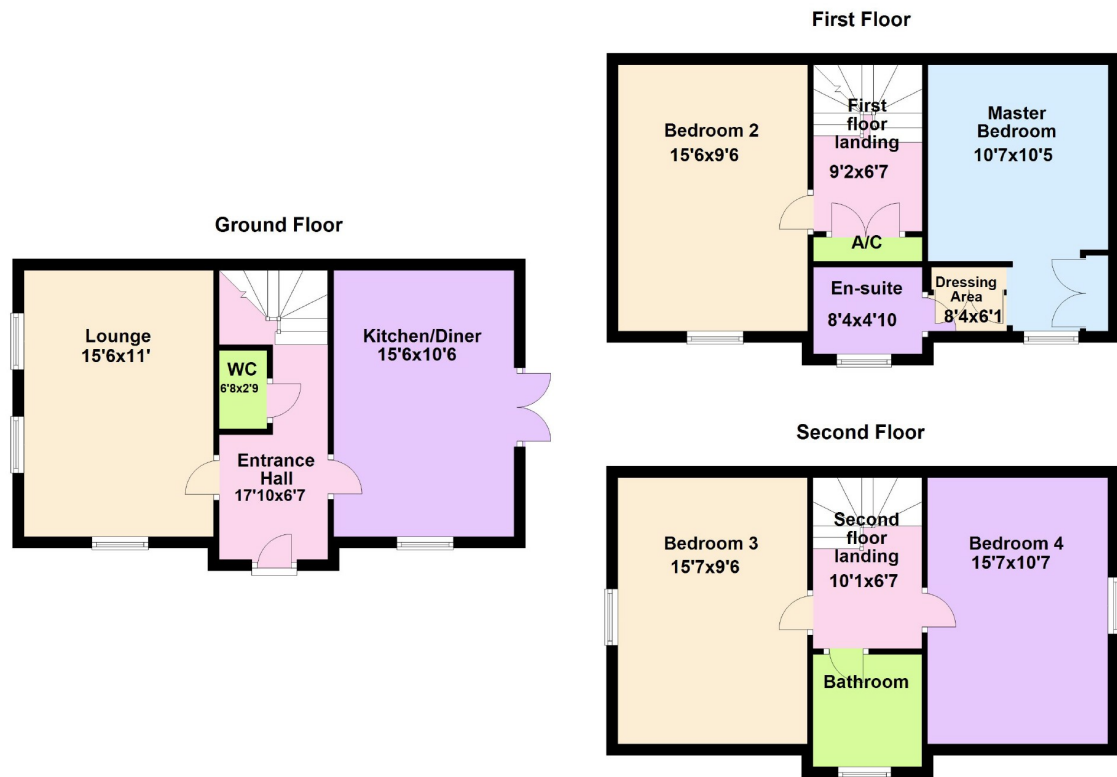

Floor plan not to scale - for guidance purposes only.  
Plan produced using PlanUp.

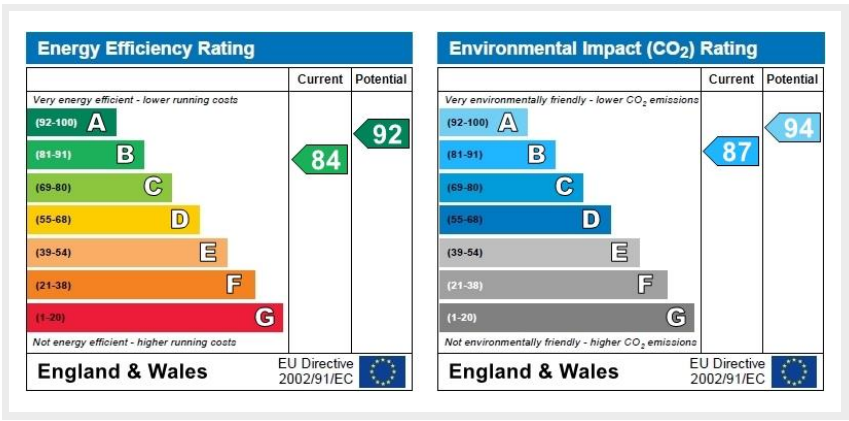

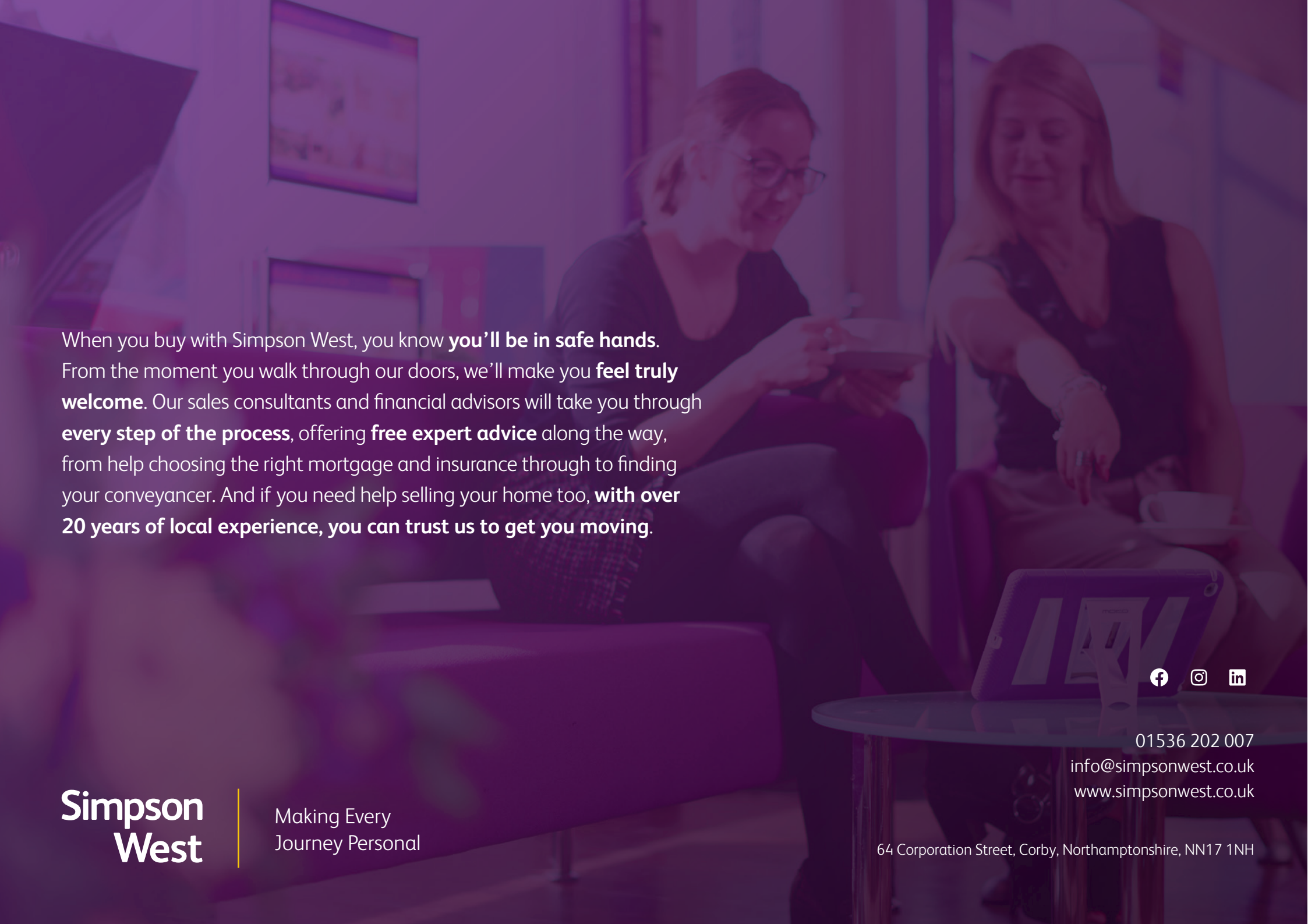

When you buy with Simpson West, you know **you'll be in safe hands**. From the moment you walk through our doors, we'll make you **feel truly welcome**. Our sales consultants and financial advisors will take you through **every step of the process**, offering **free expert advice** along the way, from help choosing the right mortgage and insurance through to finding your conveyancer. And if you need help selling your home too, **with over 20 years of local experience, you can trust us to get you moving**.

**Simpson  
West**

Making Every  
Journey Personal



01536 202 007  
info@simpsonwest.co.uk  
www.simpsonwest.co.uk

64 Corporation Street, Corby, Northamptonshire, NN17 1NH