



24 Jackdaw Road  
Corby, NN18 8RY



**Simpson West**



Occupying an attractive position within this sought after cul-de-sac, located in the popular Oakley Vale area, is this rarely available end terrace property, which is offered for sale in fantastic condition and with NO ONWARD CHAIN.

The accommodation comprises a reception hall, cloakroom/WC, lounge/dining room, and a fitted kitchen/breakfast room with space for freestanding appliances. The first floor provides a family bathroom and THREE BEDROOMS, with the master enjoying en-suite facilities and built-in wardrobes.

Outside, there is an easy maintenance frontage, a driveway providing a SINGLE GARAGE and OFF-ROAD PARKING, located beneath a coach house to the rear of the property. The rear garden is fully enclosed and predominantly laid to lawn, enjoying a private, south-facing position.

The property occupies a pleasant position overlooking a dedicated green space and is within walking distance of local amenities and schools. Viewing is highly recommended to avoid disappointment.

Energy Rating: C. Council Tax Band: C.

£235,000



Ground Floor

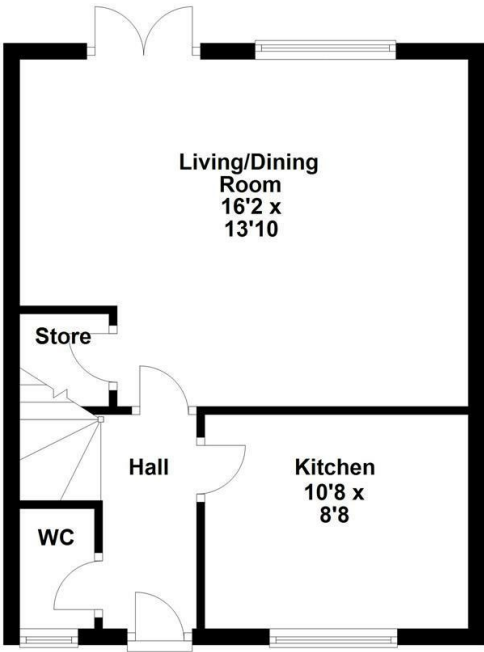

First Floor

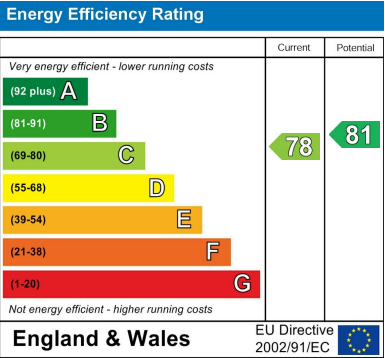
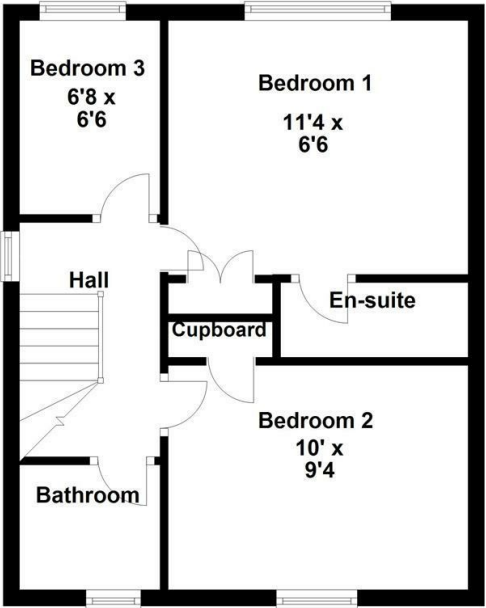



When you buy with Simpson West, you know **you'll be in safe hands**. From the moment you walk through our doors, we'll make you **feel truly welcome**. Our sales consultants and financial advisors will take you through **every step of the process**, offering **free expert advice** along the way, from help choosing the right mortgage and insurance through to finding your conveyancer. And if you need help selling your home too, **with over 20 years of local experience, you can trust us to get you moving**.



**Simpson  
West**

Making Every  
Journey Personal



01536 202007

[info@simpsonwest.co.uk](mailto:info@simpsonwest.co.uk)

<https://www.simpsonwest.co.uk/>

64 Corporation Street, Corby, Northants, NN17 1NH