



15 Water Meadow Close

Corby, NN18 8JD



**Simpson West**



Offered to the market with NO ONWARD CHAIN, this rarely available detached home occupies a highly desirable position within a sought-after cul-de-sac in Great Oakley. Beautifully presented throughout, the property features a welcoming reception hall, cloakroom/WC, spacious living room, separate dining room, and a well-appointed fitted kitchen, utility room and a large conservatory. The first floor offers four bedrooms, with the principal bedroom benefiting from an en-suite shower room and fitted wardrobes, in addition to a refitted family bathroom. Externally, the property enjoys a neat frontage mainly laid to lawn with mature planting, along with a driveway providing off road parking for two vehicles and access to the garage. The south facing rear garden features a patio area leading onto a well-kept lawn and is fully enclosed for privacy. Viewing is strongly recommended to appreciate this exceptional family home.

Energy Rating: C | Council Tax Band: D

£350,000



4



2



2



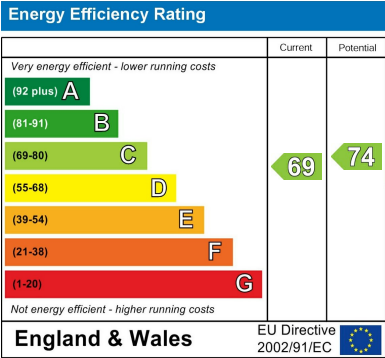
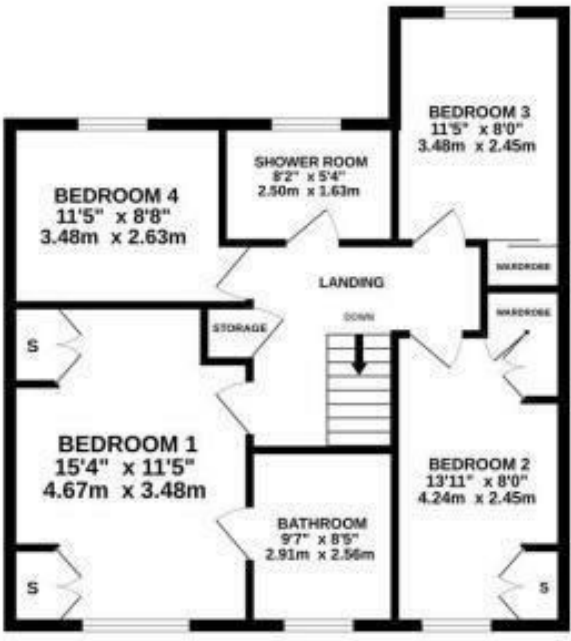
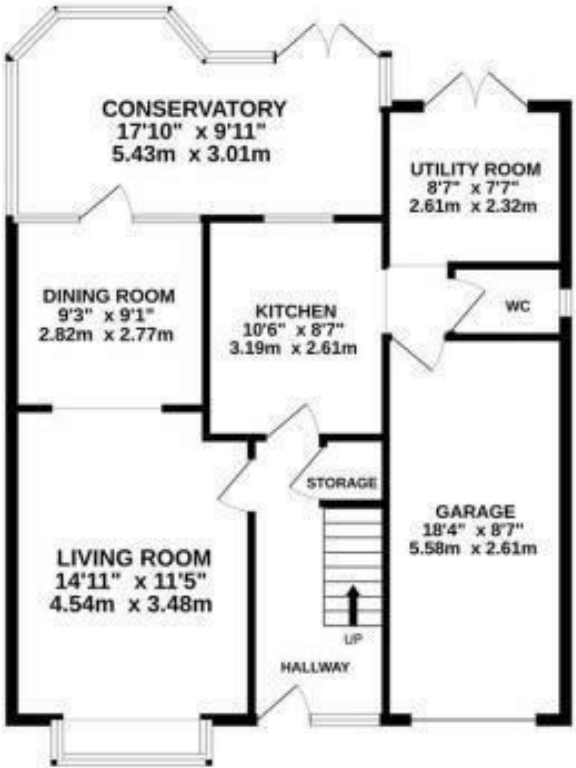



When you buy with Simpson West, you know **you'll be in safe hands**. From the moment you walk through our doors, we'll make you **feel truly welcome**. Our sales consultants and financial advisors will take you through **every step of the process**, offering **free expert advice** along the way, from help choosing the right mortgage and insurance through to finding your conveyancer. And if you need help selling your home too, **with over 20 years of local experience, you can trust us to get you moving**.



**Simpson  
West**

Making Every  
Journey Personal



01536 202007

[info@simpsonwest.co.uk](mailto:info@simpsonwest.co.uk)

<https://www.simpsonwest.co.uk/>

64 Corporation Street, Corby, Northants, NN17 1NH