



118 Stephenson Way
Corby, NN17 1DE



Simpson West

Located in the highly popular Lloyds area of Corby, this well presented two bedroom semi-detached home offers a fantastic opportunity for first-time buyers or investors alike. Boasting a spacious conservatory, off-street parking, and a substantial rear garden, the property provides plenty of scope to extend (subject to planning permission). The property benefits generously sized and private rear garden, fully enclosed on all sides with various areas of lawn and patio. Internally, the property offers a bright and welcoming layout, including lounge, kitchen, and a light-filled conservatory with patio doors opening onto the rear garden. Upstairs are two well-proportioned bedrooms and a family bathroom. Perfectly positioned within easy reach of local amenities, shops, and well-regarded schools, this home also benefits from excellent transport links and nearby green spaces. Early viewings are essential to avoid disappointment. EPC rating D. Council tax band B.

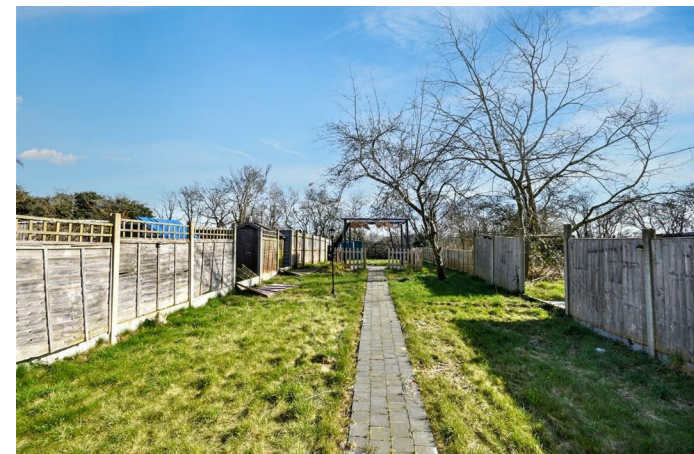

£175,000

2 1 2



Ground Floor



First Floor

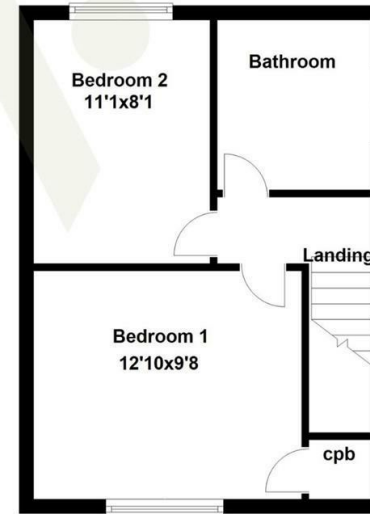

Energy Efficiency Rating		
	Current	Potential
<i>Very energy efficient - lower running costs</i>		
(92 plus) A		
(81-91) B		88
(69-80) C		
(55-68) D	59	
(39-54) E		
(21-38) F		
(1-20) G		
<i>Not energy efficient - higher running costs</i>		
England & Wales	EU Directive 2002/91/EC	



When you buy with Simpson West, you know **you'll be in safe hands**. From the moment you walk through our doors, we'll make you **feel truly welcome**. Our sales consultants and financial advisors will take you through **every step of the process**, offering **free expert advice** along the way, from help choosing the right mortgage and insurance through to finding your conveyancer. And if you need help selling your home too, **with over 20 years of local experience, you can trust us to get you moving**.



**Simpson
West**

Making Every
Journey Personal



01536 202007

info@simpsonwest.co.uk

<https://www.simpsonwest.co.uk/>

64 Corporation Street, Corby, Northants, NN17 1NH