



4 Fieldfare Close  
Corby, Northants NN18 8FF



**Simpson West**



Nestled away within a private cul-de-sac on the popular Oakley Vale area is this well presented TWO bedroom detached coach house that is being offered to the market for sale with no onward chain. This home occupies a pleasant position and is within walking distance to the local schools, shops and other amenities. Features include a large living dining room, a modern fitted kitchen, two double bedrooms with the master benefitting from fitted wardrobes, in addition there is the main family bathroom. There is off road parking to the front leading to a single integral garage. Early viewings are highly encouraged. Energy rating to be confirmed.

£179,000



2



1



1



Simpson West

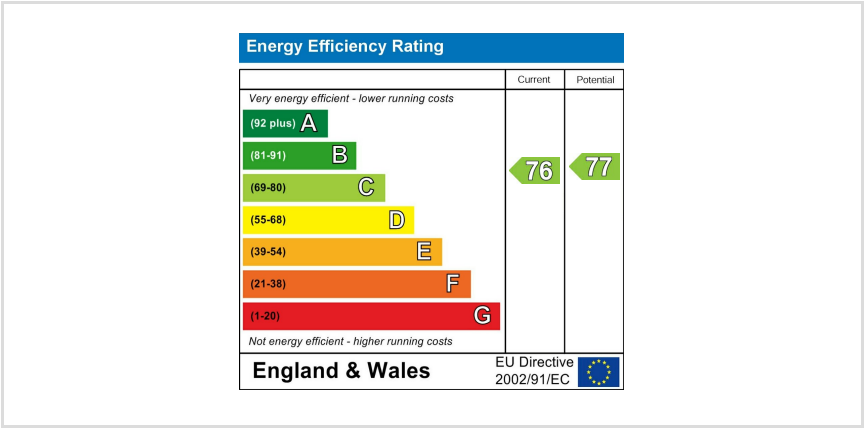
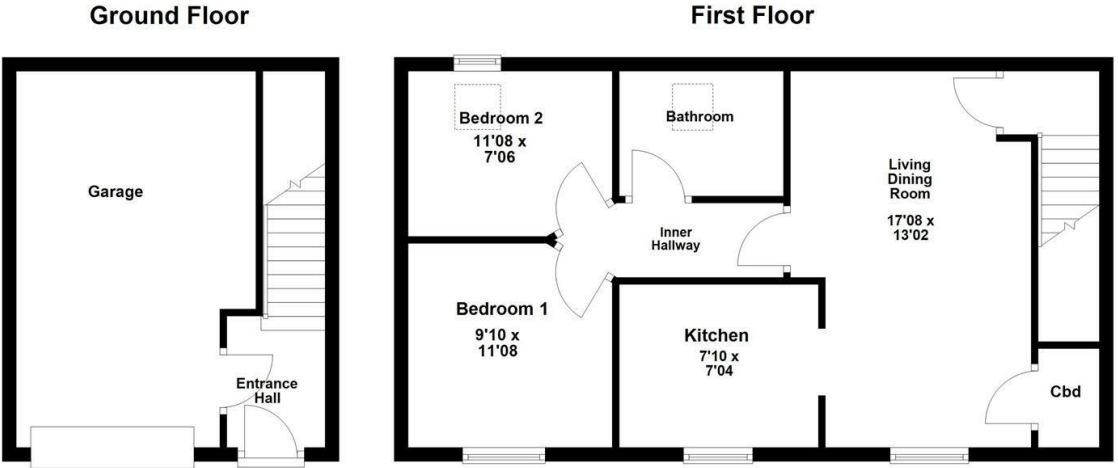



When you buy with Simpson West, you know **you'll be in safe hands**. From the moment you walk through our doors, we'll make you **feel truly welcome**. Our sales consultants and financial advisors will take you through **every step of the process**, offering **free expert advice** along the way, from help choosing the right mortgage and insurance through to finding your conveyancer. And if you need help selling your home too, **with over 20 years of local experience, you can trust us to get you moving**.



**Simpson  
West**

Making Every  
Journey Personal



01536 202007

[info@simpsonwest.co.uk](mailto:info@simpsonwest.co.uk)

<https://www.simpsonwest.co.uk/>

64 Corporation Street, Corby, Northants, NN17 1NH