



38 Gilchrist Avenue
Corby, Northants NN17 1BA



Simpson West

Occupying a pleasant position within the highly popular Lloyds area is this well presented TWO double bedroom semi detached residence that is being offered to the market for sale with no onward chain. The property itself occupies a pleasant position and is within walking distance to the local schools, shops and other amenities. Features include an entrance hall, fitted kitchen, bathroom and large living dining room. To the first floor there are two double bedrooms. Outside there is a large garden that is fully enclosed and is mainly laid to lawn. To the front there is scope for off road parking subject to planning consent for a dropped kerb. Early viewings are a must. Energy rating to be confirmed

£185,000



2



1



1



Simpson West

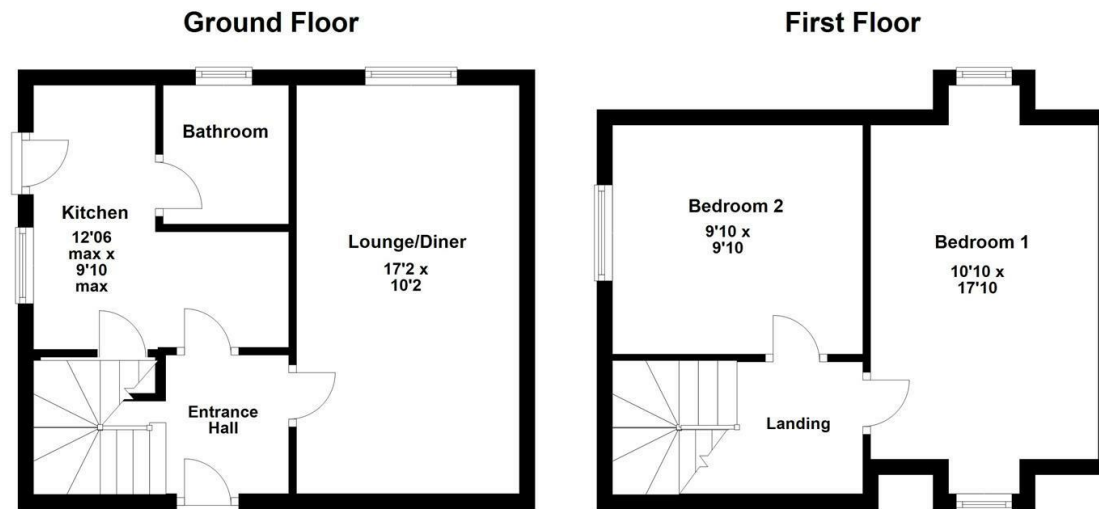

Floor plan not to scale - for guidance purposes only.
 Floor plan created by Simpson West for their use.
 Plan produced using PlanUp.

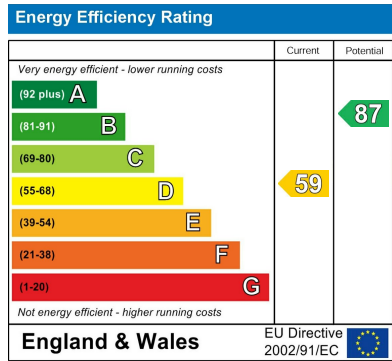

When you buy with Simpson West, you know **you'll be in safe hands**. From the moment you walk through our doors, we'll make you **feel truly welcome**. Our sales consultants and financial advisors will take you through **every step of the process**, offering **free expert advice** along the way, from help choosing the right mortgage and insurance through to finding your conveyancer. And if you need help selling your home too, **with over 20 years of local experience, you can trust us to get you moving**.



**Simpson
West**

Making Every
Journey Personal



01536 202007

info@simpsonwest.co.uk

<https://www.simpsonwest.co.uk/>

64 Corporation Street, Corby, Northants, NN17 1NH