



26 Greeve Close
Corby, NN18 8LW



Simpson West

Occupying a highly attractive cul-de-sac position within the highly desirable Great Oakley area, is this detached bungalow which is being offered for sale with NO CHAIN. Features and accommodation include gas central heating and double-glazed windows and doors, and a reception hall provides access to a highly spacious living room, conservatory, fitted kitchen/breakfast room with integrated appliances, TWO BEDROOMS with both benefit from fitted wardrobes, and there is also a bathroom. Outside, there is an attractive open plan frontage with a driveway set to one side which provides OFF ROAD PARKING for two vehicles and leads to the GARAGE which boasts an electric garage door. The rear garden has been designed with easy maintenance in mind and is of good size.

An early visit is highly recommended!

Energy Rating C. Council Tax Band C.

£259,950



Simpson West

Ground Floor

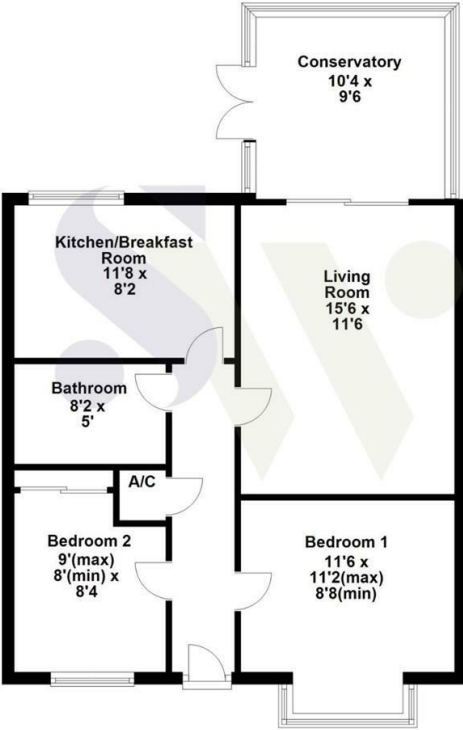

Floor plan not to scale - for guidance purposes only.
Floor plan created by Simpson West for their use.
Plan produced using PlanUp.



Energy Efficiency Rating		
	Current	Potential
Very energy efficient - lower running costs		
(92 plus) A		89
(81-91) B		
(69-80) C	72	
(55-68) D		
(39-54) E		
(21-38) F		
(1-20) G		
Not energy efficient - higher running costs		
England & Wales	EU Directive 2002/91/EC	



When you buy with Simpson West, you know **you'll be in safe hands**. From the moment you walk through our doors, we'll make you **feel truly welcome**. Our sales consultants and financial advisors will take you through **every step of the process**, offering **free expert advice** along the way, from help choosing the right mortgage and insurance through to finding your conveyancer. And if you need help selling your home too, **with over 20 years of local experience, you can trust us to get you moving**.



**Simpson
West**

Making Every
Journey Personal



01536 202007

info@simpsonwest.co.uk

<https://www.simpsonwest.co.uk/>

64 Corporation Street, Corby, Northants, NN17 1NH