



35 Lapwing Close

Corby, Northamptonshire NN18 8DJ



Simpson West

Simpson West Lettings are delighted to offer to let this rarely available town house occupying an attractive position within the sought after Oakley Vale area. Having just been redecorated throughout features and accommodation include double glazing, gas radiator central heating, cloakroom/WC, living room, a refitted kitchen with integrated appliances, two bedrooms and a bathroom. Outside there is an easy maintenance frontage with allocated parking for one vehicle. There is also a good size lawned garden with patio. Viewing is simply a must! Energy Rating C. Council tax band B.



£950 PCM

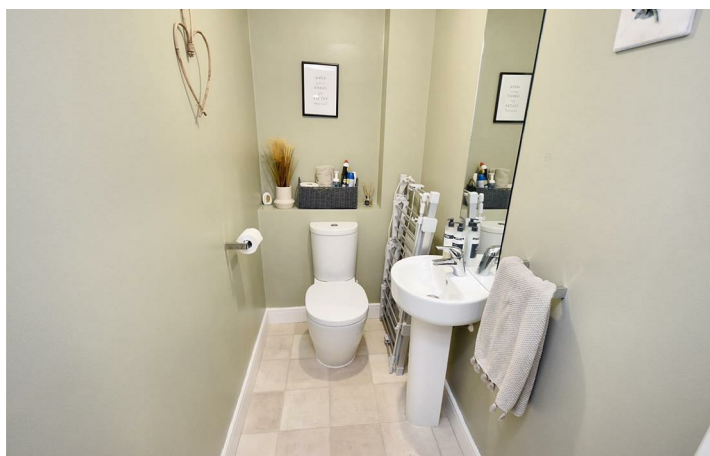

Ground Floor

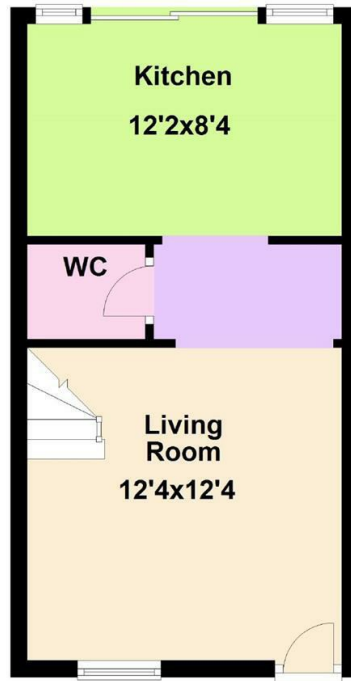

First Floor

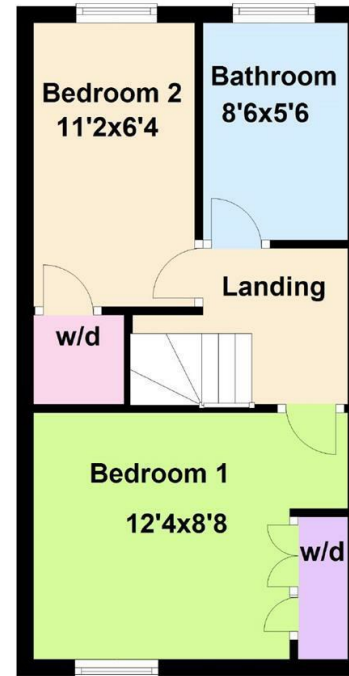

Floor plan not to scale - for guidance purposes only.
Plan produced using PlanUp.

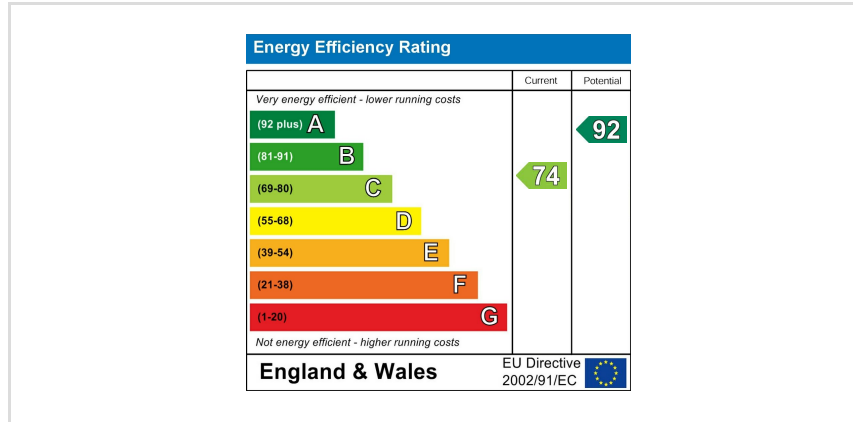

When you buy with Simpson West, you know **you'll be in safe hands**. From the moment you walk through our doors, we'll make you **feel truly welcome**. Our sales consultants and financial advisors will take you through **every step of the process**, offering **free expert advice** along the way, from help choosing the right mortgage and insurance through to finding your conveyancer. And if you need help selling your home too, **with over 20 years of local experience, you can trust us to get you moving**.



**Simpson
West**

Making Every
Journey Personal



01536 202007

info@simpsonwest.co.uk

<https://www.simpsonwest.co.uk/>

64 Corporation Street, Corby, Northants, NN17 1NH