



13 Wentworth Drive
Corby, Northants NN17 5AQ



Simpson West

Simpson West Lettings are delighted to offer for rent this well presented two bedroom semi detached house which is situated on the highly sought after Lodge Park development of Priors Hall Park. The property has many features throughout and proudly boasts entrance hall, downstairs WC, kitchen and a lounge/diner with patio doors leading to the garden. Upstairs there is a master bedroom with an en suite shower room, a further double bedroom and a family bathroom. Outside there is a fully enclosed rear garden and a driveway providing off road parking. Viewing is highly recommended. Energy Rating A. Council Tax Band B.



£950 PCM

 2  2  1

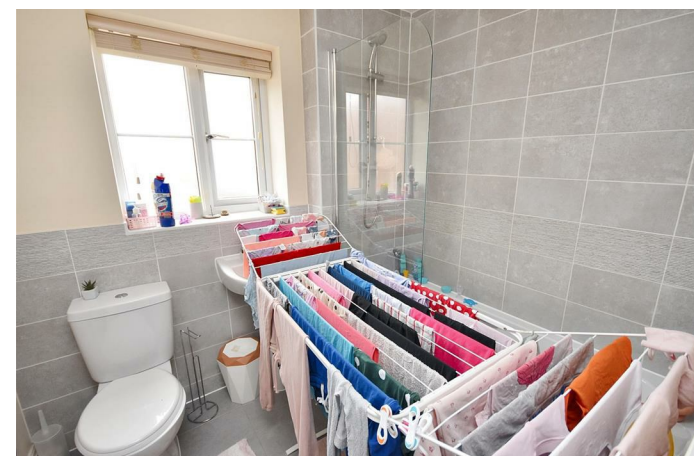

Ground Floor

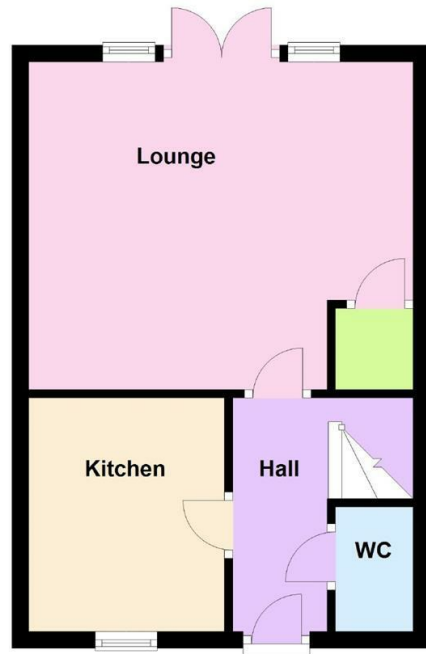

First Floor

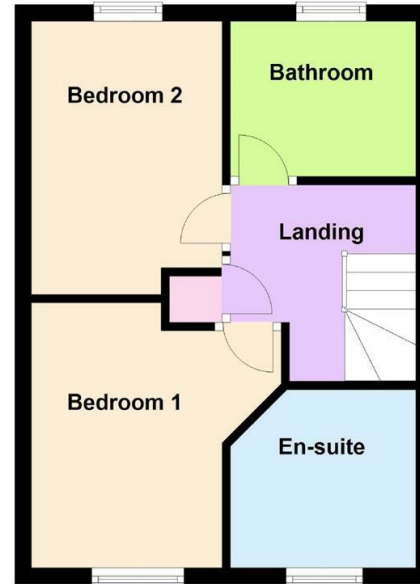

Floor plan not to scale - for guidance purposes only.
Plan produced using PlanUp.



Energy Efficiency Rating		
	Current	Potential
Very energy efficient - lower running costs		
(92 plus) A	93	94
(81-91) B		
(69-80) C		
(55-68) D		
(39-54) E		
(21-38) F		
(1-20) G		
Not energy efficient - higher running costs		
England & Wales	EU Directive 2002/91/EC	



When you buy with Simpson West, you know **you'll be in safe hands**. From the moment you walk through our doors, we'll make you **feel truly welcome**. Our sales consultants and financial advisors will take you through **every step of the process**, offering **free expert advice** along the way, from help choosing the right mortgage and insurance through to finding your conveyancer. And if you need help selling your home too, **with over 20 years of local experience, you can trust us to get you moving**.



**Simpson
West**

Making Every
Journey Personal



01536 202007

info@simpsonwest.co.uk

<https://www.simpsonwest.co.uk/>

64 Corporation Street, Corby, Northants, NN17 1NH