



22 Carltonwood Close
Corby, Northamptonshire NN18 9FP



Simpson West

Simpson West are delighted to offer to the market for sale this modern two bedroom semi detached residence that is nestled away within a quiet cul-de-sac on the popular Danesholme. The property itself is well located being within walking distance to the local school, shops and other amenities. Features include an entrance hall, cloakroom w/c, a modern fitted kitchen breakfast room and the living dining room. To the first floor there are two large double bedrooms and the main family bathroom. To the rear is an enclosed garden with gated access to the rear. There is a double length drive that is positioned to the rear of the garden. Early viewings are a must. Energy rating to be confirmed. Council Tax Band B.



£184,950



Ground Floor

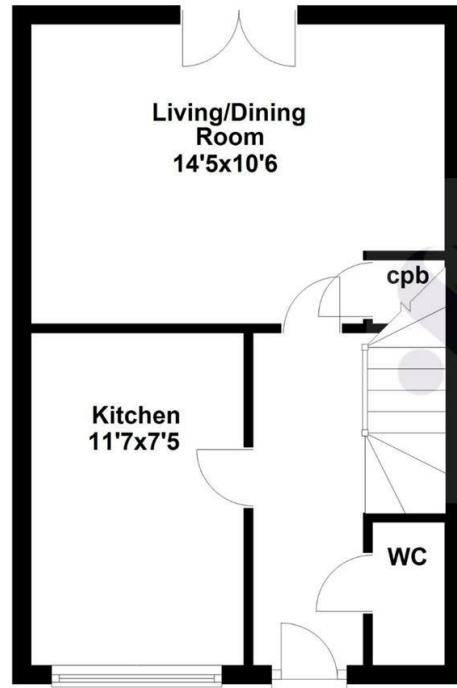

First Floor

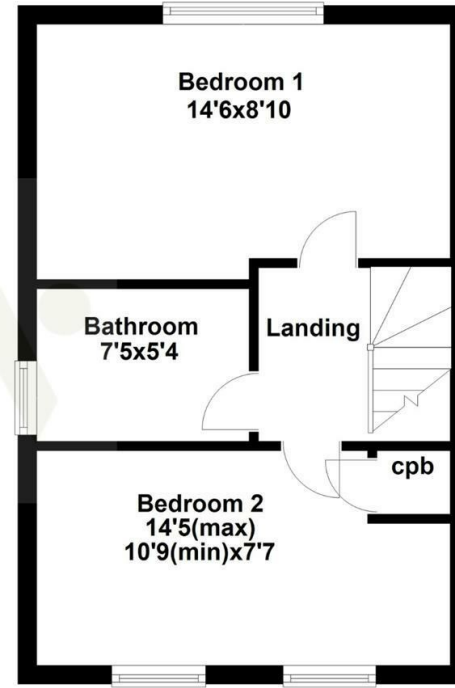

Floor plan not to scale - for guidance purposes only.
Plan produced using PlanUp.



Energy Efficiency Rating

	Current	Potential
<i>Very energy efficient - lower running costs</i>		
(92 plus) A		
(81-91) B		
(69-80) C		
(55-68) D		
(39-54) E		
(21-38) F		
(1-20) G		
<i>Not energy efficient - higher running costs</i>		
England & Wales	EU Directive 2002/91/EC 	



When you buy with Simpson West, you know **you'll be in safe hands**. From the moment you walk through our doors, we'll make you **feel truly welcome**. Our sales consultants and financial advisors will take you through **every step of the process**, offering **free expert advice** along the way, from help choosing the right mortgage and insurance through to finding your conveyancer. And if you need help selling your home too, **with over 20 years of local experience, you can trust us to get you moving**.



**Simpson
West**

Making Every
Journey Personal



01536 202007

info@simpsonwest.co.uk

<https://www.simpsonwest.co.uk/>

64 Corporation Street, Corby, Northants, NN17 1NH