



24 Ashdown Place

Corby, Northamptonshire NN17 1FH



Simpson West

Simpson West Lettings are delighted to offer for rent this rarely available first floor studio apartment which is ideally situated in the Lloyds area of Corby. This property proudly boasts open plan living space with fitted kitchen and a bathroom. This property is located within easy access to Corby Town Centre and all local amenities. Viewing is highly recommended. Energy Rating C. Council Tax Band A.

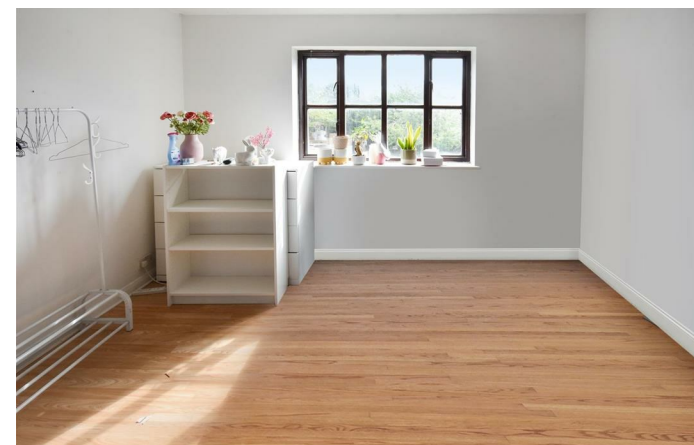

£650 PCM

1

1

nul



Ground Floor

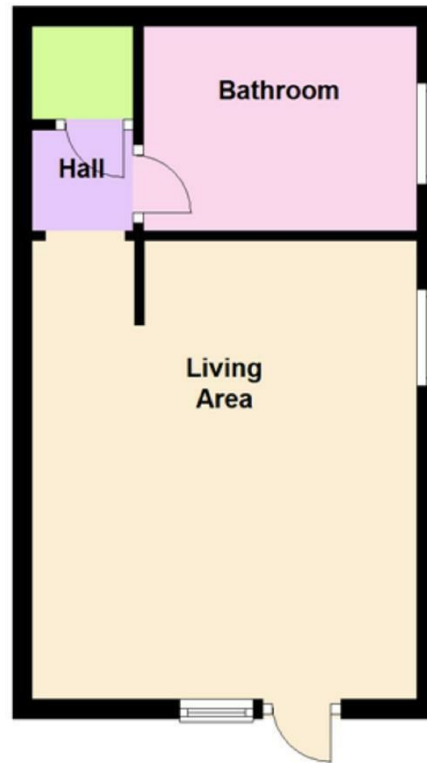

Floor plan not to scale - for guidance purposes only

Energy Efficiency Rating

	Current	Potential
<i>Very energy efficient - lower running costs</i>		
(92 plus) A		
(81-91) B		
(69-80) C	72	77
(55-68) D		
(39-54) E		
(21-38) F		
(1-20) G		
<i>Not energy efficient - higher running costs</i>		
England & Wales	EU Directive 2002/91/EC 	

When you buy with Simpson West, you know **you'll be in safe hands**. From the moment you walk through our doors, we'll make you **feel truly welcome**. Our sales consultants and financial advisors will take you through **every step of the process**, offering **free expert advice** along the way, from help choosing the right mortgage and insurance through to finding your conveyancer. And if you need help selling your home too, **with over 20 years of local experience, you can trust us to get you moving**.



**Simpson
West**

Making Every
Journey Personal



01536 202007

info@simpsonwest.co.uk

<https://www.simpsonwest.co.uk/>

64 Corporation Street, Corby, Northants, NN17 1NH