



18 Clwyd Walk

Corby, Northamptonshire NN17 2LN



**Simpson West**

Simpson West are delighted to offer to the market for sale with no onward chain this extended THREE bedroom family residence located within the popular Shire part of Corby. The property itself is well positioned being within walking distance to the local school as well as other amenities. Features include an extended porch, hall, a large extended kitchen dining room and the living room with patio doors leading to the rear garden. To the first floor there are two double bedrooms, a good sized third single and the main family bathroom. Early viewings are highly advised. Energy rating C. Council Tax Band A.



£205,000

3 1 1



**Ground Floor**

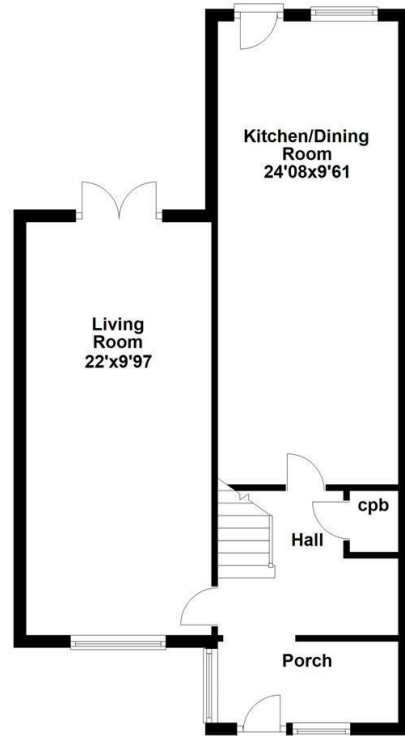

**First Floor**

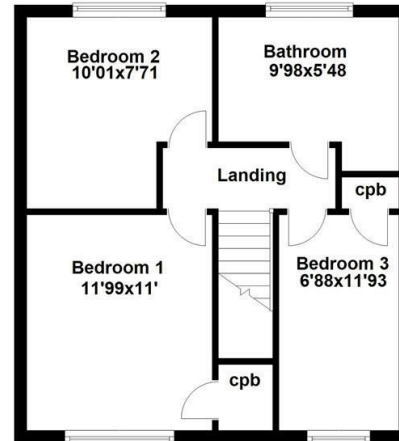

Floor plan not to scale - for guidance purposes only.  
Plan produced using PlanUp.

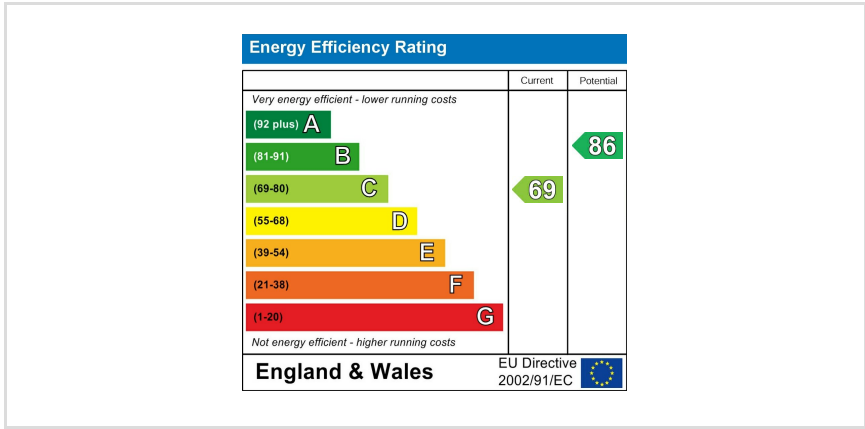

When you buy with Simpson West, you know **you'll be in safe hands**. From the moment you walk through our doors, we'll make you **feel truly welcome**. Our sales consultants and financial advisors will take you through **every step of the process**, offering **free expert advice** along the way, from help choosing the right mortgage and insurance through to finding your conveyancer. And if you need help selling your home too, **with over 20 years of local experience, you can trust us to get you moving**.



**Simpson  
West**

Making Every  
Journey Personal



01536 202007

[info@simpsonwest.co.uk](mailto:info@simpsonwest.co.uk)

<https://www.simpsonwest.co.uk/>

64 Corporation Street, Corby, Northants, NN17 1NH