



8 Goodwood Close
Corby, NN18 8QS



Simpson West

Simpson West Lettings are delighted to offer to let this three-bedroom family home located in a quiet cul-de-sac on the popular Oakley Vale estate. The property comprises of entrance hall leading to the kitchen, lounge/diner with patio doors leading to the garden, and a W/C. Upstairs there is a master bedroom with en-suite, a family bathroom, a second double bedroom and a further single bedroom. Outside there is a good sized garden laid to lawn and off road parking for one vehicle. Energy rating C. Council tax band C.



£950 Per Calendar Month

 3  2  nul



Ground Floor

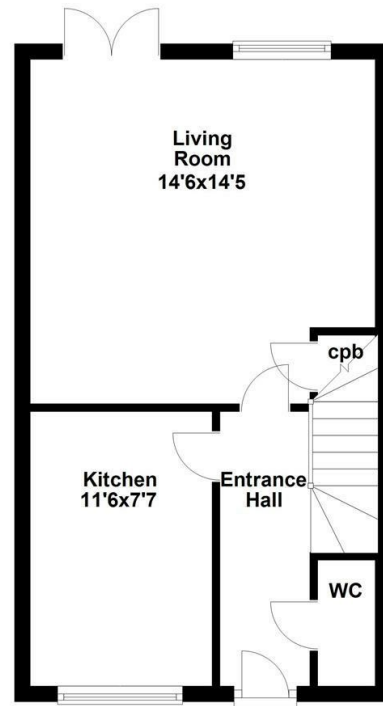

First Floor

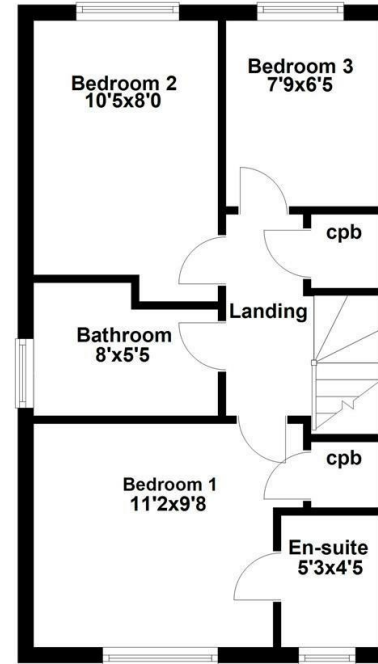

Floor plan not to scale - for guidance purposes only.
Plan produced using PlanUp.



Energy Efficiency Rating		
	Current	Potential
<i>Very energy efficient - lower running costs</i>		
(92 plus) A		
(81-91) B		
(69-80) C		
(55-68) D		
(39-54) E		
(21-38) F		
(1-20) G		
<i>Not energy efficient - higher running costs</i>		
England & Wales	EU Directive 2002/91/EC	



When you buy with Simpson West, you know **you'll be in safe hands**. From the moment you walk through our doors, we'll make you **feel truly welcome**. Our sales consultants and financial advisors will take you through **every step of the process**, offering **free expert advice** along the way, from help choosing the right mortgage and insurance through to finding your conveyancer. And if you need help selling your home too, **with over 20 years of local experience, you can trust us to get you moving**.



**Simpson
West**

Making Every
Journey Personal



01536 202007

info@simpsonwest.co.uk

<https://www.simpsonwest.co.uk/>

64 Corporation Street, Corby, Northants, NN17 1NH