



27 Samuel Place
Corby, Northants NN17 1BQ



Simpson West

Simpson West Lettings are delighted to offer to the rental market this immaculately presented two bedroom end of terrace house situated on the Lloyds area. The property comprises entrance hall, open plan fitted kitchen/ lounge with appliances included. The lounge/diner provides patio doors leading into rear garden. Upstairs there are two bedrooms both with fitted wardrobes and family bathroom with an electric shower over the bath. Energy Rating TBC. Council Tax Band A.



£900 PCM

2 1 1



Ground Floor

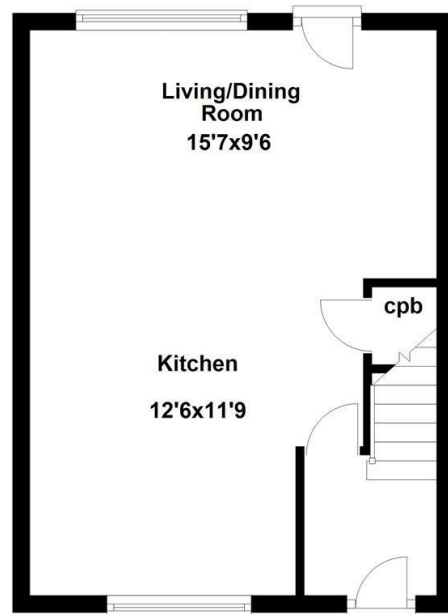

First Floor

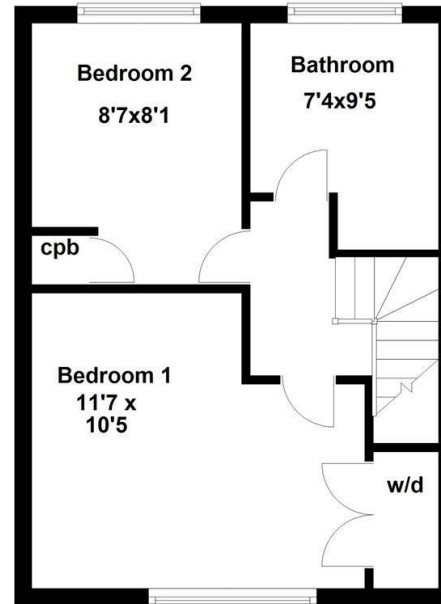

Floor plan not to scale - for guidance purposes only.
Floor plan created by Simpson West for their use.
Plan produced using PlanUp.

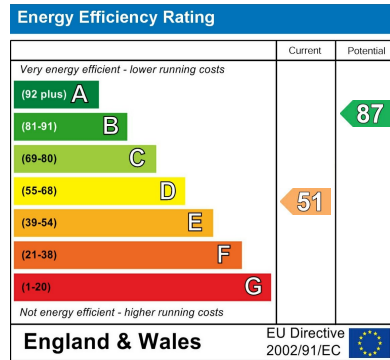

When you buy with Simpson West, you know **you'll be in safe hands**. From the moment you walk through our doors, we'll make you **feel truly welcome**. Our sales consultants and financial advisors will take you through **every step of the process**, offering **free expert advice** along the way, from help choosing the right mortgage and insurance through to finding your conveyancer. And if you need help selling your home too, **with over 20 years of local experience, you can trust us to get you moving**.



**Simpson
West**

Making Every
Journey Personal



01536 202007

info@simpsonwest.co.uk

<https://www.simpsonwest.co.uk/>

64 Corporation Street, Corby, Northants, NN17 1NH