



129 Butland Road

Corby, Northamptonshire NN18 8FN



Simpson West

Simpson West Lettings are delighted to offer for rent this three bedroom house which is situated in the highly sought after Oakley Vale area of Corby close to local schools and amenities. The property proudly boasts entrance hall, WC, lounge and a kitchen/diner with patio doors leading to the rear garden. Upstairs there is a master bedroom with fitted wardrobes and an en suite shower room, a second double bedroom with some fitted furniture, a third single bedroom also with storage and a family bathroom. Outside there is a good size rear garden, off road parking and a garage. Energy Rating TBC. Council Tax Band C.



£1,100 PCM

 3  2  1



Ground Floor

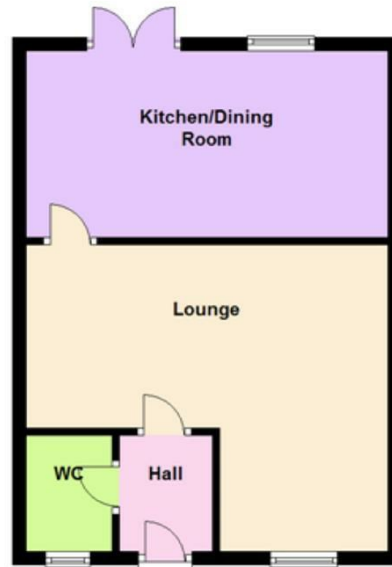

First Floor



Energy Efficiency Rating

	Current	Potential
<i>Very energy efficient - lower running costs</i>		
(92 plus) A		90
(81-91) B	77	
(69-80) C		
(55-68) D		
(39-54) E		
(21-38) F		
(1-20) G		
<i>Not energy efficient - higher running costs</i>		
England & Wales	EU Directive 2002/91/EC	



When you buy with Simpson West, you know **you'll be in safe hands**. From the moment you walk through our doors, we'll make you **feel truly welcome**. Our sales consultants and financial advisors will take you through **every step of the process**, offering **free expert advice** along the way, from help choosing the right mortgage and insurance through to finding your conveyancer. And if you need help selling your home too, **with over 20 years of local experience, you can trust us to get you moving**.



**Simpson
West**

Making Every
Journey Personal



01536 202007

info@simpsonwest.co.uk

<https://www.simpsonwest.co.uk/>

64 Corporation Street, Corby, Northants, NN17 1NH