



39 Spinney Road

Weldon, Northamptonshire NN17 3JZ



Simpson West

Enjoying a cul-de-sac position within the sought after village of Weldon, is this semi-detached bungalow which is presented in good condition throughout and offers accommodation to include a reception hall, living room, fitted kitchen, TWO BEDROOMS and bathroom. There are easy maintenance gardens set to the front and rear with the rear gardens providing a good degree of privacy. Viewing is highly recommended if the property's condition and setting are to be fully appreciated!
Energy Rating D. Council Tax Band B.

£185,000



Ground Floor

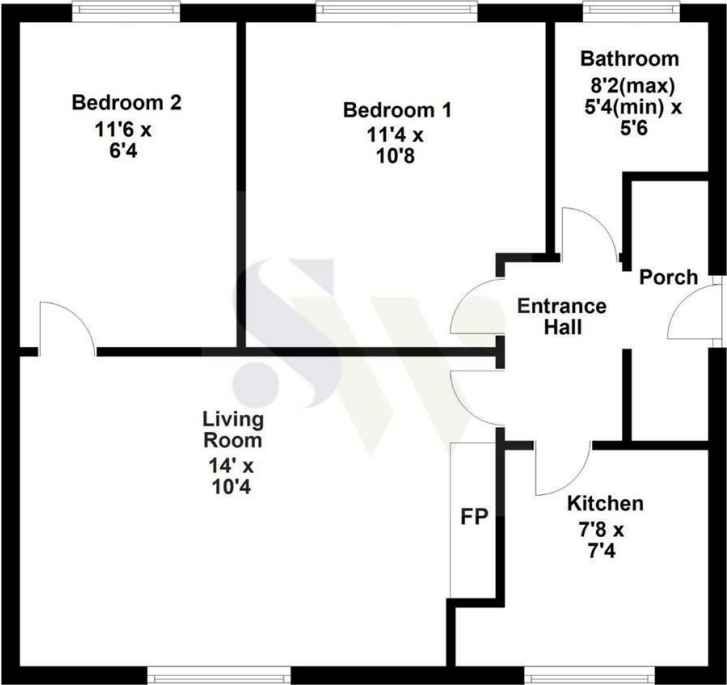

Floor plan not to scale - for guidance purposes only.
Floor plan created by Simpson West for their use.
Plan produced using PlanUp.



Energy Efficiency Rating		
	Current	Potential
Very energy efficient - lower running costs		
(92 plus) A		86
(81-91) B		
(69-80) C		
(55-68) D	62	
(39-54) E		
(21-38) F		
(1-20) G		
Not energy efficient - higher running costs		
England & Wales		EU Directive 2002/91/EC



When you buy with Simpson West, you know **you'll be in safe hands**. From the moment you walk through our doors, we'll make you **feel truly welcome**. Our sales consultants and financial advisors will take you through **every step of the process**, offering **free expert advice** along the way, from help choosing the right mortgage and insurance through to finding your conveyancer. And if you need help selling your home too, **with over 20 years of local experience, you can trust us to get you moving**.



**Simpson
West**

Making Every
Journey Personal



01536 202007

info@simpsonwest.co.uk

<https://www.simpsonwest.co.uk/>

64 Corporation Street, Corby, Northants, NN17 1NH