



27a Rochester Road
Corby, NN18 8PN



Simpson West

Enjoying an attractive position within the popular Oakley Vale area, is this rarely available semi-detached property which is presented in excellent condition throughout. Features and accommodation include double glazing, gas radiator central heating, a reception porch, cloakroom/WC, living room, and a kitchen/dining room with integrated appliances. To the first floor there are TWO DOUBLE BEDROOMS and bathroom. Outside, there is an attractive open plan, well maintained frontage, with lawned gardens set to the rear complimented by two good sized decked patio areas. A driveway provides OFF ROAD PARKING to the side of the property for two vehicles. Viewing is highly recommended if both the property's setting and condition are to be fully appreciated! Energy Rating C. Council Tax Band B.



£209,950

2 1 1

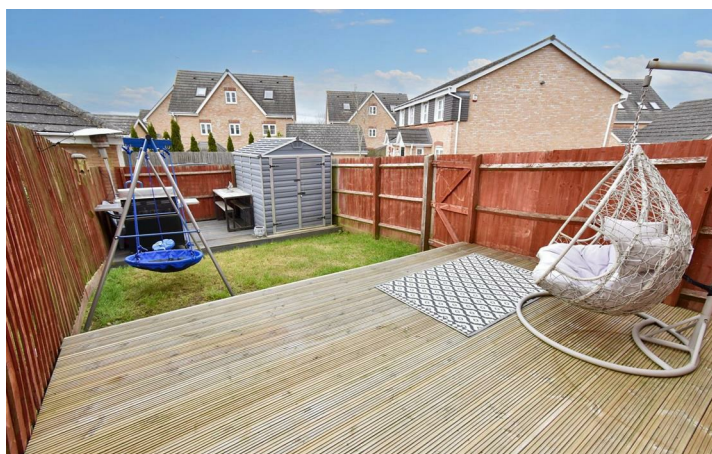
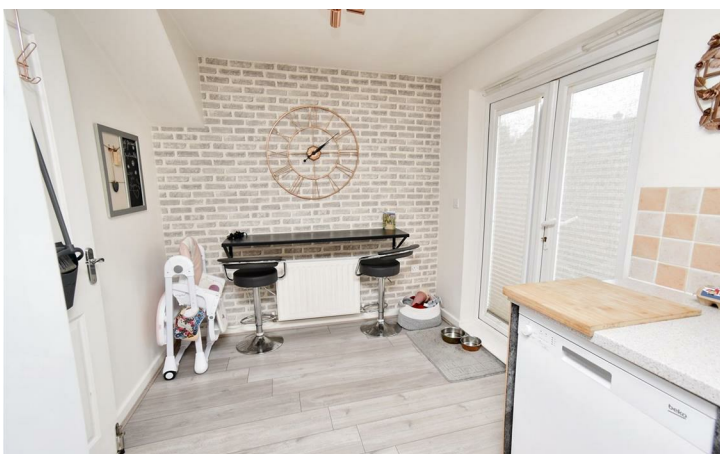

Ground Floor

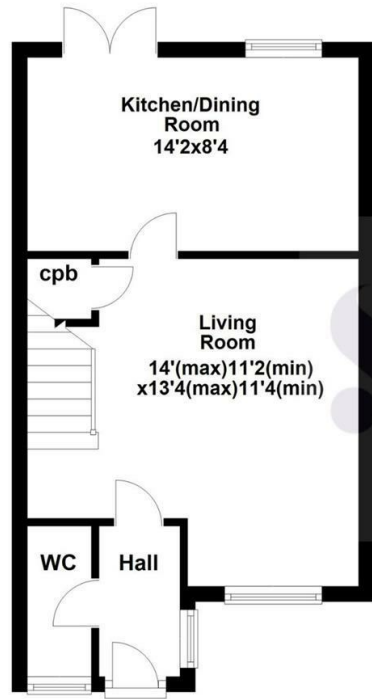

First Floor

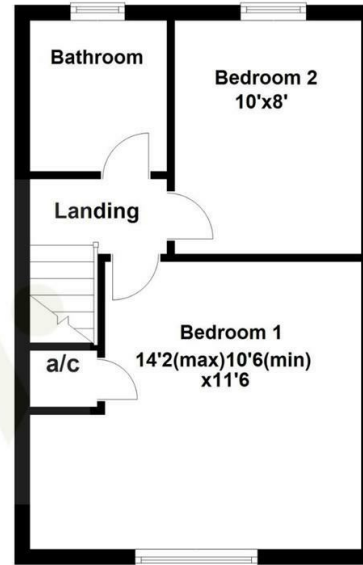

Floor plan not to scale - for guidance purposes only.
 Floor plan created by Simpson West for their use.
 Plan produced using PlanUp.

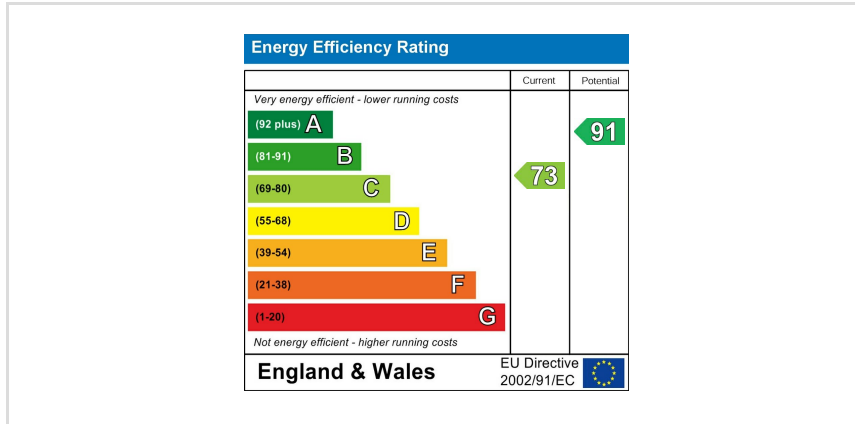

When you buy with Simpson West, you know **you'll be in safe hands**. From the moment you walk through our doors, we'll make you **feel truly welcome**. Our sales consultants and financial advisors will take you through **every step of the process**, offering **free expert advice** along the way, from help choosing the right mortgage and insurance through to finding your conveyancer. And if you need help selling your home too, **with over 20 years of local experience, you can trust us to get you moving**.



**Simpson
West**

Making Every
Journey Personal



01536 202007

info@simpsonwest.co.uk

<https://www.simpsonwest.co.uk/>

64 Corporation Street, Corby, Northants, NN17 1NH