



1a School Hill

Middleton, Market Harborough, LE16 8YZ



Simpson West

Nestled away within the picturesque village of Middleton is this well presented stone built three bedroom semi detached home that is being offered to the market for sale with no onward chain. The property occupies a pleasant position enjoying views of the sensation Welland Valley and is within walking distance to the village school, transport links and other amenities. Features include an entrance hall, cloakroom w/c, large living room, modern fitted kitchen with integrated appliances and the dining room with doors leading to the rear garden. To the first floor there are two double bedrooms with the larger boasting a dressing area with fitted wardrobe and en-suite shower room, in addition there is a single bedroom and the main family bathroom. To the rear is a low maintenance garden that is fully enclosed with various seating areas. To the front is off road parking for multiple vehicles and a car port. Early viewings are highly encouraged. Energy rating C. Council Tax Band D.



£339,950

3 2 1



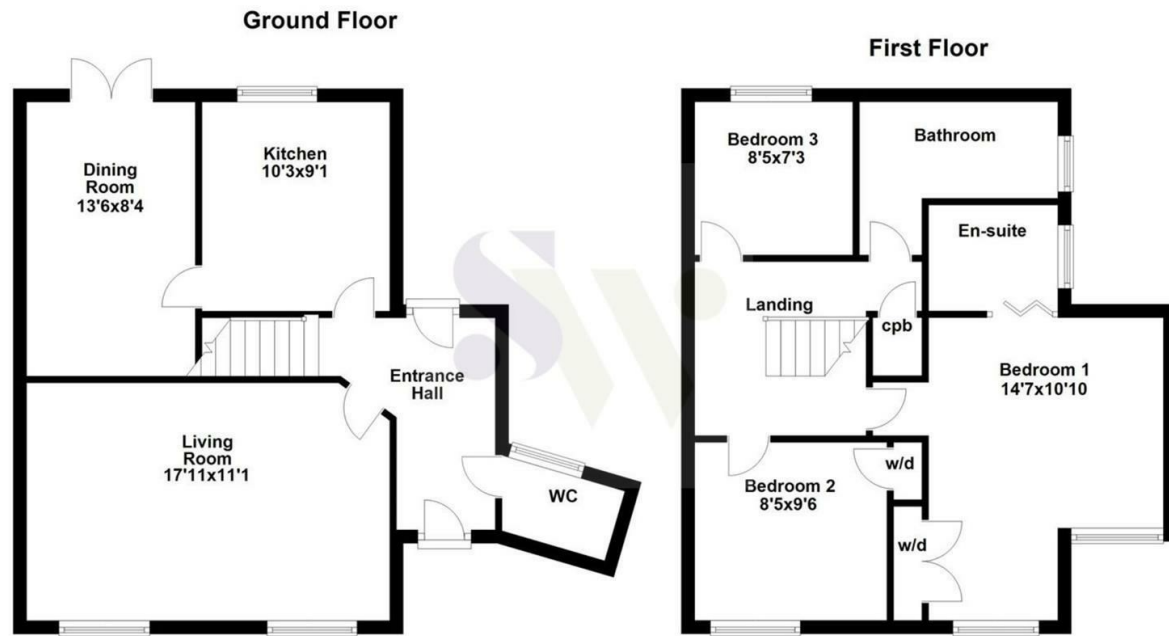

Floor plan not to scale - for guidance purposes only.
Plan produced using PlanUp.



Energy Efficiency Rating		
	Current	Potential
<i>Very energy efficient - lower running costs</i>		
(92 plus) A		
(81-91) B		85
(69-80) C	71	
(55-68) D		
(39-54) E		
(21-38) F		
(1-20) G		
<i>Not energy efficient - higher running costs</i>		
England & Wales	EU Directive 2002/91/EC	



When you buy with Simpson West, you know **you'll be in safe hands**. From the moment you walk through our doors, we'll make you **feel truly welcome**. Our sales consultants and financial advisors will take you through **every step of the process**, offering **free expert advice** along the way, from help choosing the right mortgage and insurance through to finding your conveyancer. And if you need help selling your home too, **with over 20 years of local experience, you can trust us to get you moving**.



**Simpson
West**

Making Every
Journey Personal



01536 202007

info@simpsonwest.co.uk

<https://www.simpsonwest.co.uk/>

64 Corporation Street, Corby, Northants, NN17 1NH