



6 Fletchers Close, Leicester, LE19 2PX

£229,950

NO CHAIN - Situated at the head of a quiet cul de sac, this **BEAUTIFULLY** presented two bedroomed **END TOWNHOUSE** has spacious accommodation briefly comprising: Entrance hallway, Modern kitchen, Living / dining room, Two **GOOD** sized bedrooms and a modern Bathroom. Outside: **GENEROUS** rear garden and **DRIVEWAY** parking.

Entrance hallway



With an opening to the kitchen and a door to the living room, radiator.

Kitchen



With a window to the front aspect, fitted with a modern and quality range of eye level and base level storage units and matching upstands. There is a fitted double electric oven with a hob and extractor hood over together with space / plumbing for a washing machine, dishwasher and a fridge / freezer,

Additional Image



Additional Image



Living / Dining Room



With sliding patio doors to outside, stairs off rising to the first floor, radiator.

Additional Image



First Floor Landing

With doors off to all first floor accommodation.

Bedroom One



With a window to the front aspect, radiator.

Additional Image



Bedroom Two



With a window to the rear aspect, radiator.

Family Bathroom



With a window to the rear aspect, fitted with a low level w/c, inset wash basin with storage under and a bath with shower over. Radiator.

Outside



The enclosed, generous and well maintained rear garden is laid largely to lawn with surrounding borders and a raised area of timber decking.

To the side of the property is driveway parking.

Additional Image



Additional Image



Additional Image



Offer Procedure

If you are obtaining a mortgage on this property, one of our qualified mortgage consultants will contact you to qualify the offer on behalf of our vendors.

In order to satisfy money laundering regulations Carlton Estates are required to carry out checks to verify each parties identity.

Mortgages

Independent Mortgage advice is available through this office. If you wish to speak to our Independent Financial Adviser, please call our office to arrange an appointment.

Thinking of Selling?

IF YOU ARE THINKING OF SELLING YOUR PROPERTY LET OUR LOCAL KNOWLEDGE AND EXPERIENCE WORK FOR YOU!

Carlton Estates are an independent and family run estate agency specialising in the local market, having a reputation for quality, service and customer care.

We value your business and understand that selling your home is a major decision.

Our guarantee to you is that through our professionalism and attention to detail in every respect, we will endeavor to ensure the entire process is as straight forward and hassle free as possible.

10 GOOD reasons to choose Carlton Estates:

- * THE local agent
- * FREE market appraisal
- * REALISTIC valuations based on local market knowledge

- * EXTENSIVE advertising for maximum exposure
 - * COMPETITIVE fees
 - * REGULAR client feedback
 - * MORTGAGE advice available
 - * NO sale no fee
 - * ACCOMPANIED viewing's where necessary
 - * INTERNET advertising to include, Rightmove, ONTHEMARKET, FindaProperty and our own www.carltonestates.co.uk
- CALL US NOW ON 0116 284 9636

Notes For Purchasers

While every reasonable effort is made to ensure the accuracy of descriptions and content, we should make you aware of the following guidance or limitations.

(1) MONEY LAUNDERING REGULATIONS Intending purchasers will be asked to produce identification documentation at a later stage and we would ask for your cooperation in order that there will be no delay in agreeing the sale.

(2) These particulars do not constitute part or all of an offer or contract.

(3) The measurements indicated are supplied for guidance only and as such must be considered incorrect.

(4) Potential buyers are advised to recheck the measurements before committing to any expense.

(5) Carlton Estates (Narborough) Ltd has not tested any apparatus, equipment, fixtures, fittings, or services and it is in the buyer's interests to check the working condition of any appliances.

Opening Hours

MONDAY - FRIDAY : 9:00am - 17:30pm SATURDAY : 10:00am - 14:00pm



Ground Floor

Approx. 27.4 sq. metres (294.9 sq. feet)

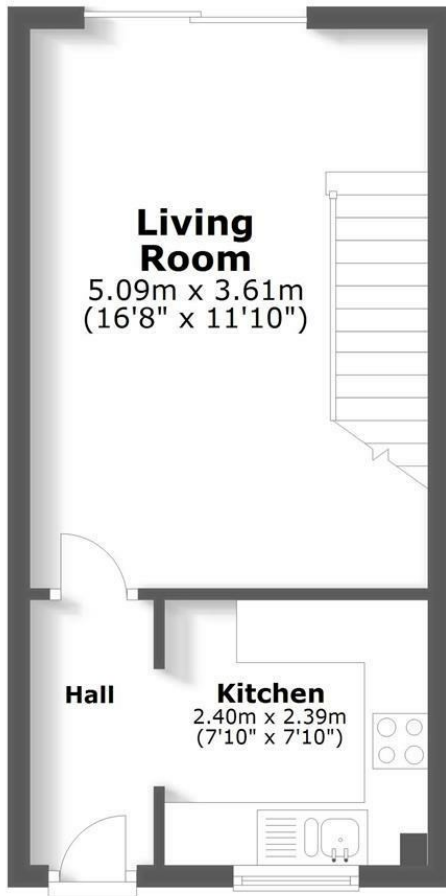

First Floor

Approx. 27.4 sq. metres (294.9 sq. feet)

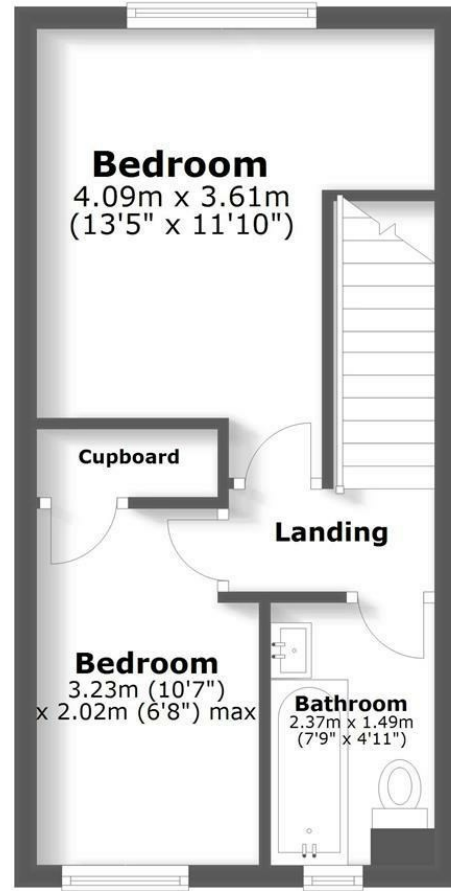

Total area: approx. 54.8 sq. metres (589.9 sq. feet)



Energy Efficiency Rating	
Current	Potential
74	90

Energy Efficiency Rating scale (A-G):

- A (92 plus)
- B (81-91)
- C (69-80)
- D (55-68)
- E (39-54)
- F (21-38)
- G (1-20)

Not energy efficient - higher running costs

England & Wales EU Directive 2002/91/EC

Environmental Impact (CO ₂) Rating	
Current	Potential

Environmental Impact (CO₂) Rating scale (A-G):

- A (92 plus)
- B (81-91)
- C (69-80)
- D (55-68)
- E (39-54)
- F (21-38)
- G (1-20)

Not environmentally friendly - higher CO₂ emissions

England & Wales EU Directive 2002/91/EC