

Cromwells



Dorset Road, Sutton, SM2 6NG

£315,000

This good size two double bedroom ground floor flat has the benefit of a garage, permit parking and communal gardens. It is situated in a popular and convenient location close to the amenities of both Cheam and Belmont Village, including shops, restaurants, gyms, other leisure facilities and transport links. Belmont mainline railway station is a short walk away and Cheam mainline railway station is also within easy reach. Well regarded local schools include Overton Grange, Sutton Grammar School and Nonsuch High School for Girls.

EPC rating D. No Onward Chain.

Accommodation

The front door of this ground floor apartment opens into a lobby area and onto the hallway, with cupboard.

Off the hallway are the two double bedrooms, one with built in wardrobes, the spacious reception room, the fitted kitchen/diner and the bathroom.

Outside

There are communal gardens.
The flat has a garage plus permit parking.





Council Tax - C
Tenure - Leasehold

54-56 High Street
Cheam Village
Surrey
SM3 8RW

02086 424249
admin@cromwellscheam.co.uk

Disclaimer

These particulars are not an offer or contract, nor part of one. You should not rely on statements made by Cromwells in the particulars or by word of mouth or in writing ("information") as being factually accurate about the property, its condition or value. Neither

Cromwells nor any joint agent has authority to make representations about the property, and accordingly any information given is entirely without responsibility on the part of the agents, seller(s) or lessor(s). Photographs show only certain parts of the property as they appeared at the time they were taken. Areas, measurements and distances are given as an approximate only. Any reference to alterations to or use of, any part of the property does not mean that any necessary planning, building regulations or other consents have been obtained

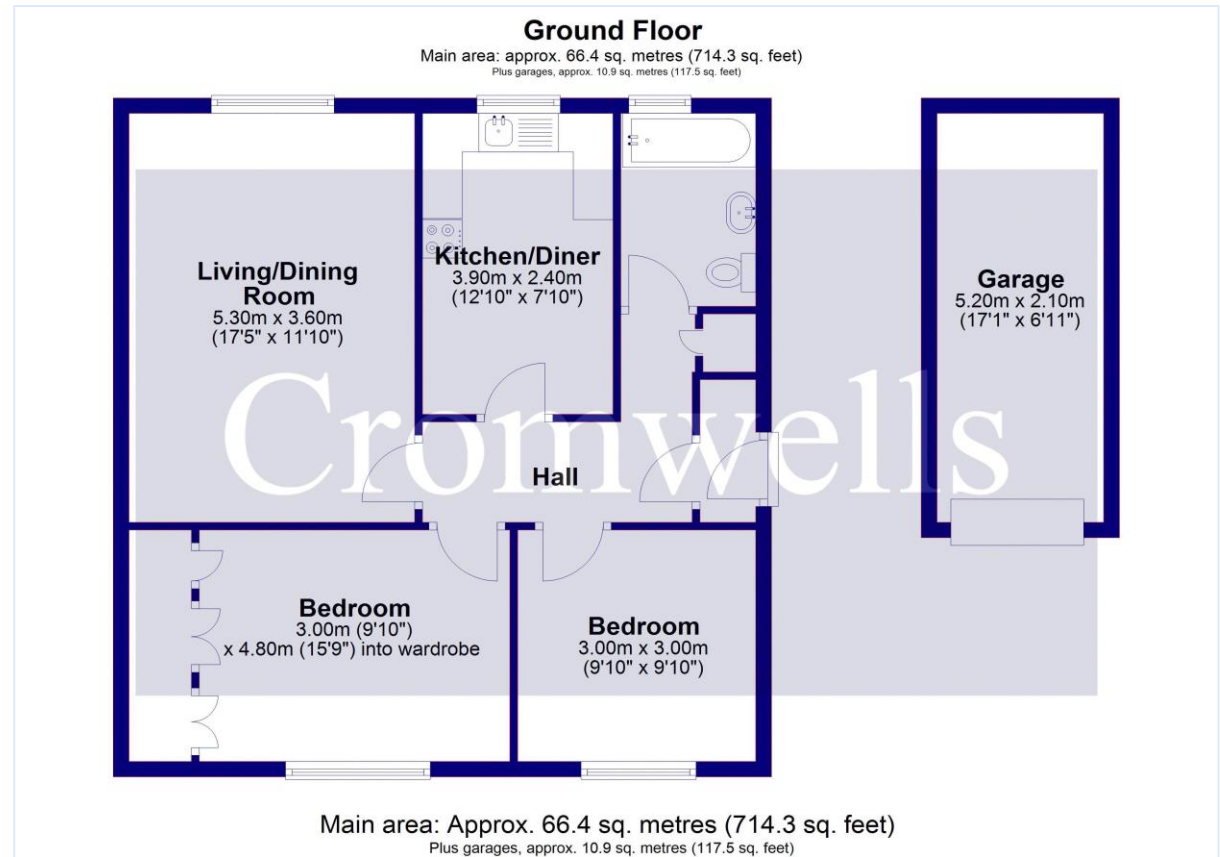

Score	Energy rating	Current	Potential
92+	A		
81-91	B		
69-80	C		77 C
55-68	D	58 D	
39-54	E		
21-38	F		
1-20	G		



