

Cromwells



Devonshire Road, Sutton, SM2 5EJ

£270,000

Cromwells are pleased to offer this one bedroom first floor flat with a garage and attractive communal gardens. It is situated within a popular development, in a convenient residential location, close to the amenities of Sutton Town Centre. There are shops, restaurants, gyms, other leisure facilities and good transport links. Sutton mainline railway station is nearby, with excellent services into Central London.

No Onward Chain. Share of Freehold. EPC rating D.

Accommodation

A hallway with storage cupboards leads to the spacious, double aspect reception room, the good size double bedroom, the modern fitted kitchen and the bathroom.

Outside

The apartment has a garage en bloc. There are well maintained communal gardens with lawn and mature shrub and tree planting.





Council Tax - C
Tenure - Share of Freehold

54-56 High Street
Cheam Village
Surrey
SM3 8RW

02086 424249
admin@cromwellscheam.co.uk

Disclaimer

These particulars are not an offer or contract, nor part of one. You should not rely on statements made by Cromwells in the particulars or by word of mouth or in writing ("information") as being factually accurate about the property, its condition or value. Neither Cromwells nor any joint agent has authority to make representations about the property, and accordingly any information given is entirely without responsibility on the part of the agents, seller(s) or lessor(s). Photographs show only certain parts of the property as they appeared at the time they were taken. Areas, measurements and distances are given as an approximate only. Any reference to alterations to or use of, any part of the property does not mean that any necessary planning, building regulations or other consents have been obtained

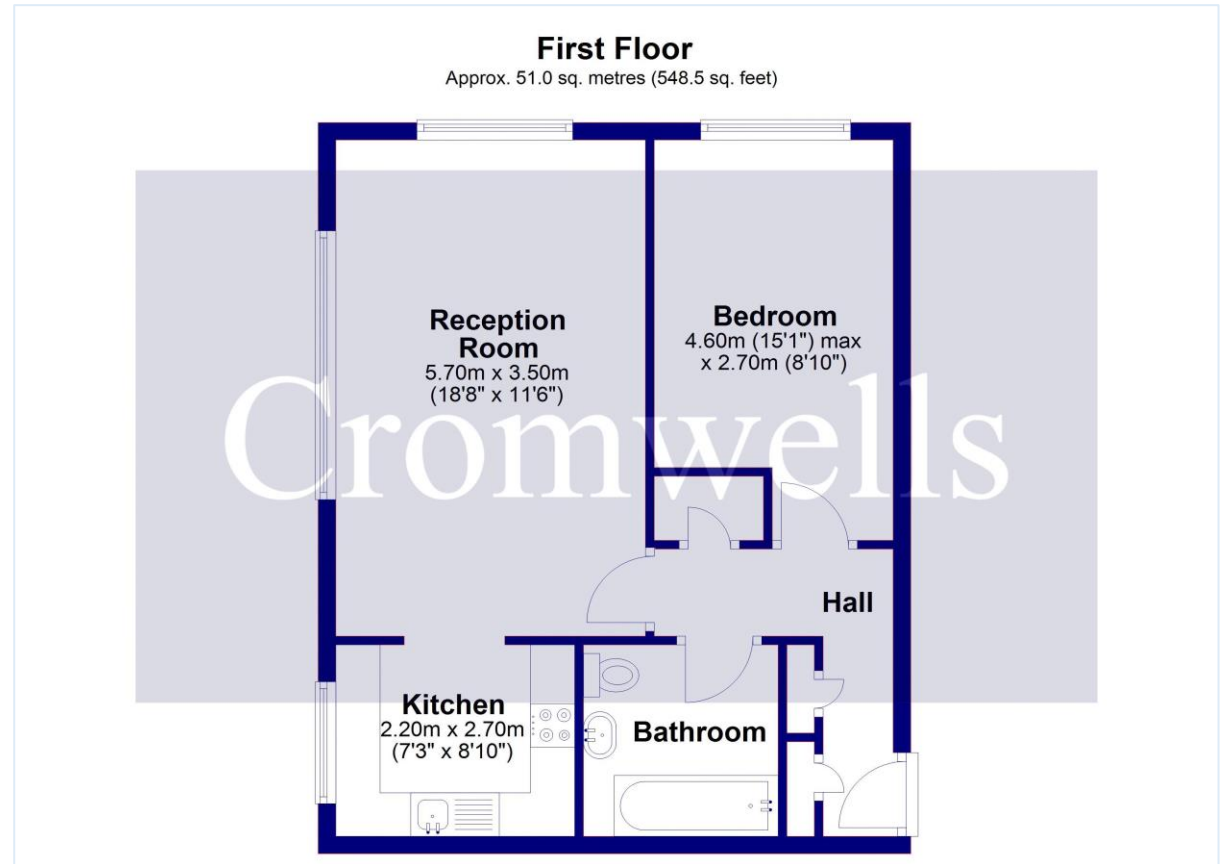

Score	Energy rating	Current	Potential
92+	A		
81-91	B		
69-80	C		79 C
55-68	D	66 D	
39-54	E		
21-38	F		
1-20	G		



