



7 Vulcan House Restmor Way, Wallington, SM6 7GF



1



1



1

Guide price £270,000

Cromwells
ESTATE AGENTS



7 Vulcan House Restmor

Wallington, SM6 7GF

Guide price £270,000

Cromwells Wallington are delighted to present this stunning one bedroom luxury apartment, located in a modern development in Hackbridge overlooking the River Wandle. This beautiful home boasts a beautifully designed open plan living, kitchen and dining area, ideal for entertaining family and friends, and a stunning mezzanine level large double bedroom.

The property is finished to a high specification throughout, with a contemporary kitchen equipped with integrated appliances, a luxury bathroom suite and a spacious bedroom.

Vulcan House offers excellent access to local shops and amenities. There are great transport links with Hackbridge mainline train station only a short walk away with it's fast links into Central London. For those looking for local green space to enjoy, Beddington Park and the Wandle Trail are close by. Don't miss the opportunity to make this elegant flat your new home. Contact us today to arrange a viewing and experience the luxury and comfort this property has to offer.



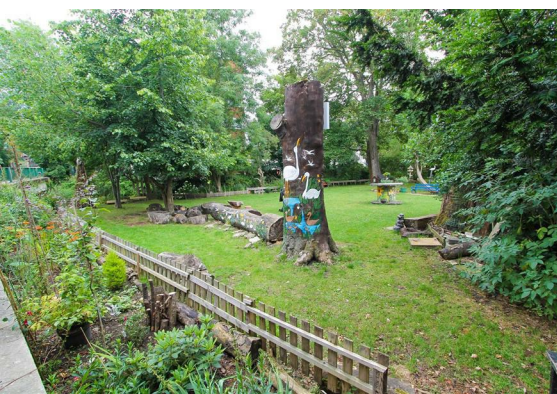

Accommodation

Video security entry system, door into communal hallway. Front door into

Open plan Living Area and Kitchen

Living Area

Modern electric heaters, laminate flooring, UPVC full-length double glazed windows to front aspect.

Kitchen

Range of modern fitted kitchen units and drawers, Quartz worktop, inset stainless steel sink with chrome mixer tap, integrated fridge freezer, integrated dishwasher, integrated Bosch oven and electric hob with extractor fan above, splashback, laminate flooring.

Inner Hallway

Large utility cupboard with space and plumbing for washing machine .

Bathroom

Luxury three-piece suite comprising bath with shower screen, thermostatic shower with rain shower head and hand shower attachment, wash handbasin with chrome mixer tap and storage below, enclosed WC, heated chrome towel rail, extractor fan, tiled walls and flooring, double glazed window to rear aspect.

Stairs up to mezzanine level

Bedroom

Fitted carpet, double glazed obscure window to rear aspect

Floor Plan

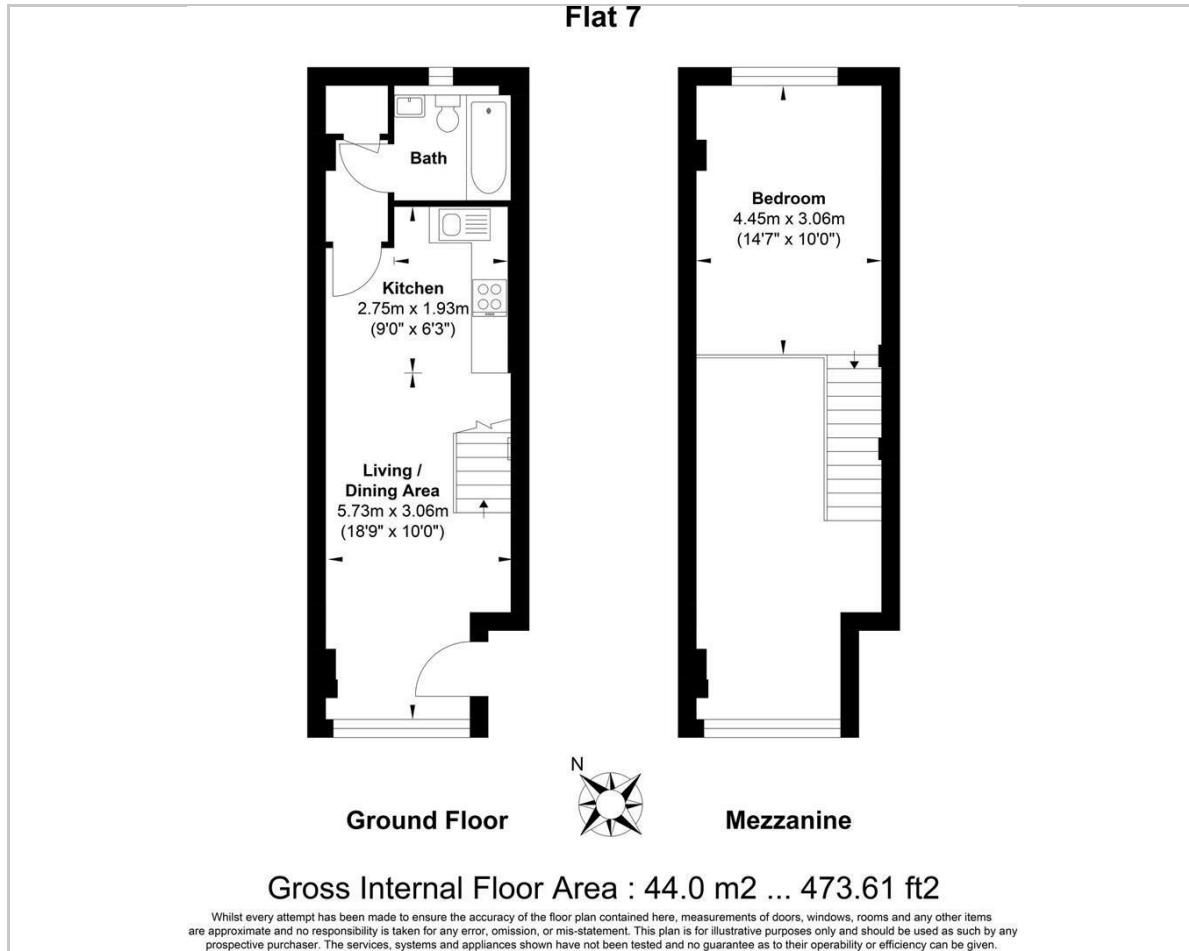

Viewing

Please contact our Cromwells Office on 0208 647 4422

if you wish to arrange a viewing appointment for this property or require further information.

These particulars, whilst believed to be accurate are set out as a general outline only for guidance and do not constitute any part of an offer or contract. Intending purchasers should not rely on them as statements of representation of fact, but must satisfy themselves by inspection or otherwise as to their accuracy. No person in this firm's employment has the authority to make or give any representation or warranty in respect of the property.

Area Map

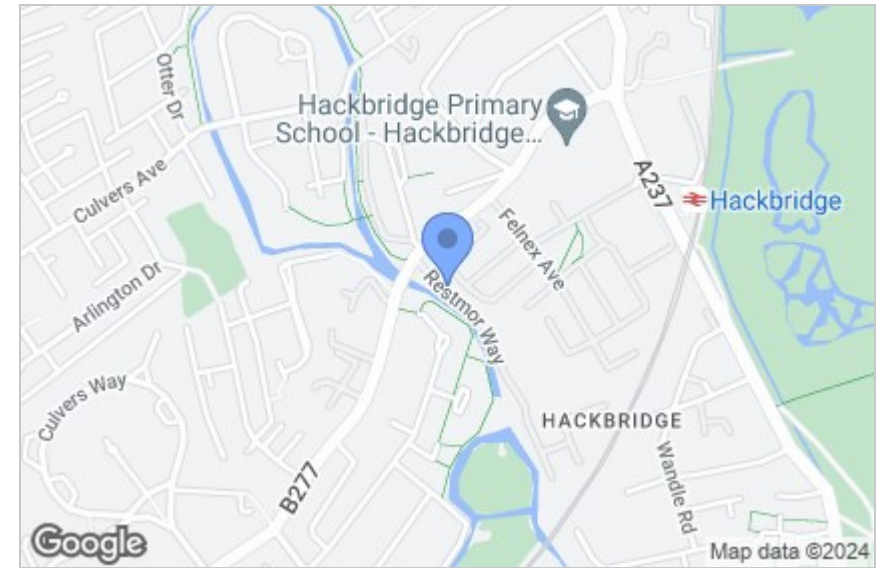

Energy Efficiency Graph

