

Cromwells



Meller Close, Croydon, Surrey, CR0 4UB
Guide Price £475,000

A delightful 3 bedroom Semi Detached family home within easy reach of Beddington Park with its vast outdoor space and within easy access of Hackbridge & Waddon BR station, local shops and also within reach of Croydon Town Centre, Tram link & Mainline BR station.



- *Open plan Lounge/Dining Room**
 - *Ground floor WC**
 - *3 Good size Bedrooms**
 - *Driveway for off street Parking**
-

Front door leading to:

Entrance Hall

Doors to:

Living Room - 10' 6" x 16' 3" (3.20m x 4.95m)

Front aspect, fireplace, open through to dining room.

Dining Room - 5' 11" x 9' 6" (1.80m x 2.89m)

Side aspect, leading from living room and into kitchen

Kitchen - 8' 10" x 13' 7" (2.69m x 4.14m)

Rear aspect, door to garden & door to ground floor WC

Stairs to first floor landing

Doors to:

Bedroom 1 - 10' 6" x 13' 0" (3.20m x 3.96m)

Front aspect, fitted wardrobe cupboards

Bedroom 2 - 9' 0" x 14' 7" (2.74m x 4.44m)

Rear aspect, fitted wardrobe cupboards

Bedroom 3 - 10' 6" x 6' 9" (3.20m x 2.06m)

Front aspect

Family Bathroom

Rear aspect

Outside

Large Rear Garden

Driveway to front for off street parking



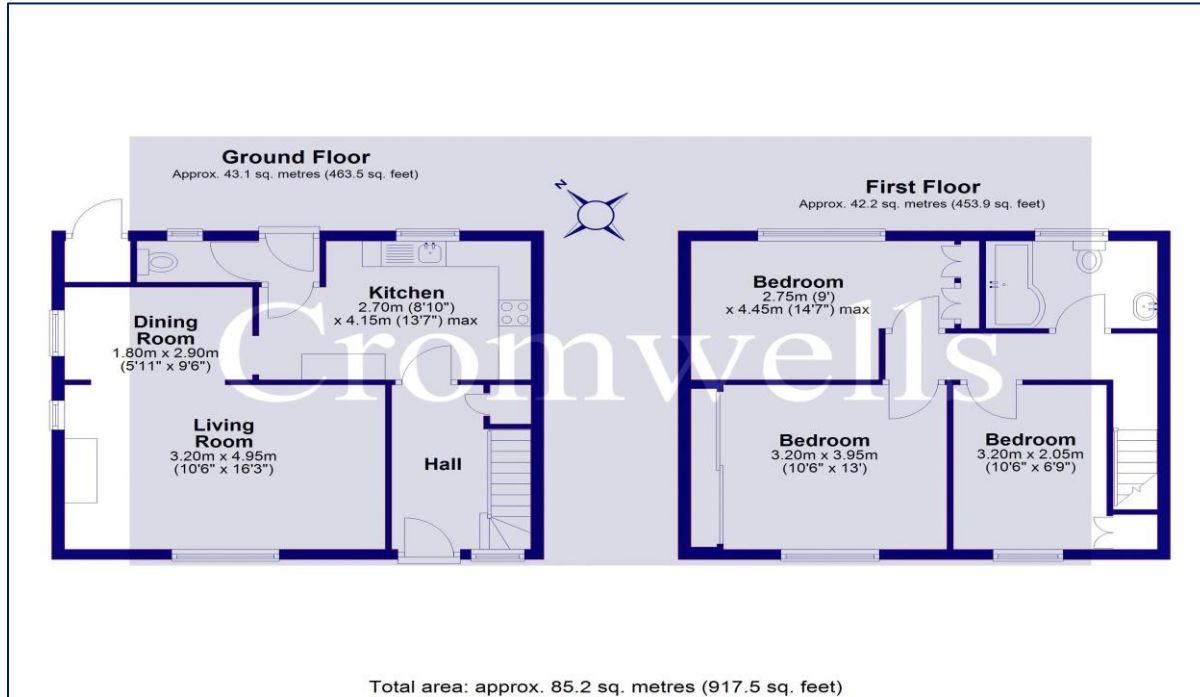

Council Tax - D
Local Authority: London Borough of Sutton
Tenure - Freehold



95 Banstead Road
Carshalton
Surrey
SM5 3NP



020 8642 5468



admin@cromwellscarshalton.com



www.cromwellsestateagents.uk

Score	Energy rating	Current	Potential
92+	A		
81-91	B		82 B
69-80	C		
55-68	D	66 D	
39-54	E		
21-38	F		
1-20	G		

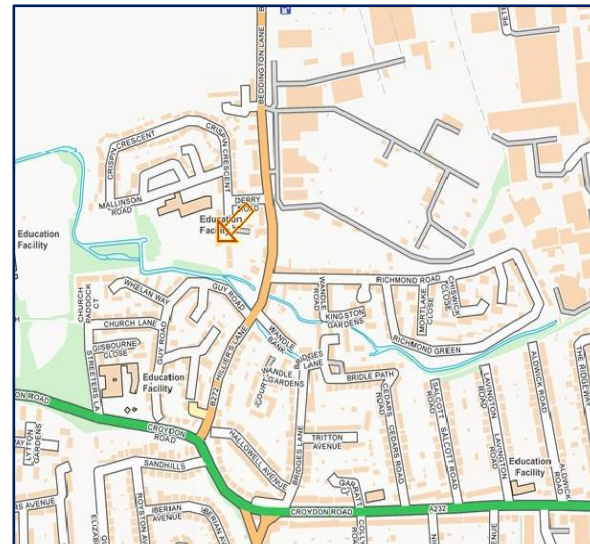

Disclaimer

These particulars are not an offer or contract, nor part of one. You should not rely on statements made by Cromwells in the particulars or by word of mouth or in writing ("information") as being factually accurate about the property, its condition or value. Neither Cromwells nor any joint agent has authority to make representations about the property, and accordingly any information given is entirely without responsibility on the part of the agents, seller(s) or lessor(s). Photographs show only certain parts of the property as they appeared at the time they were taken. Areas, measurements and distances are given as an approximate only. Any reference to alterations to or use of, any part of the property does not mean that any necessary planning, building regulations or other consents have been obtained