



Cromwells

Wending Road, Sutton, Surrey, SM1 3NE
Guide Price £450,000

**A very well presented and spacious three bedroom terraced property, offering excellent potential for extension (STPP).
The property is ideally located close to St Helier hospital, as well as local shops, transport links and an array of well performing schools.**



***Three bedrooms *West facing rera garden
*No chain *Excellent location**

Entrance Hall

Under stairs storage

**Reception Room - 13' 5" x 11' 9"
(4.09m x 3.58m)**

Front aspect, fireplace

**Kitchen - 6' 4" x 11' 10" (1.93m x
3.60m)**

Fitted kitchen, storage cupboard, door
opening into the garden

Bathroom

Three piece suite, rear aspect window,
storage cupboard



Bedroom 1 - 9' 2" x 17' 10" (2.79m x 5.43m)

Very large master bedroom, front aspect window, built in wardrobes

Bedroom 2 - 10' 9" x 9' 2" (3.27m x 2.79m)

Rear aspect window, built in wardrobe

Bedroom 3 - 7' 9" x 8' 0" (2.36m x 2.44m)

Rear aspect window, built in wardrobe

Outside -

Rear garden



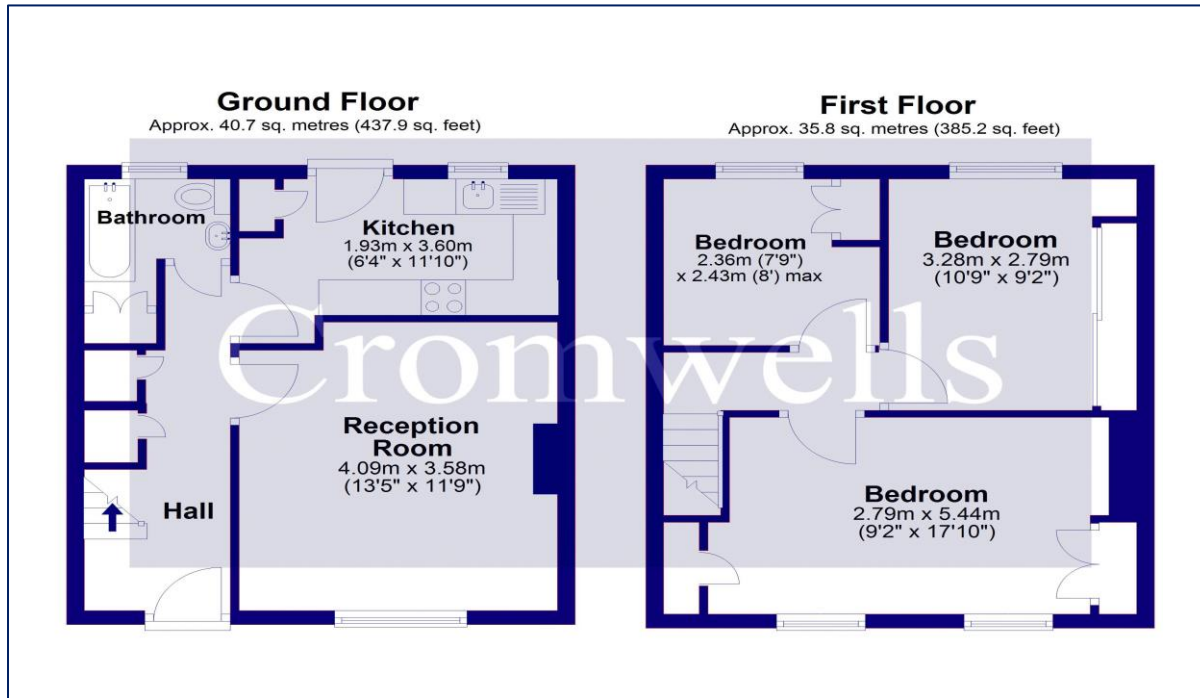

Council Tax - C
Local Authority: London Borough of Sutton
Tenure - Freehold



95 Banstead Road
Carshalton
Surrey
SM5 3NP



020 8642 5468



admin@cromwellscarshalton.com



www.cromwellsestateagents.uk

Score	Energy rating	Current	Potential
92+	A		
81-91	B		82 B
69-80	C		
55-68	D	65 D	
39-54	E		
21-38	F		
1-20	G		

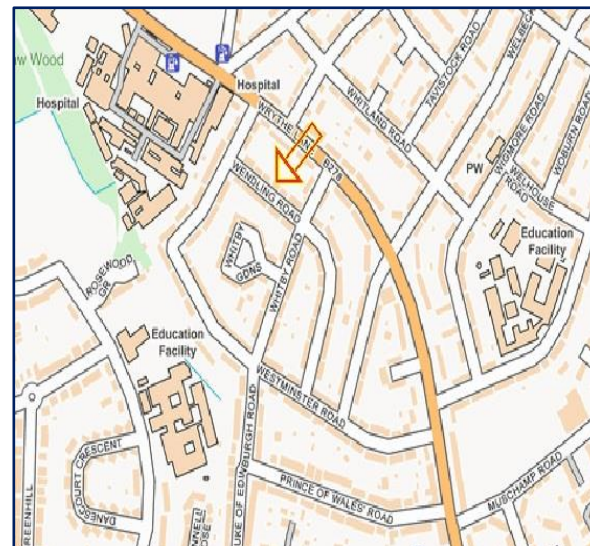

Disclaimer

These particulars are not an offer or contract, nor part of one. You should not rely on statements made by Cromwells in the particulars or by word of mouth or in writing ("information") as being factually accurate about the property, its condition or value. Neither Cromwells nor any joint agent has authority to make representations about the property, and accordingly any information given is entirely without responsibility on the part of the agents, seller(s) or lessor(s). Photographs show only certain parts of the property as they appeared at the time they were taken. Areas, measurements and distances are given as an approximate only. Any reference to alterations to or use of, any part of the property does not mean that any necessary planning, building regulations or other consents have been obtained