



**GASCOIGNE  
HALMAN**

THE WHITE HOUSE, UPCAST LANE, WILMSLOW SK9  
6EH

---

THE AREAS LEADING ESTATE AGENT





## THE WHITE HOUSE, UPCAST LANE, WILMSLOW SK9 6EH

**£925,000**

**Mixing contemporary style with cottage chic, The White House makes for a rare opportunity being a completely remodelled and detached property combining two wings of accommodation with five bedrooms, three bath/shower rooms, a snug and a large living-dining kitchen. Superb views.**

- Stunning Detached Cottage With Attached Coach House Style Annexe
- Five Generously Sized Bedrooms (Three To The Main House)
- Three Stylish Bath/Shower Rooms
- Impressive Extended Dining Kitchen With Family/Dining Room
- Desirable South Wilmslow Location Overlooking Lindow Cricket Club
- Landscaped Private Courtyard Garden With Patio





This delightful detached cottage boasts period features and contemporary fittings throughout, along with spacious flexible accommodation to suit all.

Positioned in the sought after location of South Wilmslow on Upcast Lane, the house enjoys pleasant views across the neighbouring Lindow Cricket Club and has a manageable private courtyard garden to the rear.

The accommodation offers a welcoming reception hall with feature fireplace, separate living room to the front, then an impressive extended dining kitchen leading to the dining/family room which approaches the rear wing of accommodation, with its private hallway, utility room, downstairs shower room, store room and two bedrooms to the first floor.

Whilst to the first floor of the the main house there are three good sized double bedrooms along with a modern en-suite and fitted bedroom furniture to the principal bedroom and a contemporary family bathroom off the landing.

Externally, to the front of the property there is gravel driveway providing off road parking and side access via a double gate leading to the courtyard garden which has been landscaped and now benefits from Astro Turf and a spacious patio area ideal for al fresco dining.

#### LOCATION

Conveniently situated within easy reach of both Wilmslow town centre and Alderley Edge village with their excellent range of shops and general services, restaurants and cafes. There are good schools in the area, both State and Private, for children of all ages. Wilmslow railway station is on the main line to London Euston and also provides a regular service to Manchester and surrounding districts. The North West motorway network is within a short drive as is Manchester Airport and the A34 Wilmslow by-pass which provides access to the large stores at Handforth Dean and Cheadle including Marks & Spencer, Tesco, John Lewis and Sainsburys. Wilmslow has a leisure centre and there are also a number of private sporting clubs in the area.

#### DIRECTIONS

Sat-Nav: SK9 6EH

#### TENURE

Freehold. Subject to verification by solicitors.

#### SERVICES (NOT TESTED)

Services have not been tested and you are advised to make your own enquiries and/or inspections.

#### LOCAL AUTHORITY

Cheshire East. Property Band: G

#### VIEWING

Viewing strictly by appointment through the Agents.



## FLOORPLAN & EPC

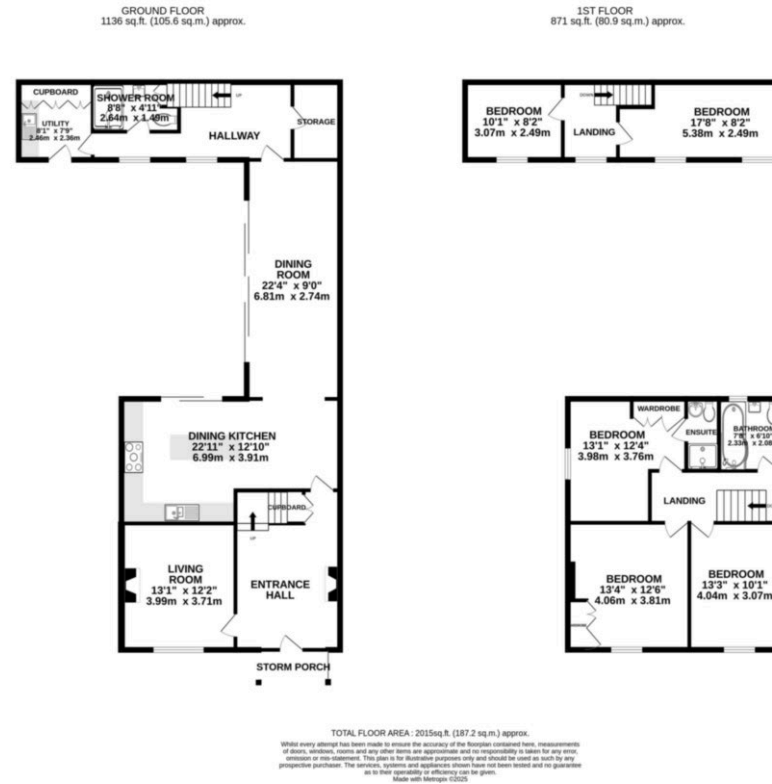

NOTICE Gascoigne Halman for themselves and for the vendors or lessors of this property whose agents they are give notice that: (i) the particulars are set out as a general outline only for the guidance of intending purchasers or lessees, and do not constitute, nor constitute part of, an offer or contract; (ii) all descriptions, dimensions, references to condition and necessary permissions for use and occupation, and other details are given in good faith and are believed to be correct but any intending purchasers or tenants should not rely on them as statements or representations of fact but must satisfy themselves by inspection or otherwise as to the correctness of each of them; (iii) no person in the employment of Gascoigne Halman has any authority to make or give any representation or warranty whatever in relation to this property.



### WILMSLOW OFFICE

01625 536434

wilmslow@gascoignehalman.co.uk

40 Alderley Road, Wilmslow, Cheshire, SK9 1NY

**GASCOIGNE  
HALMAN**