

25 HAZELDEAN COURT
 Pinewood Road, Wilmslow
£190,000

GROUND FLOOR
 616 sq.ft. (57.2 sq.m.) approx.

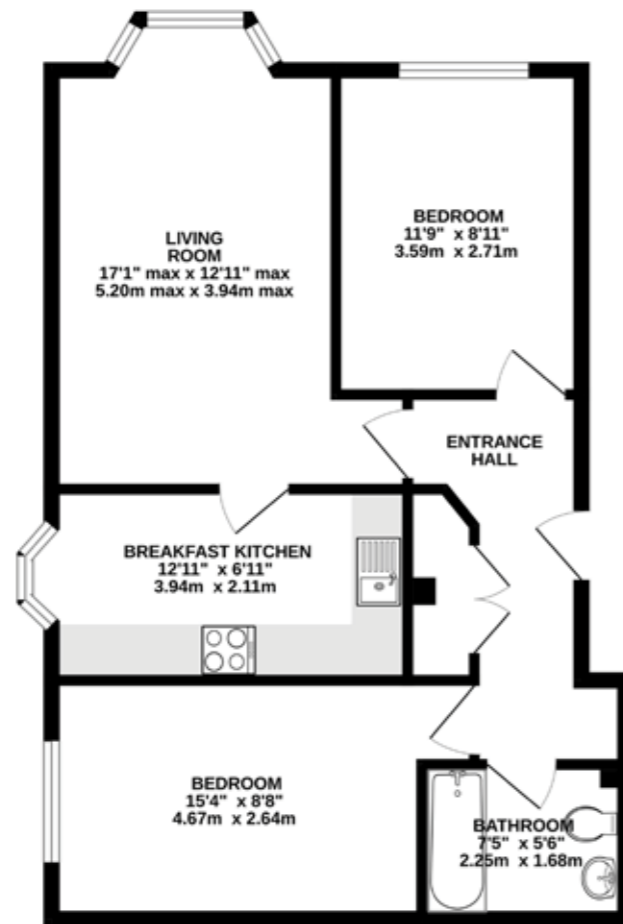

TOTAL FLOOR AREA: 616 sq.ft. (57.2 sq.m.) approx.

While every attempt has been made to ensure the accuracy of the floorplan contained here, measurements of doors, windows, rooms and any other items are approximate and no responsibility is taken for any error, omission or mis-statement. This plan is for illustrative purposes only and should be used as such by any prospective purchaser. The services, systems and appliances shown have not been tested and no guarantee as to their operability or efficiency can be given.
 Made with Metropix ©2024



NOTICE
 Gascoigne Halman for themselves and for the vendors or lessors of this property whose agents they are give notice that: (i) the particulars are set out as a general outline only for the guidance of intending purchasers or lessees, and do not constitute, nor constitute part of, an offer or contract; (ii) all descriptions, dimensions, references to condition and necessary permissions for use and occupation, and other details are given in good faith and are believed to be correct but any intending purchasers or tenants should not rely on them as statements or representations of fact but must satisfy themselves by inspection or otherwise as to the correctness of each of them; (iii) no person in the employment of Gascoigne Halman has any authority to make or give any representation or warranty whatever in relation to this property.

THE AREAS LEADING ESTATE AGENCY

Wilmslow
 40, Alderley Road, WILMSLOW SK9 1NY
 01625 536434 wilmslow@gascoignehalman.co.uk

gascoignehalman.co.uk



GASCOIGNE HALMAN

A light and spacious two double bedroom modern apartment located on the first floor of this purpose built development within easy access to Wilmslow centre. Allocated parking plus additional visitor spaces.

- GOOD SIZED FIRST FLOOR APARTMENT
- WELL PRESENTED ACCOMMODATION
- TWO DOUBLE BEDROOMS

- ALLOCATED PARKING PLUS VISITOR PARKING
- EASY ACCESS TO WILMSLOW CENTRE
- IDEAL FOR FIRST TIME BUYER OR BUY-TO-LET INVESTOR

£190,000

25 HAZELDEAN COURT

Pinewood Road, Wilmslow



DESCRIPTION

This delightful two bedroom apartment boasts excellent sized accommodation throughout. Briefly comprising: communal entrance hall, a welcoming entrance hall, a fantastic living room with feature bay window plus a good sized separate kitchen with a range of base and eye level units. Two double bedrooms and a modern fitted bathroom.

Externally the property benefits from allocated parking and additional visitor parking. This apartment is in a prime location and is an ideal property for a first time buyer or a buy-to-let investor.

The service charge is currently £310 per quarter (subject to verification by solicitors).

LOCATION

Conveniently situated within easy reach of Wilmslow town centre with its excellent range of shops and general services, restaurants and wine bars. There are good schools in the area, both State and Private, for children of all ages. Wilmslow railway station is on the main line to London Euston and also provides a regular service to Manchester and surrounding districts. The North West motorway network is within a short drive as is Manchester Airport and the A34 Wilmslow by-pass which provides access to the stores at Handforth Dean and Cheadle. Wilmslow has a leisure centre and there are also a number of private sporting clubs in the area.

DIRECTIONS

Sat-Nav: SK9 2RP

TENURE

Leasehold for 125 years from 01/01/1997 with a ground rent of £95 p.a. Subject to verification by solicitors.

SERVICES (NOT TESTED)

Services have not been tested and you are advised to make your own enquiries and/or inspections.

LOCAL AUTHORITY

Cheshire East. Property Band: C

VIEWING

Viewing strictly by appointment through the Agents.

TWENTY NETWORKED OFFICES THROUGHOUT CHESHIRE, SOUTH MANCHESTER & THE HIGH PEAK



gascoignealman.co.uk

GASCOIGNE HALMAN