



**GASCOIGNE  
HALMAN**

26 HONEYGOLD VALE, APPLETON

---

THE AREAS LEADING ESTATE AGENT





## 26 HONEYGOLD VALE, APPLETON

An immaculate four bedroom semi detached townhouse positioned on a private stretch of driveway off Honeygold Vale. The property offers over 1200 sq ft of accommodation over the three floors with a stunning master bedroom suite with vaulted ceiling, whilst externally is an attractive rear garden and driveway.

In brief the property comprises, entrance hallway with stairs to the first floor and downstairs WC. A kitchen is fully fitted with a matching range of base and eye level cabinetry along with integrated appliances including, oven, hob, fridge freezer, dishwasher and washing machine. A separate lounge/diner has double doors to the rear garden and completes the ground floor.

To the first floor a three good sized bedrooms and the family bathroom whilst to the second floor is the master bedroom suite which has fitted wardrobes within the dressing area and a contemporary shower room.





Externally, the property overlooks the green at the front and has driveway parking leading down the side of the property. Positioned on a private section of the road with no through traffic. To the rear is a lawned garden, enclosed by timber fencing with gate to driveway.

### **LOCATION**

Stockton Heath village boasts a first-class range of shopping, schooling and recreational facilities. The nearby motorway system brings Manchester, Liverpool, Chester etc. within easy commuting distance and there are fast and frequent train services to London from local stations. Manchester International Airport can be reached normally in about twenty minutes by car and the area is surrounded by glorious Cheshire countryside.

### **DIRECTIONS**

SATNAV: WA4 5RQ

### **TENURE**

Freehold

### **LOCAL AUTHORITY**

Warrington BC - Tax Band E

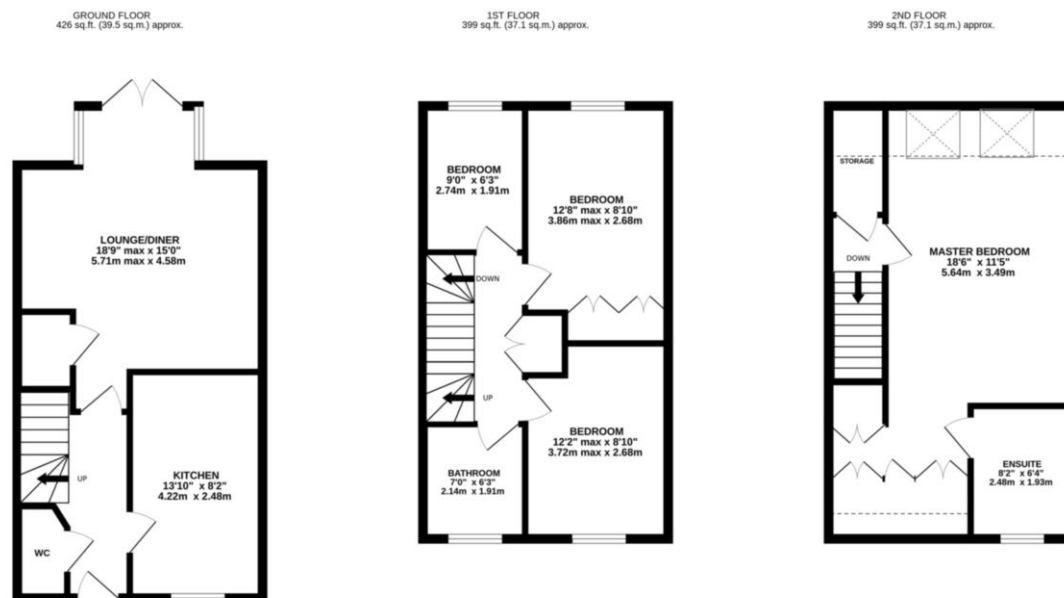

TOTAL FLOOR AREA : 1224 sq.ft. (113.7 sq.m.) approx.  
Measurements are approximate. Not to scale. Illustrative purposes only  
Made with Metropix ©2025

NOTICE Gascoigne Halman for themselves and for the vendors or lessors of this property whose agents they are give notice that: (i) the particulars are set out as a general outline only for the guidance of intending purchasers or lessees, and do not constitute, nor constitute part of, an offer or contract; (ii) all descriptions, dimensions, references to condition and necessary permissions for use and occupation, and other details are given in good faith and are believed to be correct but any intending purchasers or tenants should not rely on them as statements or representations of fact but must satisfy themselves by inspection or otherwise as to the correctness of each of them; (iii) no person in the employment of Gascoigne Halman has any authority to make or give any representation or warranty whatever in relation to this property.

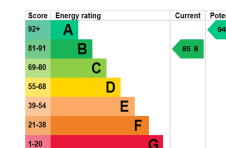

## STOCKTON HEATH OFFICE

01925 860 400

stocktonheath@gascoignehalman.co.uk

29 Walton Road, Stockton Heath, WA4 6NJ

**GASCOIGNE  
HALMAN**