



**GASCOIGNE
HALMAN**

35 BEECHWAYS, APPLETON, WARRINGTON

THE AREAS LEADING ESTATE AGENT



35 BEECHWAYS, APPLETON, WARRINGTON

Set within beautiful surrounding gardens is this three bedroom detached bungalow where the current owner has been since new. Situated in a quiet cul-de-sac surrounded by other bungalows the property benefits from a double garage and a long driveway providing ample off road parking.

In brief the internal accommodation comprises an entrance porch and hallway with guest WC. A large lounge has dual aspect sliding doors onto the rear and side gardens and floods the room with natural light. The lounge opens into the dining room which has a further set of sliding doors to the side. The kitchen is fitted with a modern range of base and eye level units with integral appliances including double oven, gas hob, microwave and fridge/freezer with a matching built in breakfasting table and door leading to the rear garden.





Two bedrooms include fitted wardrobes whilst the third is fitted as an office with desk, drawers and wall units. A bathroom with shower over the bath completes the accommodation. Externally the property has an attractive, private and mature rear garden with brick paved patio and garage access. The double garage has an electric up and over door.

LOCATION

Stockton Heath village boasts a first-class range of shopping, schooling and recreational facilities including an excellent nearby golf club. The nearby motorway system brings Manchester, Liverpool, Chester etc. within easy commuting distance and there are fast and frequent train services to London from local stations. Manchester International Airport and Liverpool Airport can both be reached normally in under half an hour by car and the area is surrounded by glorious Cheshire countryside.

DIRECTIONS

SAT NAV: WA4 5ER

TENURE

Freehold

LOCAL AUTHORITY

Warrington BC - Council Tax Band F

GROUND FLOOR
1399 sq.ft. (130.0 sq.m.) approx.

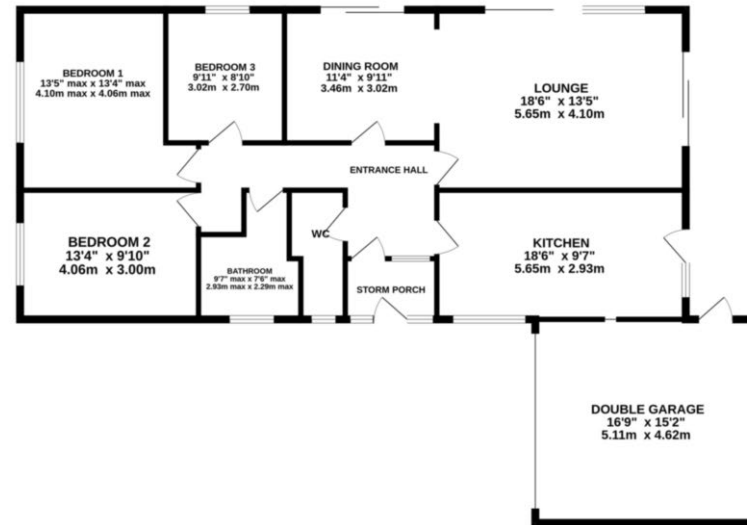

TOTAL FLOOR AREA: 1399 sq.ft. (130.0 sq.m.) approx.
Measurements are approximate. Not to scale. Illustrative purposes only.
Made with Metropix 3232

NOTICE Gascoigne Halman for themselves and for the vendors or lessors of this property whose agents they are give notice that: (i) the particulars are set out as a general outline only for the guidance of intending purchasers or lessees, and do not constitute, nor constitute part of, an offer or contract; (ii) all descriptions, dimensions, references to condition and necessary permissions for use and occupation, and other details are given in good faith and are believed to be correct but any intending purchasers or tenants should not rely on them as statements or representations of fact but must satisfy themselves by inspection or otherwise as to the correctness of each of them; (iii) no person in the employment of Gascoigne Halman has any authority to make or give any representation or warranty whatever in relation to this property.

STOCKTON HEATH OFFICE

01925 860 400
stocktonheath@gascoignehalman.co.uk
29 Walton Road, Stockton Heath

**GASCOIGNE
HALMAN**