



**GASCOIGNE
HALMAN**

26 GONVILLE AVENUE, SUTTON, MACCLESFIELD

THE AREAS LEADING ESTATE AGENT

| 475,000

A spacious detached bungalow offering beautifully presented extended accommodation with two reception rooms, conservatory and three bedrooms. Lovely West Facing private garden and all being situated in a very sought after location.

Situated in one of Suttons most sought after locations this extended three bedroom two bathroom detached bungalow offers beautifully presented accommodation throughout with a good size private west facing garden, double tandem garage and parking. This bungalow has some lovely features such as an impressive lounge with four meter high vaulted ceiling and a separate dining room and a conservatory. The bungalow is warm via GFCH and having upvc double glazing to a room layout, entrance porch, hall with a boiler cupboard. The main lounge is a good size with the fabulous vaulted ceiling and doors into the conservatory and the dining room. The dining kitchen is beautifully fitted in a range of cream

units and having a rear porch giving access in the the second shower room. Off the inner hall gives you access in to the three bedrooms (master with fitted wardrobes) and the beautifully fitted main shower room. Tandem garage with a utility area. Stunning good size private gardens with a shed and a green house. The is a driveway for three cars to the front.

Macclesfield is a thriving market town that provides a comprehensive range of shops, varied social and recreational amenities and good schools for children of all ages. For the commuter, Manchester International Airport and its connection with the North West motorway network are approximately thirty minutes away by car and the railway station in Macclesfield provides fast and frequent Intercity and commuter links with Manchester, London and the surrounding business centres.

**EPC RATING TBC CHESHIRE EAST
BAND E**

MACCLESFIELD OFFICE

01625 511367

macclesfield@gascoignehalman.co.uk

80 - 82 Walters Green, Macclesfield, SK11 6LH

**GASCOIGNE
HALMAN**

GROUND FLOOR
1423 sq. ft. (132.2 sq. m.) approx.

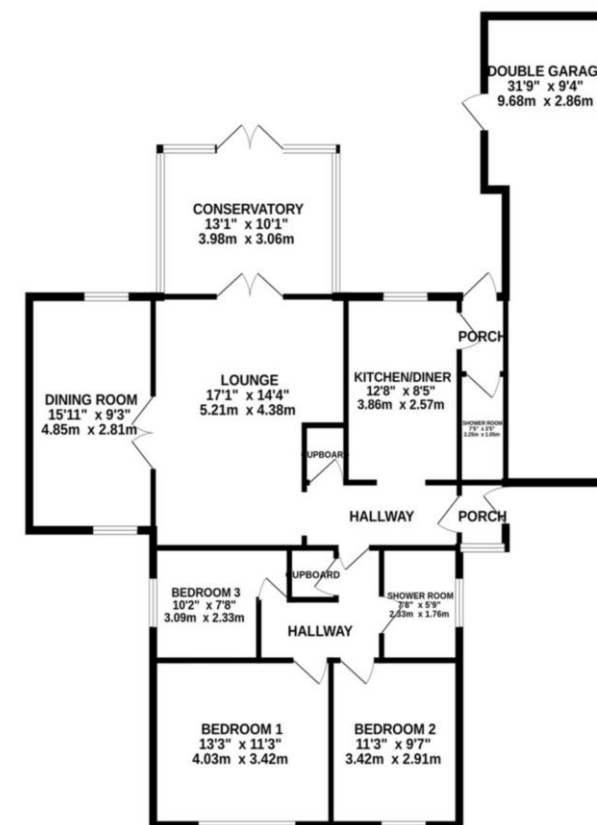

TOTAL FLOOR AREA: 1423 sq. ft. (132.2 sq. m.) approx.
Measurements are approximate. Not to scale. Illustrative purposes only.
Made with Metropix 02024

NOTICE Gascoigne Halman for themselves and for the vendors or lessors of this property whose agents they are give notice that: (i) the particulars are set out as a general outline only for the guidance of intending purchasers or lessees, and do not constitute, nor constitute part of, an offer or contract; (ii) all descriptions, dimensions, references to condition and necessary permissions for use and occupation, and other details are given in good faith and are believed to be correct but any intending purchasers or tenants should not rely on them as statements or representations of fact but must satisfy themselves by inspection or otherwise as to the correctness of each of them; (iii) no person in the employment of Gascoigne Halman has any authority to make or give any representation or warranty whatever in relation to this property.