



**GASCOIGNE
HALMAN**

GRAPES COURT, LORD STREET, MACCLESFIELD

THE AREAS LEADING ESTATE AGENT

| £99,950

A charming first floor apartment within easy reach of the town centre, with communal grounds and private parking, ideal for a first time buyer.

Situated right on the heart of the town centre this ONE bedroom apartment forms part of this lovely period building with a communal garden to the rear.

The accommodation in brief comprises of a communal entrance hall with an entry phone system, a private entrance hall, a lounge with lovely original sash windows to the rear aspect and arched windows to the side aspect, a period style fireplace and electric storage heaters.

There is an archway opening through into the kitchen which is fitted a matching range of units.

The master bedroom also has an original sash window to the rear and there is a main family bathroom fitted in a three piece suite with part tiled walls.

There is a car park outside and communal gardens.

LOCATION

Macclesfield is a thriving market town that provides a comprehensive range of shops, varied social and recreational amenities and good schools for children of all ages. For the commuter, Manchester International Airport and its connection with the North West motorway network are approximately thirty minutes away by car and the railway station in Macclesfield provides fast and frequent Intercity and commuter links with Manchester, London and the surrounding business centres.

DIRECTIONS

Travel out of Macclesfield along Sunderland Street and travel straight across the first main set of traffic lights into Park Lane. Take the second turning on the left hand side onto Lord Street, where Grapes Court will be located on the left hand side.

EPC RATING E CHESHIRE EAST BAND A

MACCLESFIELD OFFICE

01625 511367

macclesfield@gascoignehalman.co.uk

80 - 82 Waters Green, Macclesfield, SK11 6LH

**GASCOIGNE
HALMAN**

GROUND FLOOR
337 sq.ft. (31.3 sq.m.) approx.

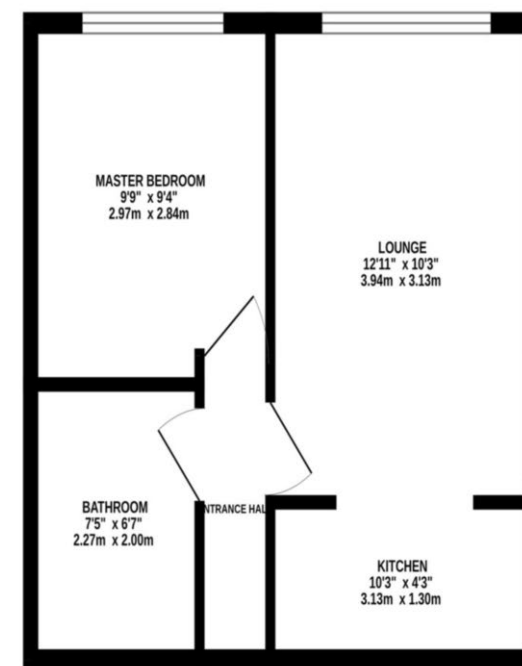

TOTAL FLOOR AREA: 337 sq.ft. (31.3 sq.m.) approx.
Measurements are approximate. Not to scale. Illustrative purposes only.
Made with Metrage CS24

NOTICE Gascoigne Halman for themselves and for the vendors or lessors of this property whose agents they are give notice that: (i) the particulars are set out as a general outline only for the guidance of intending purchasers or lessees, and do not constitute, nor constitute part of, an offer or contract; (ii) all descriptions, dimensions, references to condition and necessary permissions for use and occupation, and other details are given in good faith and are believed to be correct but any intending purchasers or tenants should not rely on them as statements or representations of fact but must satisfy themselves by inspection or otherwise as to the correctness of each of them; (iii) no person in the employment of Gascoigne Halman has any authority to make or give any representation or warranty whatever in relation to this property.