



**GASCOIGNE
HALMAN**

UNION ROAD, MACCLESFIELD

THE AREAS LEADING ESTATE AGENT

| £210,000

A beautifully refurbished two bedroom mid-terrace house enjoying a west facing private rear garden and a good size open plan dining kitchen. Great location close to the Town Centre.

The property really is beautifully presented throughout and comprises of a lounge with a window to the front aspect and having lovely plantation shutters, a large open plan dining kitchen, the kitchen area being attractively fitted in a matching range of midnight blue shaker style units with oak worksurfaces and integrated appliances to include a Bosch oven, induction hob, dishwasher and washing machine. There is also ample space for a fridge/freezer as well as a kitchen table. This room is well-lit with a window and door to the rear giving access to the rear garden and also a further velux window.

There is also ample storage under the stairs, one of the cupboards housing a tumble dryer. The property is warmed by gas fired central heating and having uPCV double glazing.

To the first floor the landing gives access to both bedrooms, the family bathroom and also the loft which is majority boarded. The master bedroom is of a good size and also has plantation shutters to the front

aspect. The second bedroom overlooks the rear garden and is also of a good size. There is a recently refitted family bathroom with a shower over the bath and part-tiled walls.

Outside, the rear garden is West facing and therefore benefitting from the afternoon sun. There is good sized seating area and a timber shed.

LOCATION

Macclesfield is a thriving market town that provides a comprehensive range of shops, varied social and recreational amenities and good schools for children of all ages. For the commuter, Manchester International Airport and its connection with the North West motorway network are approximately thirty minutes away by car and the railway station in Macclesfield provides fast and frequent Intercity and commuter links with Manchester, London and the surrounding business centres.

DIRECTIONS

Leaving Macclesfield along Buxton Road, take the fourth turning on the right into Union Road, where the property can be found situated on the right hand side.
POSTCODE : SK11 7BN

EPC RATING D CHESHIRE EAST BAND B

MACCLESFIELD OFFICE

01625 511367

macclesfield@gascoignehalman.co.uk

80 - 82 Waters Green, Macclesfield, SK11 6LH

**GASCOIGNE
HALMAN**

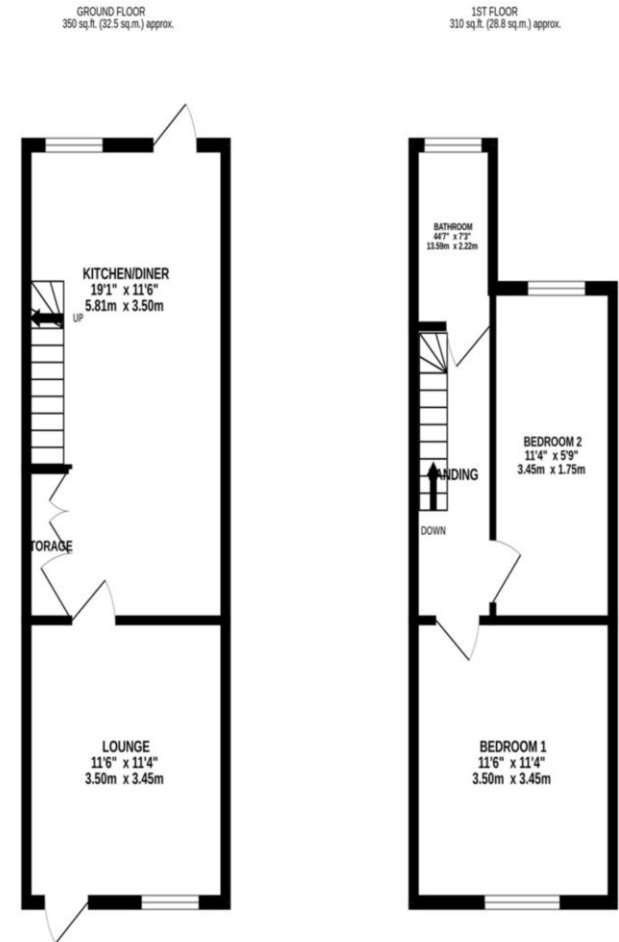

TOTAL FLOOR AREA: 659 sq ft. (61.2 sq.m.) approx.
Measurements are approximate. Not to scale. Illustrative purposes only.
Made with Metrage 12024

NOTICE Gascoigne Halman for themselves and for the vendors or lessors of this property whose agents they are give notice that: (i) the particulars are set out as a general outline only for the guidance of intending purchasers or lessees, and do not constitute, nor constitute part of, an offer or contract; (ii) all descriptions, dimensions, references to condition and necessary permissions for use and occupation, and other details are given in good faith and are believed to be correct but any intending purchasers or tenants should not rely on them as statements or representations of fact but must satisfy themselves by inspection or otherwise as to the correctness of each of them; (iii) no person in the employment of Gascoigne Halman has any authority to make or give any representation or warranty whatever in relation to this property.