

81 BOLSHAW ROAD

Heald Green

£385,000

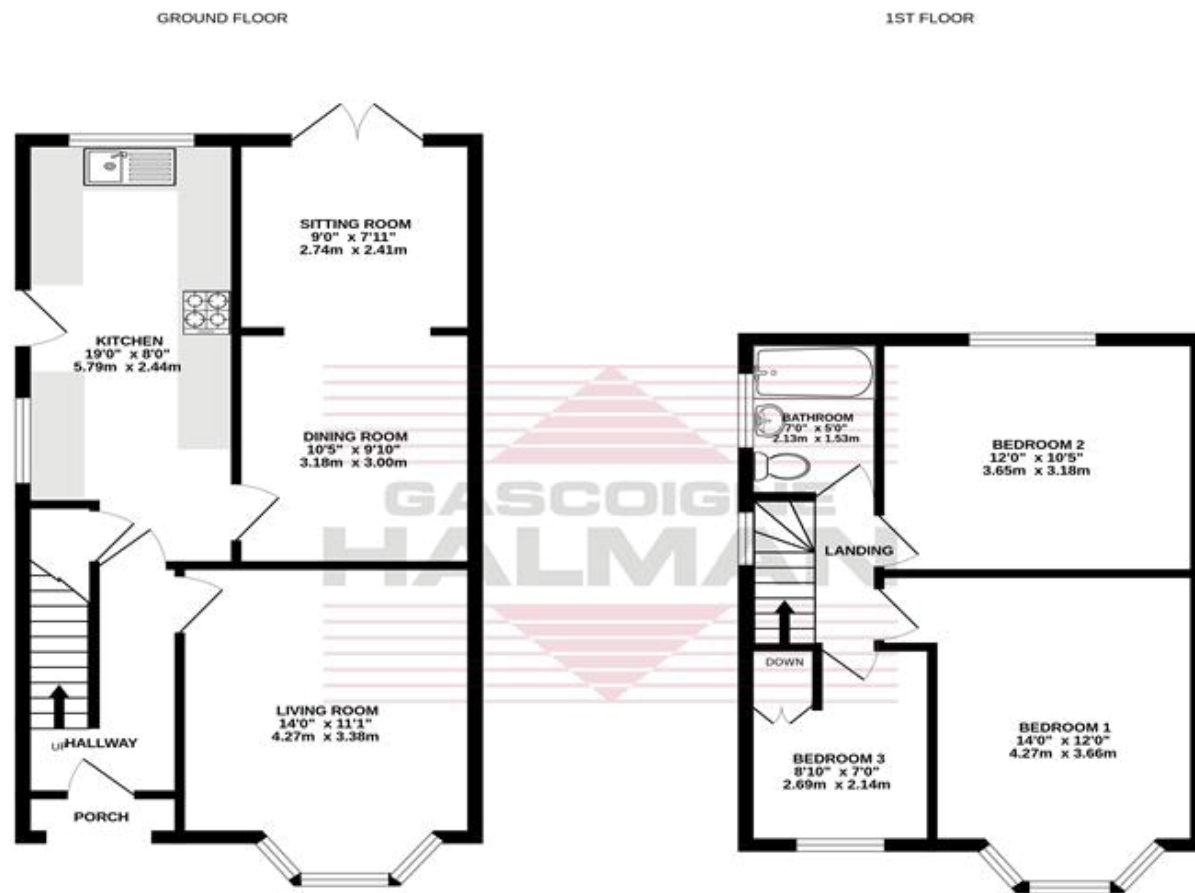

Whilst every attempt has been made to ensure the accuracy of the floorplan contained here, measurements of doors, windows, rooms and any other items are approximate and no responsibility is taken for any error, omission or mis-statement. This plan is for illustrative purposes only and should be used as such by any prospective purchaser. The services, systems and appliances shown have not been tested and no guarantee as to their operability or efficiency can be given.
Made with Metropix ©2024



NOTICE
Gascoigne Halman for themselves and for the vendors or lessors of this property whose agents they are give notice that: (i) the particulars are set out as a general outline only for the guidance of intending purchasers or lessees, and do not constitute, nor constitute part of, an offer or contract; (ii) all descriptions, dimensions, references to condition and necessary permissions for use and occupation, and other details are given in good faith and are believed to be correct but any intending purchasers or tenants should not rely on them as statements or representations of fact but must satisfy themselves by inspection or otherwise as to the correctness of each of them; (iii) no person in the employment of Gascoigne Halman has any authority to make or give any representation or warranty whatever in relation to this property.

THE AREAS LEADING ESTATE AGENCY

Cheadle

91, High Street, CHEADLE SK8 1AA

0161 428 1118 cheadle@gascoignehalman.co.uk

gascoignehalman.co.uk



GASCOIGNE HALMAN

An IMMACULATELY presented & EXTENDED three bedroom semi-detached FAMILY home situated in the popular residential location of Heald Green. The property boasts a 19ft long galley kitchen, additional reception room, well proportioned bedrooms, long block paved driveway, detached garage & lawned rear garden.

- BEAUTIFULLY PRESENTED, EXTENDED FAMILY HOUSE.
- 19 FT LONG FITTED GALLEY KITCHEN
- POPULAR & CONVENIENT RESIDENTIAL LOCATION.

- LONG DRIVEWAY & DETACHED GARAGE.
- LAWNED GARDENS TO FRONT & REAR.

£385,000

81 BOLSHAW ROAD

Heald Green



Situated in the every popular & highly convenient area of Heald Green lies this superbly presented, extended, three bedroom semi-detached home. The property falls within close proximity to local schools, shops & benefits from convenient transport links to Manchester Airport & local motorway network. In brief the property offers: a welcoming entrance hall with feature radiator & staircase with stylish glass balustrade. There is a beautifully presented bay fronted living room complete with feature fireplace and made to measure window shutters, a sociable dining room, cosy sitting room overlooking the garden & a 19ft long fitted galley kitchen.

The first floor offers three well-proportioned bedrooms & a white tiled bathroom. Other features include hi-quality fixtures & fittings throughout, a generous paved driveway, lawned gardens to both the front and rear & a useful, fully powered detached garage.

LOCATION

Heald Green offers a good selection of shops, pubs and restaurants and provides excellent educational facilities for children of all ages. Stanley Green and Handforth Dean retail parks as well as Cheadle Royal shopping centre are within easy reach as is the A34 bypass, motorway access and Manchester International Airport. Heald Green railway station provides a direct link to the Airport and Manchester City Centre.

DIRECTIONS

SK8 3PD

TENURE

SERVICES (NOT TESTED)

Services have not been tested and you are advised to make your own enquiries and/or inspections.

LOCAL AUTHORITY

Stockport MBC

VIEWING

Viewing strictly by appointment through the Agents.

TWENTY NETWORKED OFFICES THROUGHOUT CHESHIRE, SOUTH MANCHESTER & THE HIGH PEAK



gascoignealman.co.uk

GASCOIGNE HALMAN