

**GASCOIGNE  
HALMAN**

12 WOLVERTON HOUSE, GEORGE STREET, ALDERLEY  
EDGE

---

THE AREAS LEADING ESTATE AGENT

A well proportioned two bedroom apartment set in a popular modern development boasting secure under-croft parking and located at the heart of Alderley Edge Village.

Alderley Edge offers a wide range of high quality shops and restaurants, with more extensive facilities in nearby Wilmslow. Marks and Spencer, Tesco and John Lewis are a short drive away. The village has a range of social and recreational facilities, and local schools cater for children of all ages. Alderley Edge is well placed for easy access to Manchester and Stockport, the M56 is accessible at Ringway and the M6 at Holmes Chapel. Alderley Edge train station offers a fast electric commuter service with Inter City links available in Wilmslow. Manchester International Airport is only a short drive away.

#### DESCRIPTION

Situated in the popular Wolverton House development, located at the heart of Alderley Edge village, with bars and restaurants, High Street amenities and Alderley Edge train station all within walking distance. This well balanced two bedroom, boasts light and spacious accommodation that is bound to appeal to many. Situated on the top floor, with access via a lift this apartment benefits from pleasant views over the rooftops towards The Edge. Requiring a level of modernisation it offers an excellent opportunity to enhance the accommodation through cosmetic updating and improvement.

The accommodation briefly includes a communal entrance hall with a staircase and lift to all floors, private entrance hall, a large open plan lounge/dining kitchen provides the principal reception space, two double bedrooms (master with en-suite) and a bathroom.

Externally the property has the benefit of an allocated, secure under-croft parking space. There is a communal roof garden for the enjoyment of all residents.

#### DIRECTIONS

SAT NAV: SK9 7EB

#### TENURE

Leasehold. 978 years remaining. Ground rent £76 every six months.

#### SERVICE CHARGE

Service charge £144.63 per month.

#### LOCAL AUTHORITY

Cheshire East County Council

#### TAX BAND

Band: D

#### VIEWINGS

Viewing strictly by appointment through the Agents.

GROUND FLOOR  
727 sq.ft. (67.5 sq.m.) approx.

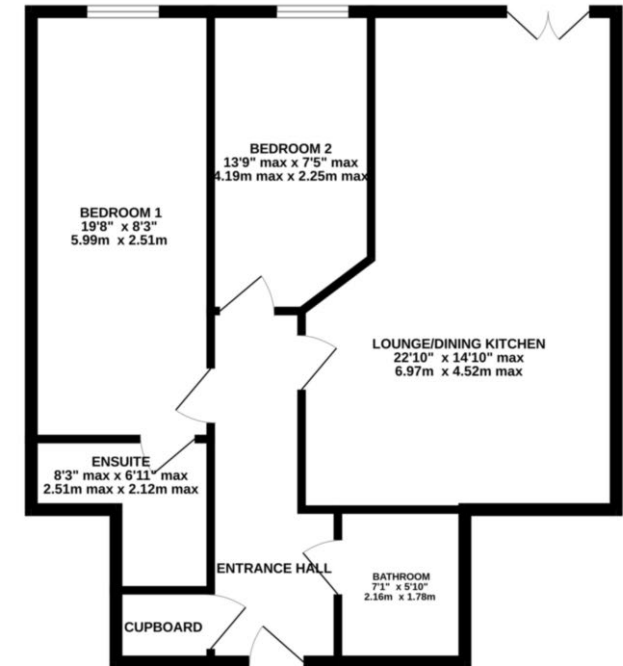

TOTAL FLOOR AREA: 727 sq.ft. (67.5 sq.m.) approx.  
Measurements are approximate. Not to scale. Illustrative purposes only.  
Made with Metropack 02/24

#### ALDERLEY EDGE OFFICE

01625 590373

alderley@gascoignehalman.co.uk

6 London Rd, Alderley Edge, Cheshire, SK9 7JS

**GASCOIGNE  
HALMAN**

NOTICE Gascoigne Halman for themselves and for the vendors or lessors of this property whose agents they are give notice that: (i) the particulars are set out as a general outline only for the guidance of intending purchasers or lessees, and do not constitute, nor constitute part of, an offer or contract; (ii) all descriptions, dimensions, references to condition and necessary permissions for use and occupation, and other details are given in good faith and are believed to be correct but any intending purchasers or tenants should not rely on them as statements or representations of fact but must satisfy themselves by inspection or otherwise as to the correctness of each of them; (iii) no person in the employment of Gascoigne Halman has any authority to make or give any representation or warranty whatever in relation to this property.