



**GASCOIGNE  
HALMAN**

9 OAKFIELD, DAVEY LANE, ALDERLEY EDGE

---

THE AREAS LEADING ESTATE AGENT

**\*\*NO ONWARD CHAIN\*\* A beautifully presented two bedroom, two bathroom, penthouse apartment offering excellent easily managed accommodation and southerly views towards the Edge with the added advantage of allocated parking and a single garage.**

Alderley Edge offers a wide range of high quality shops and restaurants, with more extensive facilities in nearby Wilmslow. Marks & Spencer, Tesco and John Lewis are a short drive away. The village has a range of social and recreational facilities, and local schools cater for children of all ages. Alderley Edge is well placed for easy access to Manchester and Stockport, the M56 is accessible at Ringway and the M6 at Holmes Chapel. Alderley Edge station offers a fast electric commuter service with Inter City links available in Wilmslow. Manchester International Airport is only a short drive away.

#### DESCRIPTION

Situated in a gated complex this purpose built two bedroom two bathroom Penthouse Apartment is situated only a short walk from Alderley Edge village centre and offers excellent accommodation that has been maintained to a high standard throughout and briefly includes : Communal entrance hall, stairs or lift to third floor, private entrance hall, large lounge with picture window and views towards the Edge, breakfast

kitchen with granite work surfaces, master bedroom with en-suite shower room, second bedroom and bathroom. The property is further enhance by double glazing and gas fired central heating and has the added advantage of an allocated parking space and garage with up and over door. There are also communal gardens which are maintained which are maintained by the management company.

#### DIRECTIONS

SAT NAV: SK9 7NZ

#### TENURE

Leasehold. 125 years (110 years remaining). Ground rent £350.00 p.a.

#### SERVICE CHARGE

£2,240 p.a

#### TAX BAND

Band: E

#### VIEWINGS

Viewing strictly by appointment through the Agents.

#### LOCAL AUTHORITY

Cheshire East County Council

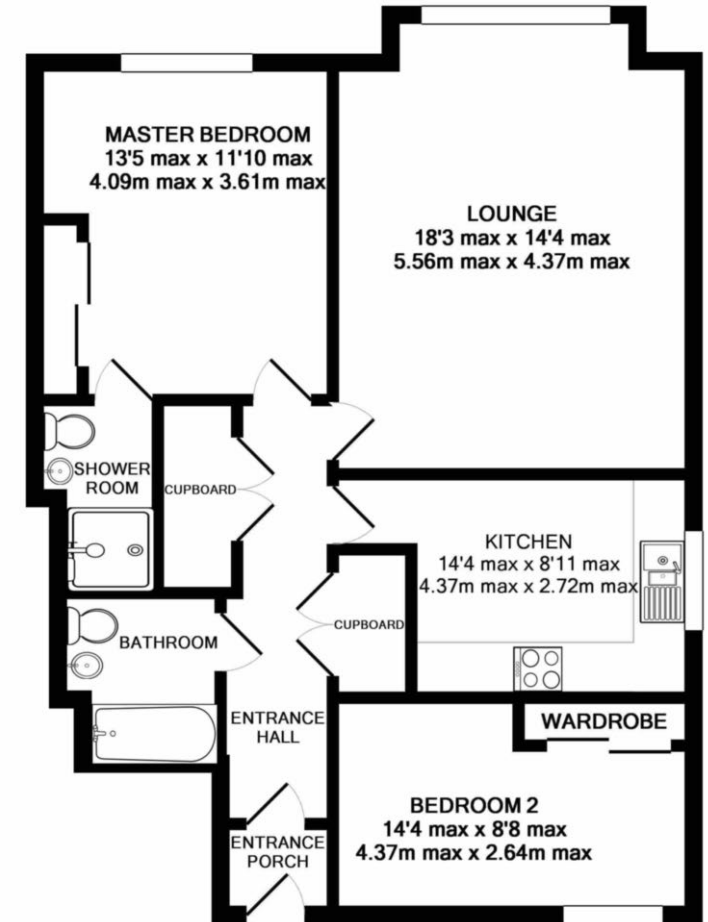

TOTAL APPROX. FLOOR AREA 850 SQ.FT. (78.9 SQ.M.)  
Measurements are approximate. Not to scale. Illustrative purposes only  
Made with Metropix ©2019

#### ALDERLEY EDGE OFFICE

01625 590 373

alderley@gascoignehalman.co.uk

6 London Rd, Alderley Edge, Cheshire, SK9 7JS

**GASCOIGNE  
HALMAN**

NOTICE Gascoigne Halman for themselves and for the vendors or lessors of this property whose agents they are give notice that: (i) the particulars are set out as a general outline only for the guidance of intending purchasers or lessees, and do not constitute, nor constitute part of, an offer or contract; (ii) all descriptions, dimensions, references to condition and necessary permissions for use and occupation, and other details are given in good faith and are believed to be correct but any intending purchasers or tenants should not rely on them as statements or representations of fact but must satisfy themselves by inspection or otherwise as to the correctness of each of them; (iii) no person in the employment of Gascoigne Halman has any authority to make or give any representation or warranty whatever in relation to this property.