



Property Description

Wright & Wright are pleased to offer for sale this well position modern end town house with larger than average plot. uPVC double glazing and gas central heating. Entrance hall, lounge, breakfast kitchen. Two bedrooms, bathroom. Gardens to front, side and rear. Off road parking to rear. Viewing recommended.



Entrance Hall

having ceiling light point, double panelled radiator, central heating thermostat, staircase to first floor.

Lounge 4.67m x 3.16m (15' 4" x 10' 4")

having uPVC double glazed window to front, ceiling light point, double panelled radiator, television aerial point, built in cupboard.

Breakfast Kitchen 4.06m x 2.44m (13' 4" x 8')

having uPVC double glazed window to rear aspect, ceiling light point, double panelled radiator, Baxi boiler installed around 2021, range of matching wall and base units with work surfaces over, plumbing for automatic washing machine, built in oven with gas hob and cooker hood. Part glazed door to rear garden.

First Floor Landing

having uPVC double glazed window to side aspect, ceiling light point, loft access and built in cupboard.

Bedroom One 3.54m x 3.19m (11' 7" x 10' 6")

having uPVC double glazed window to front aspect, ceiling light point, double panelled radiator, range of bedroom furniture and double wardrobe.

Bedroom Two

having uPVC double glazed window to rear aspect, ceiling light point, double panelled radiator and built in double wardrobe.

Bathroom 1.90m x 1.73m (6' 3" x 5' 8")

having uPVC double glazed window to side aspect, ceiling light point, double panelled radiator, three piece suite comprising low level flush wc, wash hand basin and side panelled bath with electric shower over.

Outside

having small front garden. Private enclosed rear garden with car parking for two cars, low maintenance theme to rear and side aspects.

GROUND FLOOR
320 sq.ft. (29.7 sq.m.) approx.

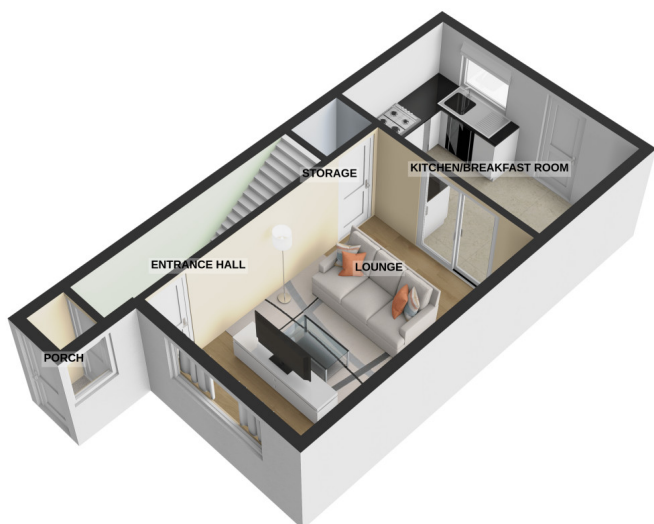

1ST FLOOR
311 sq.ft. (28.9 sq.m.) approx.

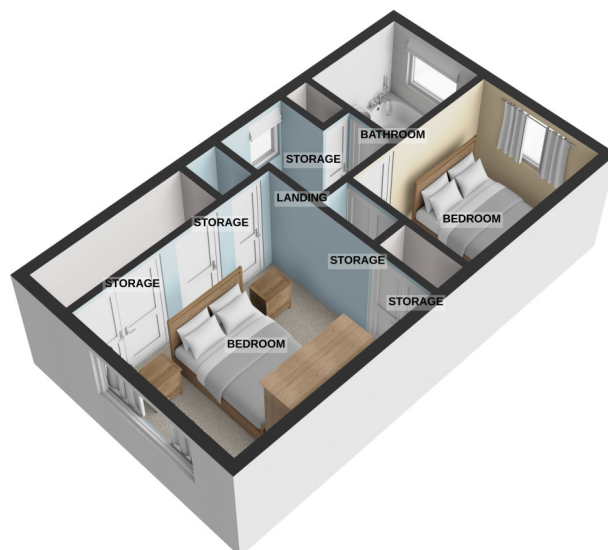

TOTAL FLOOR AREA : 631 sq.ft. (58.6 sq.m.) approx.

For illustrative purposes only. Decorative finishes, fixtures, fittings and furnishings do not represent the current state of the property. Measurements are approximate. Not to scale.
Made with Metropix © 2025

