

Property Description

Two bedroom ground floor town centre maisonette. uPVC double glazing, gas central heating. Spacious living area which comprises a lounging zone, dining zone and kitchen area with fully fitted kitchen. Inner hall, two bedrooms, and bathroom. Allocated off road parking, communal areas. No chain, viewing recommended.



Lounge/Kitchen 17' 10" x 12' 5" (5.43m x 3.78m)

Having, uPVC double glazing, front facing window, eight spot lights, single panel radiator, storage cupboard, eye and base unites, work surfaces, a sink with mixer and single drainer, integrated washing machine, built in cooker and a gas hob with hood over head.

Inner Hall

Having, a ceiling light point and doors off to...

Bedroom One 13' 4" x 7' 8" (4.06m x 2.34m)

Having uPVC double glazing, three ceiling spot lights, single panel radiator and a television point.

Bedroom Two 11' 4" x 6' 2" (3.45m x 1.88m)

Having uPVC double glazing, rear facing window, two ceiling spot lights, and a single panel radiator.

Family Bathroom 6' 0" x 6' 0" (1.83m x 1.83m)

Having two ceiling spot lights, heated towel rail, low level W/C, wash basin and bath.

Notes to Purchaser

This property is a leasehold property. The lease is 125 years from 01/07/2006. Ground Rent is ?200 payable annually in advance. Lease details are correct to our knowledge but MUST be confirmed by your solicitor.

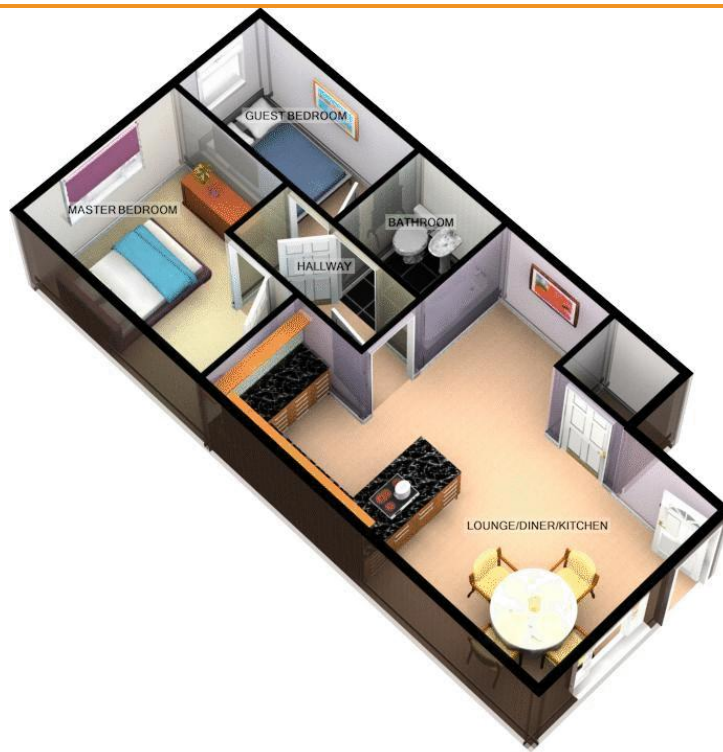

TOTAL APPROX. FLOOR AREA 559 SQ.FT. (52.0 SQ.M.)

For illustrative purposes only. Decorative finishes, fixtures, fittings and furnishings do not represent the current state of the property. Measurements are approximate. Not to scale
Made with Metropix ©2018

