



24 Milton Crescent, Brixham, TQ5 0BD  
Bungalow - Semi Detached  
£1,100 Per Calendar Month

**boyce**brixham  
email [lettings@ljboyce.co.uk](mailto:lettings@ljboyce.co.uk) call 01803 856112



A well presented 2 bedroomed semi-detached located in a popular residential area. The accommodation briefly comprises lounge/dining room, kitchen and 2 bedrooms with patio doors leading out to the lawned rear garden. There are 2 double bedrooms and a modern shower room. The property benefits from a distant sea view, gas central heating, UPVC double glazing, garage and parking for 2 to 3 vehicles.

In order to qualify for a tenancy, the total annual income between tenants is a minimum of 30 times the monthly rent. A holding deposit of one week's rent secures the property whilst we process referencing. This is used towards your first months rent when tenancy starts. Should you fail referencing or break the contract, payment is withheld. The deposit for the tenancy is 5 weeks rent. The rent and deposit must be cleared in our account before the tenancy starts.



- 2 Bedroom Semi Detached Bungalow
- Modern Shower Room
- Under House Storage & Distant Sea View
- Holding Deposit - £253.00
- Garage & Driveway Parking
- Gas Central Heating & UPVC Double Glazing
- Council Tax Band C
- Deposit - £1,269.00



Council Tax Band: C



**boycebrixham**  
email [lettings@ljboyce.co.uk](mailto:lettings@ljboyce.co.uk) call 01803 856112







GROUND FLOOR  
558 sq.ft. (51.8 sq.m.) approx.

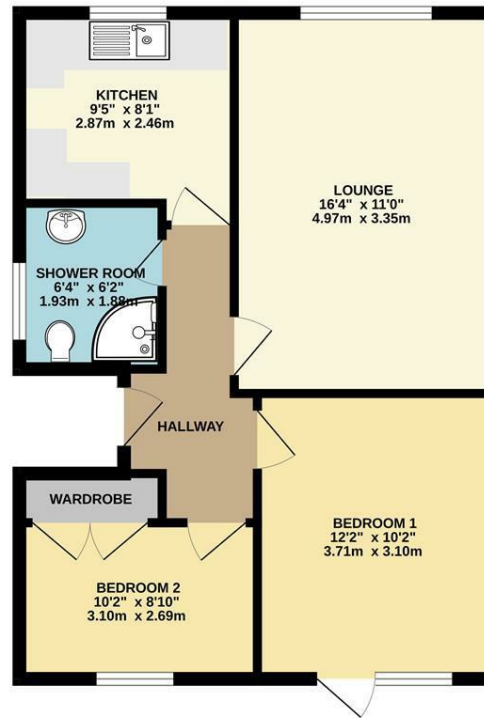

TOTAL FLOOR AREA : 558 sq.ft. (51.8 sq.m.) approx.

Whilst every attempt has been made to ensure the accuracy of the floorplan contained herein, measurements of doors, windows, rooms and any other items are approximate and no responsibility is taken for any error, omission or mis-statement. This plan is for illustrative purposes only and should be used as such by any prospective purchaser. The services, systems and appliances shown have not been tested and no guarantee as to their operability or efficiency can be given.  
Made with Metropix ©2025

Current EPC Rating: D

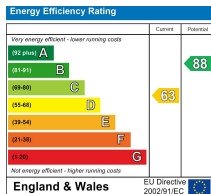

Find us on



Please note floorplans are to be used as a guide only. The Agent has not tested any apparatus, equipment, fixtures and fittings or services and so cannot verify that they are in working order or fit for purpose. A buyer is advised to obtain verification from their solicitor or surveyor. References to the tenure of the property are based on information supplied by the seller. The agent has not had sight of the title documents. A buyer is advised to obtain verification from their solicitor. You are advised to check the availability of this property before travelling distance to view.

**boycebrixham**

email [lettings@ljboyce.co.uk](mailto:lettings@ljboyce.co.uk) call 01803 856112